

OIL CONSERVATION DIVISION

P. O. BOX 2088

SANTA FE, NEW MEXICO 87501

WELL COMPLETION OR RECOMPLETION REPORT AND LOG

NO. OF COPIES RECEIVED	
DISTRIBUTION	
SANTA FE	
FILE	
U.S.G.S.	
LAND OFFICE	
OPERATOR	

1. TYPE OF WELL

OIL WELL ☐ GAS WELL ☐ DRY ☒ OTHER \_\_\_\_\_

2. TYPE OF COMPLETION

NEW WELL ☒ WORK OVER ☐ DEEPEN ☐ PLUG BACK ☐ DIFF. RESVR. ☐ OTHER \_\_\_\_\_

3. Name of Operator

Enserch Exploration, Inc.

4. Address of Operator

P. O. Box 4815, Midland, Texas 79704

5. Location of Well

6. NE 1/4 E LOCATED 1880 FEET FROM THE North LINE AND 560 FEET FROM

7. West LINE OF SEC. 32 TWP. 5S RGE. 33E NMPM

8. Date Spudded

1/30/81

9. Date T.D. Reached

3/3/81

10. Date Compl. (Ready to Prod.)

11. Elevations (DF, RKB, RT, GR, etc.)

4384.5' GR

12. Elev. Casinghead

4385.5'

13. Total Depth

8000'

14. Plug Back T.D.

7940'

15. If Multiple Compl., How Many

N/A

16. Intervals Drilled By

Rotary Tools

17. Cable Tools

All

18. Producing Interval(s), of this completion - Top, Bottom, Name

19. Was Directional Survey Made

No

20. Type Electric and Other Logs Run

CDL/CNS, DLL, CBL

21. Was Well Cored

No

CASING RECORD (Report all strings set in well)

CASING SIZE	WEIGHT LB./FT.	DEPTH SET	HOLE SIZE	CEMENTING RECORD	AMOUNT PULLED
13-3/8"	48#	358'	17-1/2"	450 sacks, Circulated	--
9-5/8"	36#	1986'	12-1/4"	1020 sacks, Circulated	--
5-1/2"	15.5# & 17#	7991'	8-3/4"	350 sacks	3710'

LINER RECORD

30. TUBING RECORD

SIZE	TOP	BOTTOM	SACKS CEMENT	SCREEN	SIZE	DEPTH SET	PACKER SET

22. Perforation Record (Interval, size and number)

7848'-51', 8 holes, size .42" (squeezed)  
7710'-14', 10 holes, size .42" (squeezed)  
7902'-30', 56 holes, size .42"

32. ACID, SHOT, FRACTURE, CEMENT SQUEEZE, ETC.

DEPTH INTERVAL	AMOUNT AND KIND MATERIAL USED
7848'-51'	1500 gals. 15% NENCL Acid
7710'-14'	150 gals. 15% MCA, 1500 gals. MOD 202
7902'-30'	10,000 gals. MOD 202

PRODUCTION

23. Date First Production		24. Production Method (Flowing, gas lift, pumping - Size and type pump)				25. Well Status (Prod. or Shut-in)	
26. Date of Test	27. Hours Tested	28. Choke Size	29. Prod'n. For Test Period	30. Oil - Bbl.	31. Gas - MCF	32. Water - Bbl.	33. Gas - Oil Ratio
34. Flow Tubing Press.	35. Casing Pressure	36. Calculated 24-Hour Rate	37. Oil - Bbl.	38. Gas - MCF	39. Water - Bbl.	40. Oil Gravity - API (Corr.)	
41. Disposition of Gas (Sold, used for fuel, vented, etc.)						42. Test Witnessed By	

43. List of Attachments

Deviation Record, Logs & Plat

I hereby certify that the information shown on both sides of this form is true and complete to the best of my knowledge and belief.

SIGNED [Signature]

TITLE Production Supervisor

DATE 4/5/83

## INSTRUCTIONS

This form is to be filed with the appropriate District Office of the Division not later than 20 days after the completion of any newly-drilled or deepened well. It shall be accompanied by one copy of all electrical and radio-activity logs run on the well and a summary of all special tests conducted, including drill stem tests. All depths reported shall be measured depths. In the case of directionally drilled wells, true vertical depths shall also be reported. For multiple completions, Items 30 through 34 shall be reported for each zone. The form is to be filed in quintuplicate except on state land, where six copies are required. See Rule 1105.

## INDICATE FORMATION TOPS IN CONFORMANCE WITH GEOGRAPHICAL SECTION OF STATE

## Southeastern New Mexico

T. Anhy \_\_\_\_\_  
 T. Salt \_\_\_\_\_  
 B. Salt \_\_\_\_\_ 2059'  
 T. Yates \_\_\_\_\_  
 T. 7 Rivers \_\_\_\_\_  
 T. Queen \_\_\_\_\_  
 T. Grayburg \_\_\_\_\_ 3105'  
 T. San Andres \_\_\_\_\_  
 T. Glorieta \_\_\_\_\_  
 T. Paddock \_\_\_\_\_  
 T. Blinbry \_\_\_\_\_ 5757'  
 T. Tubb \_\_\_\_\_  
 T. Drinkard \_\_\_\_\_  
 T. Abo \_\_\_\_\_ 6515'  
 T. Wolfcamp \_\_\_\_\_ 7105'  
 T. Penn. \_\_\_\_\_  
 T. Cisco (Bough C) \_\_\_\_\_ 7708'

## Northwestern New Mexico

T. Ojo Alamo \_\_\_\_\_  
 T. Kirtland-Fruitland \_\_\_\_\_  
 T. Pictured Cliffs \_\_\_\_\_  
 T. Cliff House \_\_\_\_\_  
 T. Menefee \_\_\_\_\_  
 T. Point Lookout \_\_\_\_\_  
 T. Mancos \_\_\_\_\_  
 T. Gallup \_\_\_\_\_  
 Base Greenhorn \_\_\_\_\_  
 T. Dakota \_\_\_\_\_  
 T. Morrison \_\_\_\_\_  
 T. Todilto \_\_\_\_\_  
 T. Entrada \_\_\_\_\_  
 T. Wingate \_\_\_\_\_  
 T. Chinle \_\_\_\_\_  
 T. Permian \_\_\_\_\_  
 T. Penn. "A" \_\_\_\_\_

## OIL OR GAS SANDS OR ZONES

No. 1, from \_\_\_\_\_ to \_\_\_\_\_  
 No. 2, from \_\_\_\_\_ to \_\_\_\_\_  
 No. 3, from \_\_\_\_\_ to \_\_\_\_\_  
 No. 4, from \_\_\_\_\_ to \_\_\_\_\_  
 No. 5, from \_\_\_\_\_ to \_\_\_\_\_  
 No. 6, from \_\_\_\_\_ to \_\_\_\_\_

## IMPORTANT WATER SANDS

Include data on rate of water inflow and elevation to which water rose in hole.

No. 1, from \_\_\_\_\_ to \_\_\_\_\_ feet.  
 No. 2, from \_\_\_\_\_ to \_\_\_\_\_ feet.  
 No. 3, from \_\_\_\_\_ to \_\_\_\_\_ feet.  
 No. 4, from \_\_\_\_\_ to \_\_\_\_\_ feet.

## FORMATION RECORD (Attach additional sheets if necessary)

From	To	Thickness in Feet	Formation	From	To	Thickness in Feet	Formation
3105'	4434'	1329'	Dolomite & Anhydrite				
4434'	5757'	1323'	Dolomite, Shale, Thin Sandstones				
5757'	6515'	758'	Shale, Sandstone, Siltstones				
6515'	7105'	590'	Red & Green Shales				
7105'	7464'	359'	Dolomite, Limestone & Shale				
7464'	7708'	244'	Limestone & Shale				
7708'	7832'	124'	Limestone, Dark Shale & Chert				
7832'	7901'	69'	Limestone & Dolomite				
7901'	8000'	99'	Dolomite				
(T.D.)							

APR 6 1983  
 O.C.D.  
 MOORE OFFICE

NEW MEXICO OIL CONSERVATION COMMISSION  
WELL LOCATION AND ACREAGE DEDICATION PLAT

Form C-102  
Supersedes C-128  
Effective 1-1-65

All distances must be from the outer boundaries of the Section

Operator <b>Enserch Exploration, Inc.,</b>			Lease <b>Rader</b>		Well No. <b>2</b>
Unit Letter <b>E</b>	Section <b>32</b>	Township <b>5 South</b>	Range <b>33 East</b>	County <b>Roosevelt</b>	
Actual Footage Location of Well: <b>1880</b> feet from the <b>North</b> line and <b>560</b> feet from the <b>West</b> line					
Ground Level Elev. <b>4384.5</b>	Producing Formation <b>Fusselman</b>		Pool <b>South Peterson</b>	Dedicated Acreage: <b>50</b> Acres	

1. Outline the acreage dedicated to the subject well by colored pencil or hachure marks on the plat below.
2. If more than one lease is dedicated to the well, outline each and identify the ownership thereof (both as to working interest and royalty).
3. If more than one lease of different ownership is dedicated to the well, have the interests of all owners been consolidated by communitization, unitization, force-pooling, etc?

☐ Yes ☐ No If answer is "yes," type of consolidation \_\_\_\_\_

If answer is "no," list the owners and tract descriptions which have actually been consolidated. (Use reverse side of this form if necessary.) \_\_\_\_\_

No allowable will be assigned to the well until all interests have been consolidated (by communitization, unitization, forced-pooling, or otherwise) or until a non-standard unit, eliminating such interests, has been approved by the Commission.

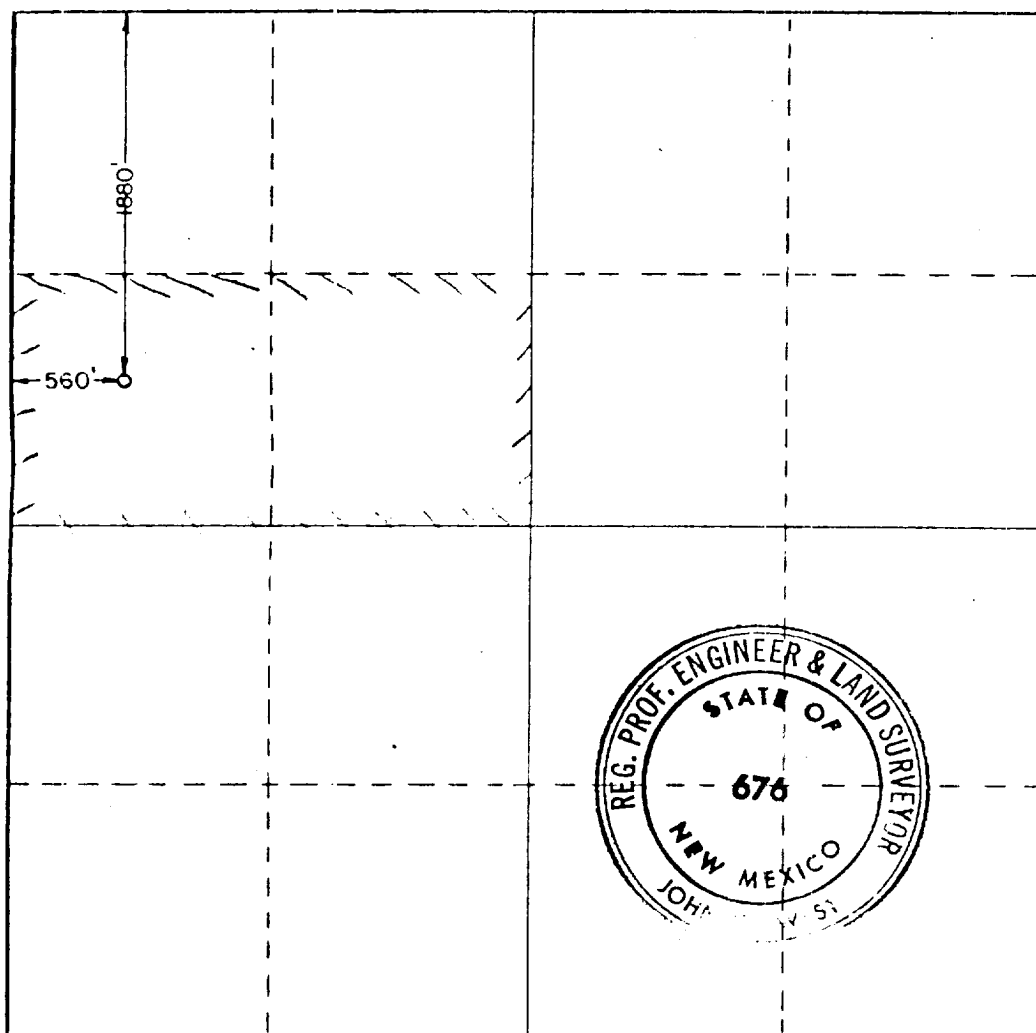

CERTIFICATION

I hereby certify that the information contained herein is true and complete to the best of my knowledge and belief.

*C. H. Peebles*

Name

C. H. Peebles

Position

Regional Drilling Manager

Company

Enserch Exploration, Inc.

Date

May 9, 1980

I hereby certify that the well location shown on this plat was plotted from field notes of actual surveys made by me or under my supervision, and that the same is true and correct to the best of my knowledge and belief.

Date Surveyed

April 25, 1980

Registered Professional Engineer and/or Land Surveyor

*John W. West*

Certificate No. **JOHN W. WEST 676**  
**PATRICK A. ROMERO 6663**  
**Ronald J. Eidson 3239**

0 330 660 990 1320 1650 1980 2310 2640 2970 3300 3630 3960 4290 4620 4950 5280 5610 5940 6270 6600

RECEIVED

APR 8 1983

C.C.D.  
HOBBS OFFICE

RECEIVED  
MAR 11 1981  
WEST DRILLING

STATE OF NEW MEXICO

Deviation Report

Operator: Enserch Exploration Inc.  
Contractor: Republic Drilling & Service Inc.  
Well: Rader #2  
County: Roosevelt  
State : New Mexico

Deviation	Depth
1°	362
$\frac{1}{2}$ °	824
$\frac{3}{4}$ °	2000±
1°	3631
1°	5179
$\frac{1}{4}$ °	5672
1°	6941
1°	7150
$\frac{3}{4}$ °	7767

State of Wyoming  
County of Natrona

The foregoing instrument was acknowledged before me this 9th day of March, 1981.

My Commission Expires May 22, 1984

Rosselin LaPlant  
Notary Public

REPUBLIC DRILLING & SERVICE, INC.

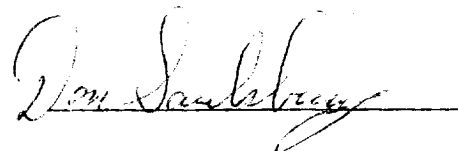

RECEIVED

APR 8 1983

O.C.D.  
HOLLAND