

30-041-20556

Form C-101  
Revised 1-1-65

## NEW MEXICO OIL CONSERVATION COMMISSION

NO. OF COPIES RECEIVED		
DISTRIBUTION		
SANTA FE		
FILE		
U.S.G.S.		
LAND OFFICE		
OPERATOR		

5A. Indicate Type of Lease	
STATE <input type="checkbox"/>	FEE <input checked="" type="checkbox"/>
5. State Oil & Gas Lease No.	

## APPLICATION FOR PERMIT TO DRILL, DEEPEN, OR PLUG BACK

1a. Type of Work		DRILL <input checked="" type="checkbox"/> DEEPEN <input type="checkbox"/> PLUG BACK <input type="checkbox"/>	
b. Type of Well		OIL WELL <input checked="" type="checkbox"/> GAS WELL <input type="checkbox"/> OTHER <input type="checkbox"/>	
2. Name of Operator		Enserch Exploration, Inc.	
3. Address of Operator		1230 River Bend Drive - Suite 136, Dallas, Texas 75247	
4. Location of Well		UNIT LETTER <u>A</u> LOCATED <u>660</u> FEET FROM THE <u>North</u> LINE	
AND <u>660</u> FEET FROM THE <u>East</u> LINE OF SEC. <u>6</u> TWP. <u>5S</u> RGE. <u>33E</u> NMPM		7. Unit Agreement Name	
		8. Farm or Lease Name	
		Finley	
		9. Well No.	
		1	
		10. Field and Pool, or Wildcat	
		Wildcat	
		12. County	
		Roosevelt	
19. Proposed Depth		19A. Formation	
8500'		Pre-Cambrian Granite	
20. Rotary or C.T.		Rotary	
21. Elevations (Show whether DI, RT, etc.)		21B. Drilling Contractor	
4501.4		Republic Drilling Co.	
21A. Kind & Status Plug. Bond		22. Approx. Date Work will start	
American Insurance		November 24, 1980	
5171534			

23.

## PROPOSED CASING AND CEMENT PROGRAM

SIZE OF HOLE	SIZE OF CASING	WEIGHT PER FOOT	SETTING DEPTH	SACKS OF CEMENT	EST. TOP
17-1/2"	13-3/8"	40#	350'	400	Surface
12-1/4"	9-5/8"	36#	2000'	1150	Surface
8-3/4"	5-1/2"	15.5#	8500'	800	6000'

Drill to 8500' in search of oil. Will set 13-3/8" surface pipe. A 13-3/8" 3000# bradenhead and 12" 3000# BOP will be installed before drilling the intermediate hole. After 9-5/8" casing is set, a 9-5/8" 5000# bradenhead will be installed. A 12" 5000# double hydraulic BOP and a 12" 3000# Hydril will be installed on 9-5/8" bradenhead. A 3000# choke manifold will be used from 2000' to total depth.

Purchaser for oil and/or gas has not been designated.

APPROVAL VALID  
FOR 90 DAYS UNLESS  
DRILLING COMMENCED,

EXPIRES 2/7/81

IN ABOVE SPACE DESCRIBE PROPOSED PROGRAM: IF PROPOSAL IS TO DEEPEN OR PLUG BACK, GIVE DATA ON PRESENT PRODUCTIVE ZONE AND PROPOSED NEW PRODUCTIVE ZONE. GIVE BLOWOUT PREVENTER PROGRAM, IF ANY.

I hereby certify that the information above is true and complete to the best of my knowledge and belief.

Signed C. H. Peoples Title Regional Drilling Manager Date November 3, 1980

(This space for State Use)

APPROVED BY

CONDITIONS OF APPROVAL, IF ANY:

SUPERVISOR DISTRICT

DATE

**MEXICO OIL CONSERVATION COMMISSION**  
**WELL LOCATION AND ACREAGE DEDICATION PLAT**

Form C-102  
 Supersedes C-128  
 Effective 1-1-65

All distances must be from the outer boundaries of the Section.

Operator <b>Enserch Exploration Inc.</b>			Lease <b>Finley</b>		Well No. <b>1</b>
Unit Letter <b>A</b>	Section <b>6</b>	Township <b>5 South</b>	Range <b>33 East</b>	County <b>Roosevelt</b>	
Actual Footage Location of Well: <b>660</b> feet from the <b>north</b> line and <b>660</b> feet from the <b>east</b> line					
Ground Level Elev. <b>4501.4</b>	Producing Formation <b>Precambrian Granite</b>		Pool <b>Wildcat</b>		Dedicated Acreage: <b>40</b> Acres

1. Outline the acreage dedicated to the subject well by colored pencil or hachure marks on the plat below.
2. If more than one lease is dedicated to the well, outline each and identify the ownership thereof (both as to working interest and royalty).
3. If more than one lease of different ownership is dedicated to the well, have the interests of all owners been consolidated by communitization, unitization, force-pooling, etc?

☐ Yes ☐ No If answer is "yes," type of consolidation \_\_\_\_\_

If answer is "no," list the owners and tract descriptions which have actually been consolidated. (Use reverse side of this form if necessary.) \_\_\_\_\_

No allowable will be assigned to the well until all interests have been consolidated (by communitization, unitization, forced-pooling, or otherwise) or until a non-standard unit, eliminating such interests, has been approved by the Commission.

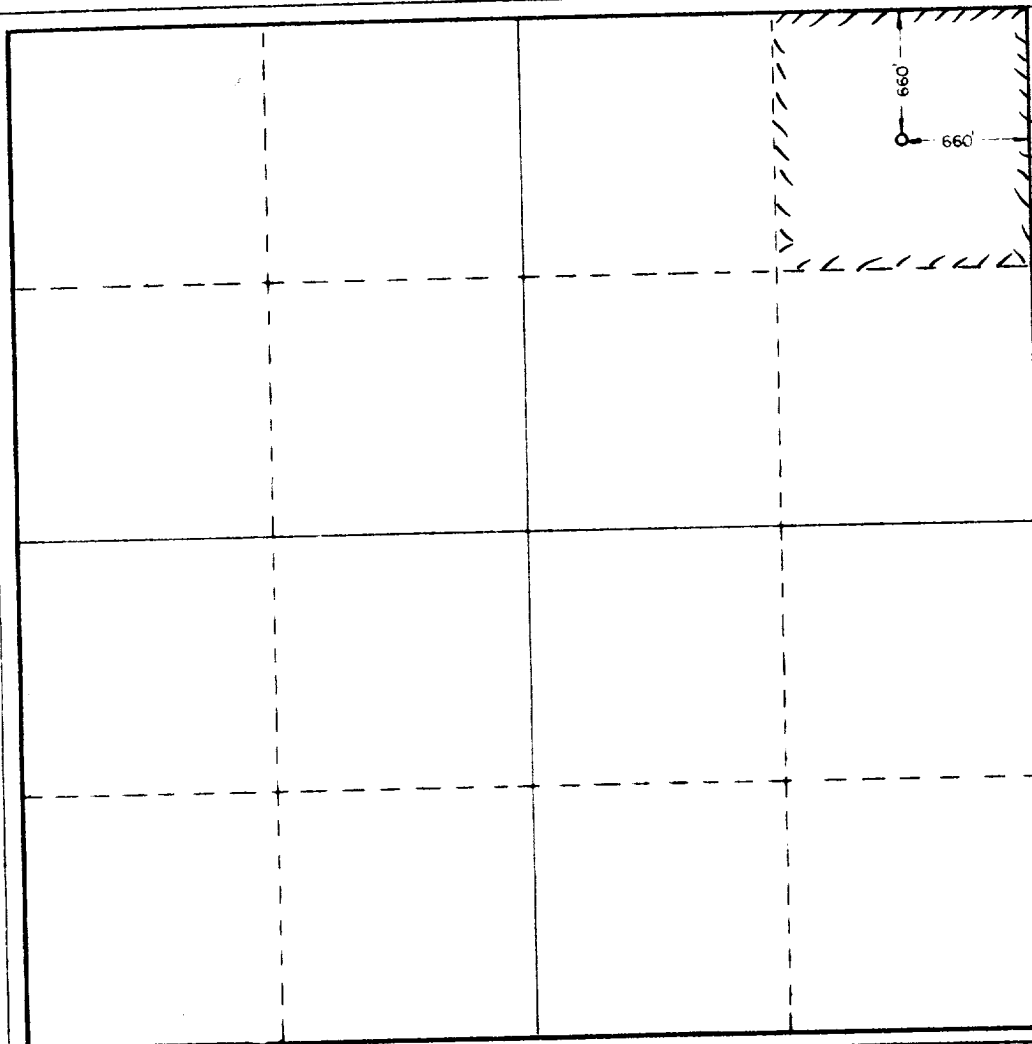

**CERTIFICATION**

I hereby certify that the information contained herein is true and complete to the best of my knowledge and belief.

Name Bruce Lawrence  
 Position Drilling Engineer  
 Company Enserch Exploration, Inc.  
 Date November 3, 1980

I hereby certify that the location shown on this plat was plotted from field notes of actual surveys made by me or under my supervision and that the same is true and correct to the best of my knowledge and belief.

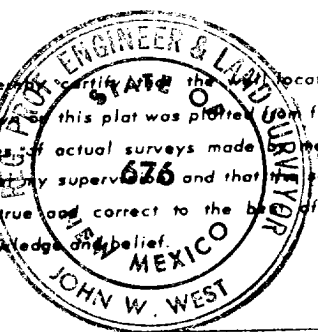

Date Surveyed Oct. 25, 1980  
 Registered Professional Engineer and/or Land Surveyor

Certificate No. JOHN W. WEST 676  
PATRICK A. ROMERO 6863  
Ronald J. Eidson 3239

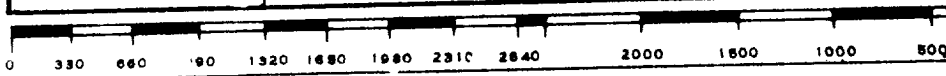

RECEIVED

NOV 6 1980

NOV 6 1980

173