

NO. OF COPIES RECEIVED		
DISTRIBUTION		
SANTA FE		
FILE		
U.S.G.S.		
LAND OFFICE		
OPERATOR		

NEW MEXICO OIL CONSERVATION COMMISSION

30-041-20571

Form C-101
Revised 1-1-75

5A. Indicate Type of Location	STATE <input checked="" type="checkbox"/>	FILE <input type="checkbox"/>
5. State Oil & Gas Lease No.		

APPLICATION FOR PERMIT TO DRILL, DEEPEN, OR PLUG BACK

1a. Type of Work		7. Well A Deepened Name	
b. Type of Well OIL WELL <input checked="" type="checkbox"/> GAS WELL <input type="checkbox"/> OTHER <input type="checkbox"/>		8. Name of Lessee	
DRILL <input checked="" type="checkbox"/> DEEPEN <input type="checkbox"/> PLUG BACK <input type="checkbox"/>		Radcliff	
SINGLE ZONE <input type="checkbox"/> MULTIPLE ZONE <input type="checkbox"/>		9. Well No.	
2. Name of Operator		10. Name of Driller	
Enserch Exploration, Inc.		Peterson, North	
3. Address of Operator		11. County	
1230 River Bend Drive - Suite 136 - Dallas, Texas 75247		Roosevelt	
4. Location of Well UNIT LETTER <u>L</u> LOCATED <u>1980</u> FEET FROM THE <u>South</u> LINE		12. Proposed Depth	
AND <u>660'</u> FEET FROM THE <u>West</u> LINE OF SEC. <u>32</u> TWP. <u>4S</u> RGE. <u>33E</u> NMPM		8500'	
		13A. Formation	
		Precambrian Gr.	
		13B. Drilling Contractor	
		Republic	
14. Core Analysis (show weather DR, KI, etc.)		21. Approx. Date Work will start	
4390 GR.		March 1, 1981	
15. Bond & Surety Firm, Bond No.			
American Insurance 5171534			

PROPOSED CASING AND CEMENT PROGRAM

SIZE OF HOLE	SIZE OF CASING	WEIGHT PER FOOT	SETTING DEPTH	SACKS OF CEMENT	EST. TOP
17-1/2"	13-3/8"	48#	350'	400	Surface
12-1/4"	9-5/8"	36#	2000'	1150	Surface
8-3/4"	5-1/2"	15.5#	8500'	850	6000'

Drill to 8500' in search of oil. Will set 13-3/8" surface pipe. A 13-3/8" 3000# bradenhead and 12" 3000# BOP will be installed before drilling the intermediate hole. After 9-5/8" casing is set, a 9-5/8" 5000# bradenhead will be installed. A 12" 3000# double hydraulic BOP and a 12" 3000# Hydril will be installed on 9-5/8" bradenhead. A 3000# choke manifold will be used from 2000' to total depth.

APPROVAL VALID
FOR 90 DAYS UNLESS
DRILLING COMMENCED,

EXPIRES 4/12/81

IN ABOVE SPACE DESCRIBE PROPOSED PROGRAM; IF PROPOSAL IS TO DEEPEN OR PLUG BACK, GIVE DATA ON PRESENT PRODUCTIVE ZONE AND PROPOSED NEW PRODUCTIVE ZONE. GIVE BLOWOUT PREVENTER PROGRAM, IF ANY.

I hereby certify that the information above is true and complete to the best of my knowledge and belief.

Signed C. H. Peoples Title Regional Drilling Manager Date January 6, 1981

(This space for State Use)

APPROVED BY [Signature] TITLE SUPERVISOR DISTRICT DATE JAN 12 1981

CONDITIONS OF APPROVAL, IF ANY:

**NEW MEXICO OIL CONSERVATION COMMISSION
WELL LOCATION AND ACREAGE DEDICATION PLAT**

Form C-102
Supersedes C-128
Effective 1-1-65

All distances must be from the outer boundaries of the Section

Operator Enserch Exploration, Inc.		Lease Radcliff		Well No. 1
Unit Letter L	Section 32	Township 4 South	Range 33 East	County Roosevelt

Actual Footage Location of Well:

1980 feet from the **South** line and **660** feet from the **West** line

Ground Level Elev 4432.4	Producing Formation Precambrian Granite	Pool Undesignated	Dedicated Acreage: 40 Acres
------------------------------------	---	-----------------------------	---------------------------------------

1. Outline the acreage dedicated to the subject well by colored pencil or hatchure marks on the plat below.
2. If more than one lease is dedicated to the well, outline each and identify the ownership thereof (both as to working interest and royalty).
3. If more than one lease of different ownership is dedicated to the well, have the interests of all owners been consolidated by communitization, unitization, force-pooling, etc?

☐ Yes ☐ No If answer is "yes," type of consolidation _____

If answer is "no," list the owners and tract descriptions which have actually been consolidated. (Use reverse side of this form if necessary.) _____

No allowable will be assigned to the well until all interests have been consolidated (by communitization, unitization, forced-pooling, or otherwise) or until a non-standard unit, eliminating such interests, has been approved by the Commission.

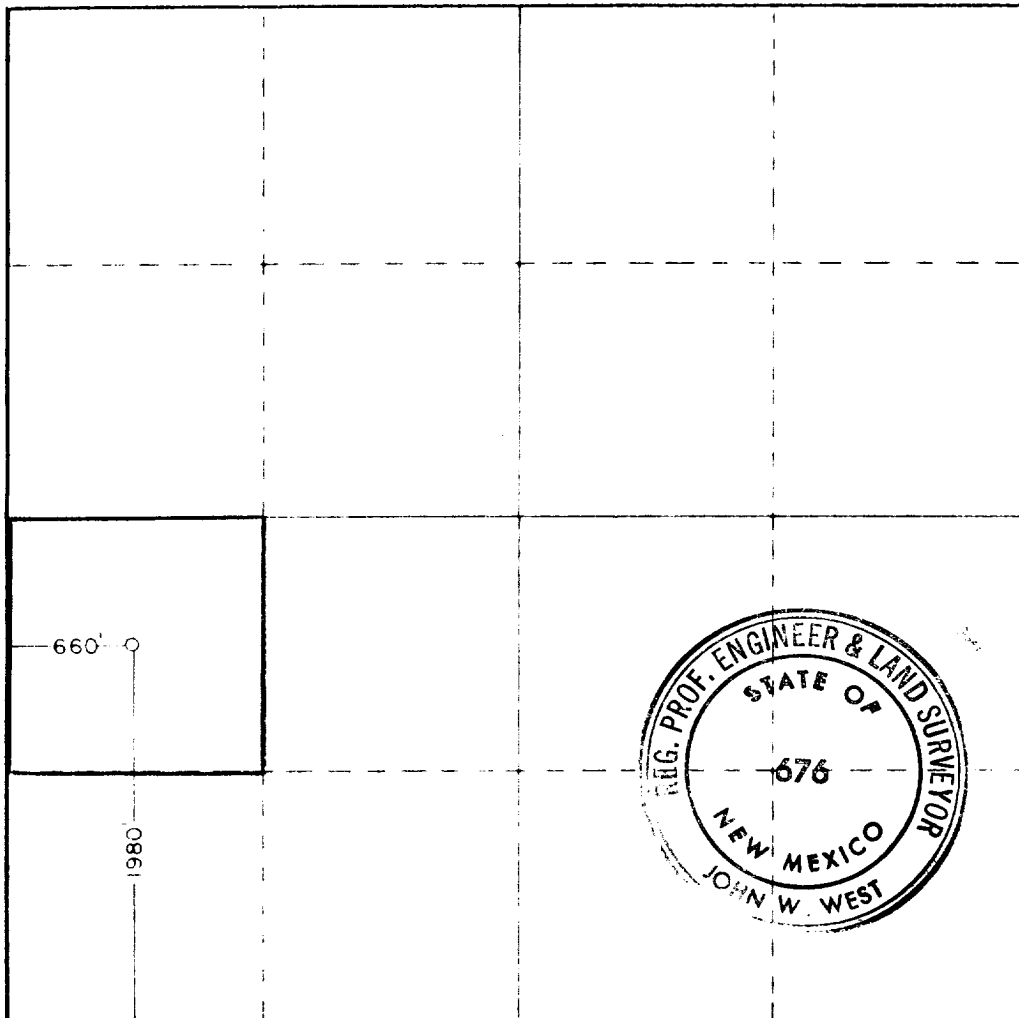

CERTIFICATION

I hereby certify that the information contained herein is true and complete to the best of my knowledge and belief.

C. H. Peeples

Name
C. H. Peeples
Position
Regional Drilling Manager
Company
Enserch Exploration, Inc.

Date
January 6, 1981

I hereby certify that the well location shown on this plat was plotted from field notes of actual surveys made by me or under my supervision and that the same is true and correct to the best of my knowledge and belief.

Date Surveyed
12-30-80

Registered Professional Engineer and/or Land Surveyor

John W. West

Certificate No. **JOHN W. WEST 676**
PATRICK A. ROMERO 6663
Ronald J. Eidson 3239

0 330 660 990 1320 1650 1980 2310 2640 2970 3300 3630 3960 4290 4620 4950 5280 5610 5940 6270 6600

RECEIVED

JAN 9 1981

OIL CONSERVATION DIV

FILE