

STATE OF NEW MEXICO
ENERGY AND MINERALS DEPARTMENT

OIL CONSERVATION DIVISION

P. O. BOX 2085
SANTA FE, NEW MEXICO 87501

30-041-20573

Form C-101
Revised 10-1-78

NO. OF COPIES RECEIVED	
DISTRIBUTION	
SANTA FE	
FILL	
U.S.G.S.	
LAND OFFICE	
OPERATOR	

5A. Indicate Type of Lease
STATE ☐ FEE ☒
5. State Oil & Gas Lease No.

APPLICATION FOR PERMIT TO DRILL, DEEPEN, OR PLUG BACK

a. Type of Work
b. Type of Well
DRILL ☒ DEEPEN ☐ PLUG BACK ☐
OIL WELL ☐ GAS WELL ☐ OTHER ☐ SINGLE ZONE ☐ MULTIPLE ZONE ☐

7. Unit Agreement Name

8. Farm or Lease Name
J. McClellan

9. Well No.
1

10. Field and Pool, or Wildcat (Granite Wash)
Undesignated (772)

11. County
Roosevelt

c. Name of Operator
Sun Oil Company
d. Address of Operator
P.O. Box 30 Dallas, Texas 75221
e. Location of Well
UNIT LETTER B LOCATED 1980 FEET FROM THE South LINE
AND 1980 FEET FROM THE West LINE OF SEC. 15 TWP. 6-S RGE. 33-E NEARBY

12. County
Roosevelt

19. Proposed Depth
8,700
19A. Formation
Granite Wash
20. Rotary or C.F.
Rotary

21A. Kind & Status Plug. Bond
Blanket-Approval
21B. Drilling Contractor
Norton Drilling Co

22. Approx. Date Work will start
6-1-81

PROPOSED CASING AND CEMENT PROGRAM

SIZE OF HOLE	SIZE OF CASING	WEIGHT PER FOOT	SETTING DEPTH	SACKS OF CEMENT	EST. TOP
17-1/2"	13-3/8"	48#/Ft.	375'	400	Surface
11"	8-5/8"	24#/Ft.	2100'	1300	Surface
7-7/8"	5-1/2"	15.5#/Ft.	8700'	1000	2000'

---Casing testing procedure and description of BOP equipment is attached
---No dwelling within one mile of location
---Gas is not dedicated.

APPROVAL VALID FOR DAYS
PERMIT EXPIRES 7/27/81
UNLESS DRILLING UNDERWAY

ABOVE SPACE DESCRIBE PROPOSED PROGRAM: IF PROPOSAL IS TO DEEPEN OR PLUG BACK, GIVE DATA ON PRESENT PRODUCTIVE ZONE AND PROPOSED NEW PRODUCTIVE ZONE. GIVE BLOWOUT PREVENTER PROGRAM, IF ANY.

I hereby certify that the information above is true and complete to the best of my knowledge and belief.

Signed Don Impley Title Consultant Date 1-8-81
(This space for State Use)

APPROVED BY [Signature] TITLE SUPERVISOR DATE [Signature]
CONDITIONS OF APPROVAL, IF ANY:

ATTACHMENT TO FORM C-101
NEW MEXICO OIL CONSERVATION COMMISSISON
SUN OIL COMPANY (DELAWARE)
J. McCLELLAN NO. 1

BOP EQUIPMENT AND CASING TESTING

SURFACE CASING: 13 3/8" O.D.

- BOP: One 12", 3,000 psig Hydrill preventor, or equivalent.
- TESTING: 1. Before drilling shoe, pressure casing to 1,000 psig for thirty minutes with rig pump - 50 psig pressure drop acceptable.
2. After drilling shoe and five feet of new hole, pressure test to 50 psig for 30 minutes with rig pump.

INTERMEDIATE CASING: 8 5/8" O.D.

- BOP: One 10", 3,000 psig Type "LWS" Double Shaffer.
One 10", 3,000 psig Hydrill GK.
- TESTING: 1. Before drilling float, pressure casing with rig pump to 2,000 psig for thirty mintues - 50 psig pressure drop acceptable.
2. After drilling shoe and five feet of new hole, pressure test to the equivalent of 10#/gallon mud at casing shoe for thirty minutes with rig pump.

**NEW MEXICO OIL CONSERVATION COMMISSION
WELL LOCATION AND ACREAGE DEDICATION PLAT**

Form C-102
Supersedes C-128
Effective 1-1-65

AMENDED

All distances must be from the outer boundaries of the Section

Operator Sun Oil Co. Sunmark Exploration Co.		Lease McClellan		Well No. 1	
Unit Letter K	Section 15	Township 6South	Range 33East	County Roosevelt	
Actual Portage Location of Well: <div style="display: flex; justify-content: space-between;"> 1980 feet from the South line and 1980 feet from the West line </div>					
Ground Level Elev. 4405.0'	Producing Formation Granite Wash		Pool Undesignated (Granite Wash)		Dedicated Acreage: 320 Acres

1. Outline the acreage dedicated to the subject well by colored pencil or hachure marks on the plat below.
2. If more than one lease is dedicated to the well, outline each and identify the ownership thereof (both as to working interest and royalty).
3. If more than one lease of different ownership is dedicated to the well, have the interests of all owners been consolidated by communitization, unitization, force-pooling, etc?

☐ Yes ☐ No If answer is "yes," type of consolidation _____

If answer is "no," list the owners and tract descriptions which have actually been consolidated. (Use reverse side of this form if necessary.) _____

No allowable will be assigned to the well until all interests have been consolidated (by communitization, unitization, forced-pooling, or otherwise) or until a non-standard unit, eliminating such interests, has been approved by the Commission.

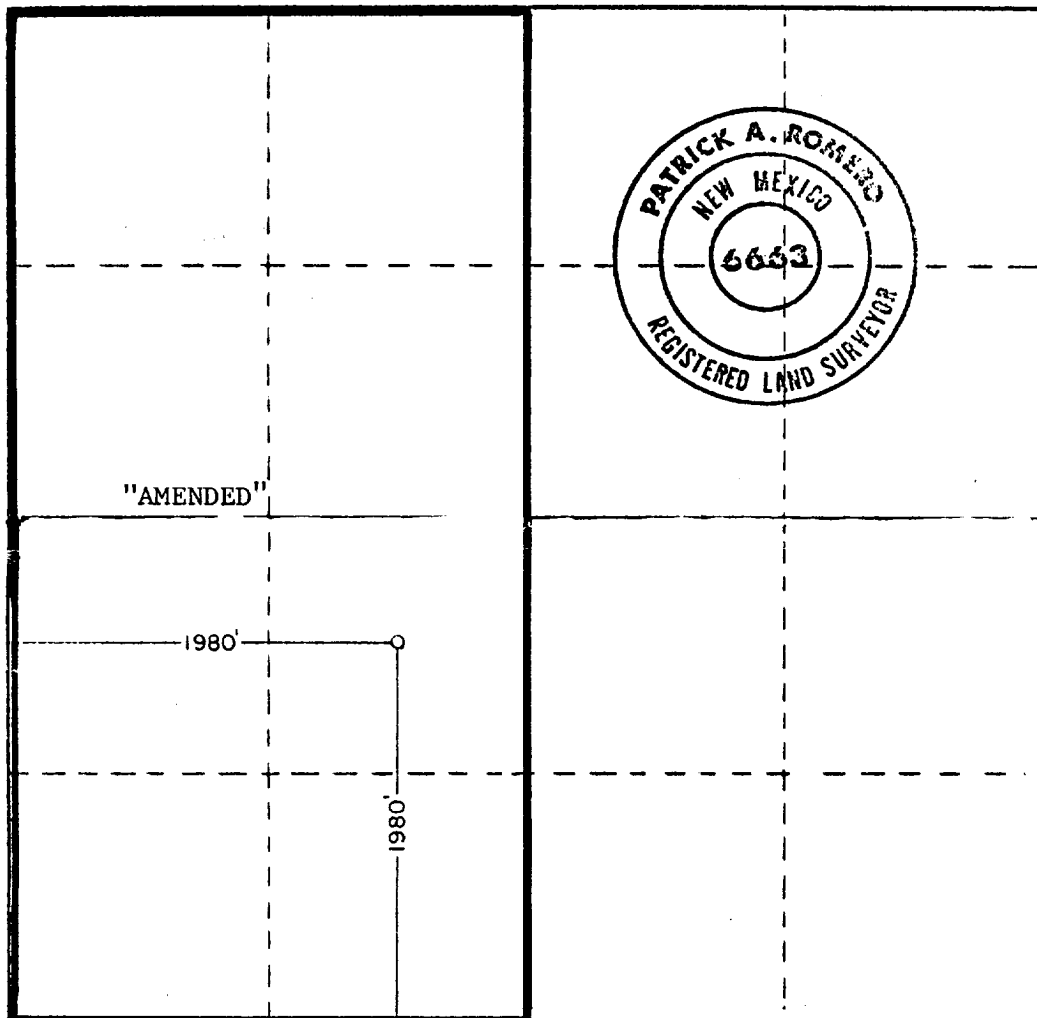

CERTIFICATION

I hereby certify that the information contained herein is true and complete to the best of my knowledge and belief.

Ron Tarpley

Name

Ron Tarpley

Position

Operations Manager

Company

O'Briant Engineering

Date

January 14, 1981

I hereby certify that the well location shown on this plat was plotted from field notes of actual surveys made by me or under my supervision, and that the same is true and correct to the best of my knowledge and belief.

Date Surveyed

Jan. 10, 1981

Registered Professional Engineer and/or Land Surveyor

Patrick A. Romero

Certificate No. **JOHN W. WEST 676**
PATRICK A. ROMERO 6663
Ronald J. Eidson 3239

0 330 660 990 1320 1650 1980 2310 2640 2970 3300 3630 3960 4290 4620 4950 5280 5610 5940 6270 6600

**MEXICO OIL CONSERVATION COMMISSION
WELL LOCATION AND ACREAGE DEDICATION PLAT**

Form C-102
Supersedes C-128
Effective 1-1-65

All distances must be from the outer boundaries of the Section

Operator <i>Summark Exploration Co.</i>		Lease McClellan		Well No. 1	
Unit Letter K	Section 15	Township 6South	Range 33East	County Roosevelt	
Actual Footage Location of Well: <div style="display: flex; justify-content: space-between;"> 1980 feet from the South line and 1980 feet from the West line </div>					
Ground Level Elev. 4405.0'	Producing Formation Granite Wash	Pool Undesignated (Granite Wash)	Dedicated Acreage: 320 Acres		

1. Outline the acreage dedicated to the subject well by colored pencil or hatchure marks on the plat below.
2. If more than one lease is dedicated to the well, outline each and identify the ownership thereof (both as to working interest and royalty).
3. If more than one lease of different ownership is dedicated to the well, have the interests of all owners been consolidated by communitization, unitization, force-pooling, etc?

☐ Yes ☐ No If answer is "yes," type of consolidation _____

If answer is "no," list the owners and tract descriptions which have actually been consolidated. (Use reverse side of this form if necessary.) _____

No allowable will be assigned to the well until all interests have been consolidated (by communitization, unitization, forced-pooling, or otherwise) or until a non-standard unit, eliminating such interests, has been approved by the Commission.

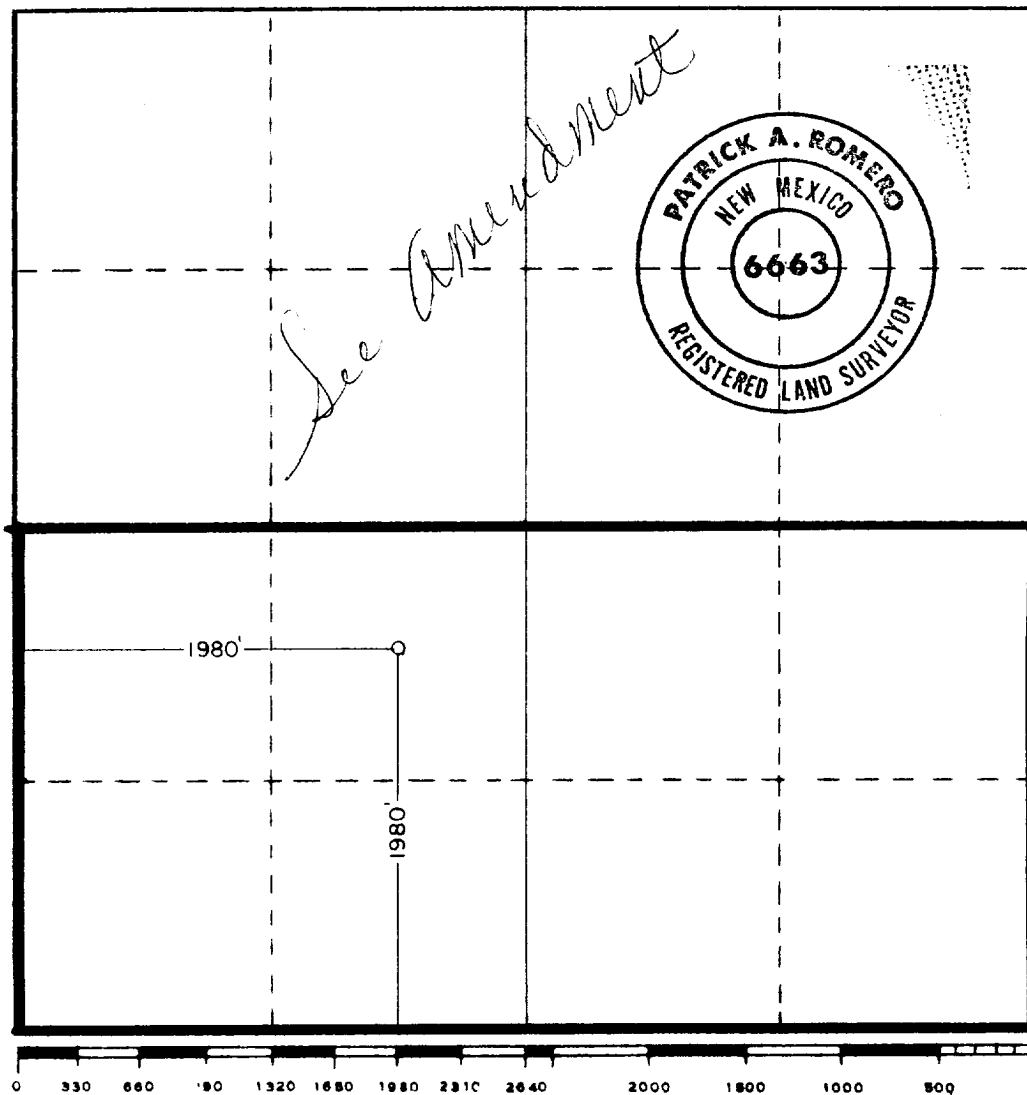

CERTIFICATION

I hereby certify that the information contained herein is true and complete to the best of my knowledge and belief.

Ron Tarpley
Name

Position

Operations Manager

Company

O'Briant Engineering

Date

January 14, 1981

I hereby certify that the well location shown on this plat was plotted from field notes of actual surveys made by me or under my supervision, and that the same is true and correct to the best of my knowledge and belief.

Date Surveyed

Jan. 10, 1981

Registered Professional Engineer and/or Land Surveyor

Patrick A. Romero

Certificate No. **JOHN W. WEST 676**
PATRICK A. ROMERO 6663
Ronald J. Eidson 3239

RECEIVED
JAN 20 1981
OIL CONSERVATION DIV.

473
By [signature] 1/13/81