

NO. OF COPIES RECEIVED	
DISTRIBUTION	
SANTA FE	
FILE	
U.S.G.S.	
LAND OFFICE	
OPERATOR	

NEW MEXICO OIL CONSERVATION COMMISSION

30-041-405 17

Form C-101
Revised 1-1-65

5A. Indicate Type of Lease	
STATE <input checked="" type="checkbox"/>	FEE <input type="checkbox"/>
5. State Oil & Gas Lease No.	

APPLICATION FOR PERMIT TO DRILL, DEEPEN, OR PLUG BACK

1a. Type of Work		7. Unit Agreement Name	
b. Type of Well DRILL <input checked="" type="checkbox"/> DEEPEN <input type="checkbox"/> PLUG BACK <input type="checkbox"/> OIL WELL <input checked="" type="checkbox"/> GAS WELL <input type="checkbox"/> OTHER <input type="checkbox"/> SINGLE ZONE <input checked="" type="checkbox"/> MULTIPLE ZONE <input type="checkbox"/>		8. Farm or Lease Name Miller	
2. Name of Operator Energy Reserves Group, Inc.		9. Well No. 1	
3. Address of Operator P. O. Drawer 2437, Midland, Texas 79702		10. Field and Pool, or Wildcat Wildcat	
4. Location of Well UNIT LETTER M LOCATED 660 FEET FROM THE South LINE AND 660 FEET FROM THE West LINE OF SEC. 12 TWP. 6-S RGE. 33-E NMPM		11. County Roosevelt	
18. Proposed Depth 8200		19A. Formation Granite Wash	20. Rotary or C.T. Rotary
21. Elevations (Show whether DF, RT, etc.) 4375 GL	21A. Kind & Status Plug. Bond Blanket	21B. Drilling Contractor MGF Drilg. Corp.	22. Approx. Date Work will start 02-06-81

23.

PROPOSED CASING AND CEMENT PROGRAM

SIZE OF HOLE	SIZE OF CASING	WEIGHT PER FOOT	SETTING DEPTH	SACKS OF CEMENT	EST. TOP
17 1/2"	13 3/8"	48	300	300	Circ.
11 "	8 5/8"	32	3300	3300	Circ.
7 7/8"	4 1/2"	11.6 & 10.5#	8	700	5600

Blowout Prevention Program: Shaffer 10" series 1500 Type LWS
Hydril 10" series 1500 Type GK
K-80 Hydril Accumulator
Five (5) station control manifold

APPROVAL VALID FOR 180 DAYS
PERMIT EXPIRES 2/29/81
UNLESS DRILLING UNDERWAY

IN ABOVE SPACE DESCRIBE PROPOSED PROGRAM: IF PROPOSAL IS TO DEEPEN OR PLUG BACK, GIVE DATA ON PRESENT PRODUCTIVE ZONE AND PROPOSED NEW PRODUCTIVE ZONE. GIVE BLOWOUT PREVENTER PROGRAM, IF ANY.

I hereby certify that the information above is true and complete to the best of my knowledge and belief.

Signed RL Robertson R. L. Robertson Title Production Engineer II Date 01-27-81

(This space for State Use)

APPROVED BY [Signature] TITLE SUPERVISOR DISTRICT I DATE FEB 5 1981
CONDITIONS OF APPROVAL, IF ANY:

**MEXICO OIL CONSERVATION COMMISSION
WELL LOCATION AND ACREAGE DEDICATION PLAT**

Form C-102
Supersedes C-138
Effective 1-1-85

Distances must be from the outer boundaries of the Section.

Operator Energy Reserves Group Inc.			Lease Miller		Well No. 1
Unit Letter H	Section 12	Township 6 South	Range 33 East	County Roosevelt	
Actual Postage Location of Well: 660 feet from the south line and 660 feet from the west line					
Ground Level Elev. 4375.0	Producing Formation Granite Wash		Pool UNDESIGNATED	Dedicated Acreage: 40 Acres	

1. Outline the acreage dedicated to the subject well by colored pencil or hachure marks on the plat below.
2. If more than one lease is dedicated to the well, outline each and identify the ownership thereof (both as to working interest and royalty).
3. If more than one lease of different ownership is dedicated to the well, have the interests of all owners been consolidated by communitization, unitization, force-pooling, etc?

☐ Yes ☐ No If answer is "yes," type of consolidation _____

If answer is "no," list the owners and tract descriptions which have actually been consolidated. (Use reverse side of this form if necessary.) _____

No allowable will be assigned to the well until all interests have been consolidated (by communitization, unitization, forced-pooling, or otherwise) or until a non-standard unit, eliminating such interests, has been approved by the Commission.

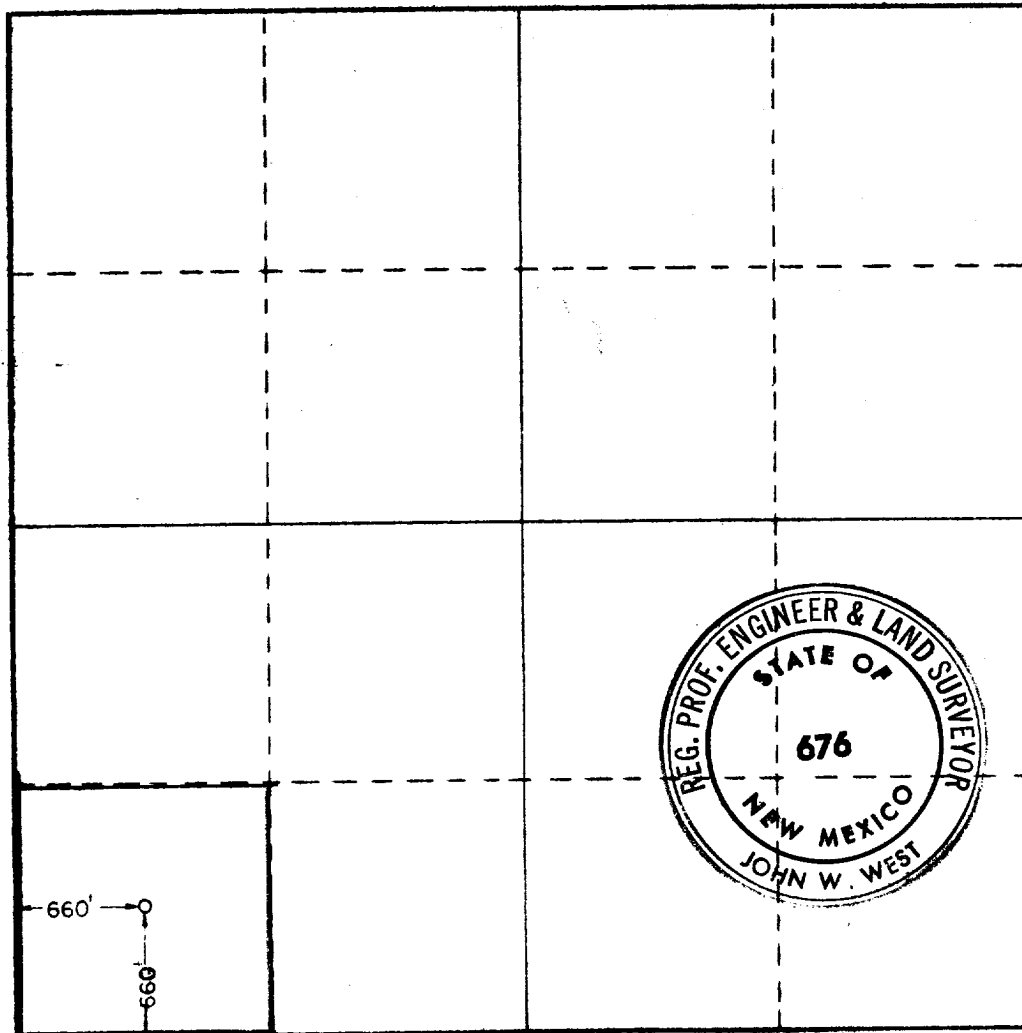

CERTIFICATION

I hereby certify that the information contained herein is true and complete to the best of my knowledge and belief.

R. L. Robertson
Name

R. L. Robertson

Position

Production Engineer II

Company

Energy Reserves Group, Inc.

Date

01-27-81

I hereby certify that the well location shown on this plat was plotted from field notes of actual surveys made by me or under my supervision, and that the same is true and correct to the best of my knowledge and belief.

Date Surveyed

1-23-81

Registered Professional Engineer and/or Land Surveyor

John W. West

Certificate No. **JOHN W. WEST 676**
PATRICK A. ROMERO 6663
Randy J. Brown 3259

0 440 660 880 1100 1320 1540 1760 1980 2200 2420 2640 2860 3080 3300 3520 3740 3960 4180 4400 4620 4840 5060 5280 5500 5720 5940 6160 6380 6600

RECEIVED

JAN 28 1931

OIL CONSERVATION DIV.

173