

STATE OF NEW MEXICO

Deviation Report

Operator: Enserch Exploration, Inc.  
Contractor: Republic Drilling & Service, Inc.  
Well: Collier A-1  
County: Roosevelt  
State : New Mexico

Deviation	Depth
3/4°	1445
3/4°	1603
1°	2642
1°	3355
1°	3905
1°	4750
1°	5522
1°	5813
1½°	6934
½°	7895

State of Wyoming  
County of Natrona

The foregoing instrument was acknowledged before me this 8th day of May, 1981.

Witness my hand and official seal.

Roscelin LaPlant  
Roscelin LaPlant

**My Commission Expires May 22, 1984**

REPUBLIC DRILLING & SERVICE, INC.

Don Sanbrey

NEW MEXICO OIL CONSERVATION COMMISSION  
WELL LOCATION AND ACREAGE DEDICATION AT

Form C-102  
Supersedes C-128  
Effective 1-1-65

All distances must be from the outer boundaries of the Section

Operator <b>Enserch Exploration, Inc.</b>		Lease <b>Collier "A"</b>		Well No. <b>1</b>
Unit Letter <b>L</b>	Section <b>28</b>	Township <b>4 South</b>	Range <b>33 East</b>	County <b>Roosevelt</b>
Actual Footage Location of Well: <b>1980</b> feet from the <b>South</b> line and <b>660</b> feet from the <b>West</b> line				
Ground Level Elev. <b>4337.4</b>	Producing Formation <b>Fusselman</b>	Pool <b>Precambrian Granite</b>	Dedicated Acreage: <b>40</b> Acres	

- Outline the acreage dedicated to the subject well by colored pencil or hachure marks on the plat below.
- If more than one lease is dedicated to the well, outline each and identify the ownership thereof (both as to working interest and royalty).
- If more than one lease of different ownership is dedicated to the well, have the interests of all owners been consolidated by communitization, unitization, force-pooling, etc?

☐ Yes ☐ No If answer is "yes," type of consolidation \_\_\_\_\_

If answer is "no," list the owners and tract descriptions which have actually been consolidated. (Use reverse side of this form if necessary.) \_\_\_\_\_

No allowable will be assigned to the well until all interests have been consolidated (by communitization, unitization, forced-pooling, or otherwise) or until a non-standard unit, eliminating such interests, has been approved by the Commission.

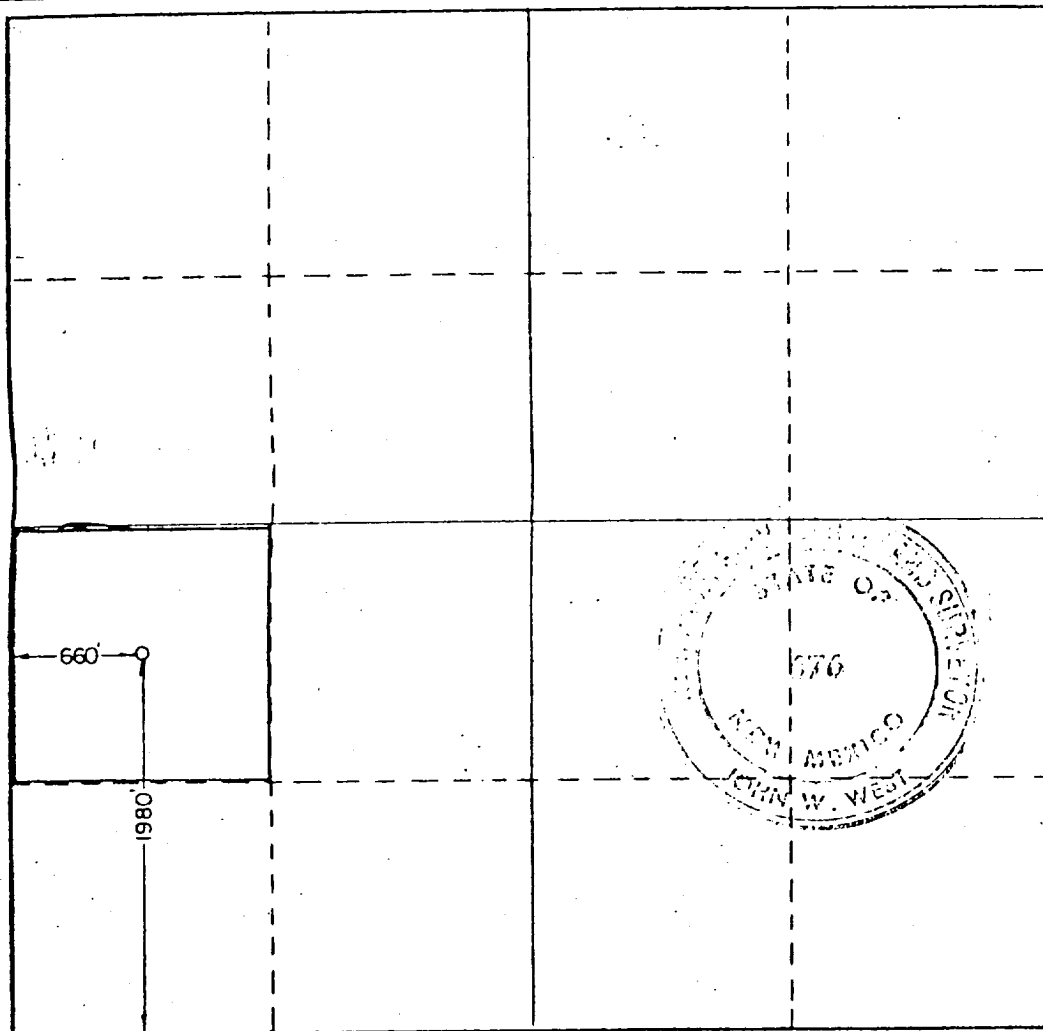

CERTIFICATION

I hereby certify that the information contained herein is true and complete to the best of my knowledge and belief.

*C. H. Peeples*

Name  
**C. H. Peeples**  
Position  
**Regional Drilling Manager**  
Company  
**Enserch Exploration, Inc.**  
Date  
**February 23, 1981**

I hereby certify that the well location shown on this plat was plotted from field notes of actual surveys made by me or under my supervision, and that the same is true and correct to the best of my knowledge and belief.

Date Surveyed  
**2-18-81**

Registered Professional Engineer and/or Land Surveyor

*John W. West*  
Certificate No. **JOHN W. WEST 676**  
**PATRICK A. ROMERO 6583**  
**Ronald J. Eidson 3239**

