

N' MEXICO OIL CONSERVATION COMMISS'
WELL LOCATION AND ACREAGE DEDICATION PLAT

Form C-102
 Supersedes C-128
 Effective 1-1-65

All distances must be from the outer boundaries of the Section

Operator Enserch Exploration Corp.			Lease Pearl Jordan		Well No. 1
Grid Letter C	Section 21	Township 4 South	Range 33 East	County Roosevelt	
Actual footage location of well: 660 feet from the North line and 1980 feet from the West line					
Gravelly over Elev. 4353.0	Predominant Formation Mississippian		Pool Midwest Undesignated	Dedicated Acreage 40	

1. Outline the acreage dedicated to the subject well by colored pencil or hatchure marks on the plat below.
2. If more than one lease is dedicated to the well, outline each and identify the ownership thereof (both as to working interest and royalty)
3. If more than one lease of different ownership is dedicated to the well, have the interests of all owners been consolidated by communitization, unitization, force-pooling, etc?

☐ Yes ☐ No If answer is "yes," type of consolidation _____

If answer is "no," list the owners and tract descriptions which have actually been consolidated (Use reverse side of this form if necessary.) _____

No allowable will be assigned to the well until all interests have been consolidated (by communitization, unitization, forced-pooling, or otherwise) or until a non-standard unit, eliminating such interests, has been approved by the Commission.

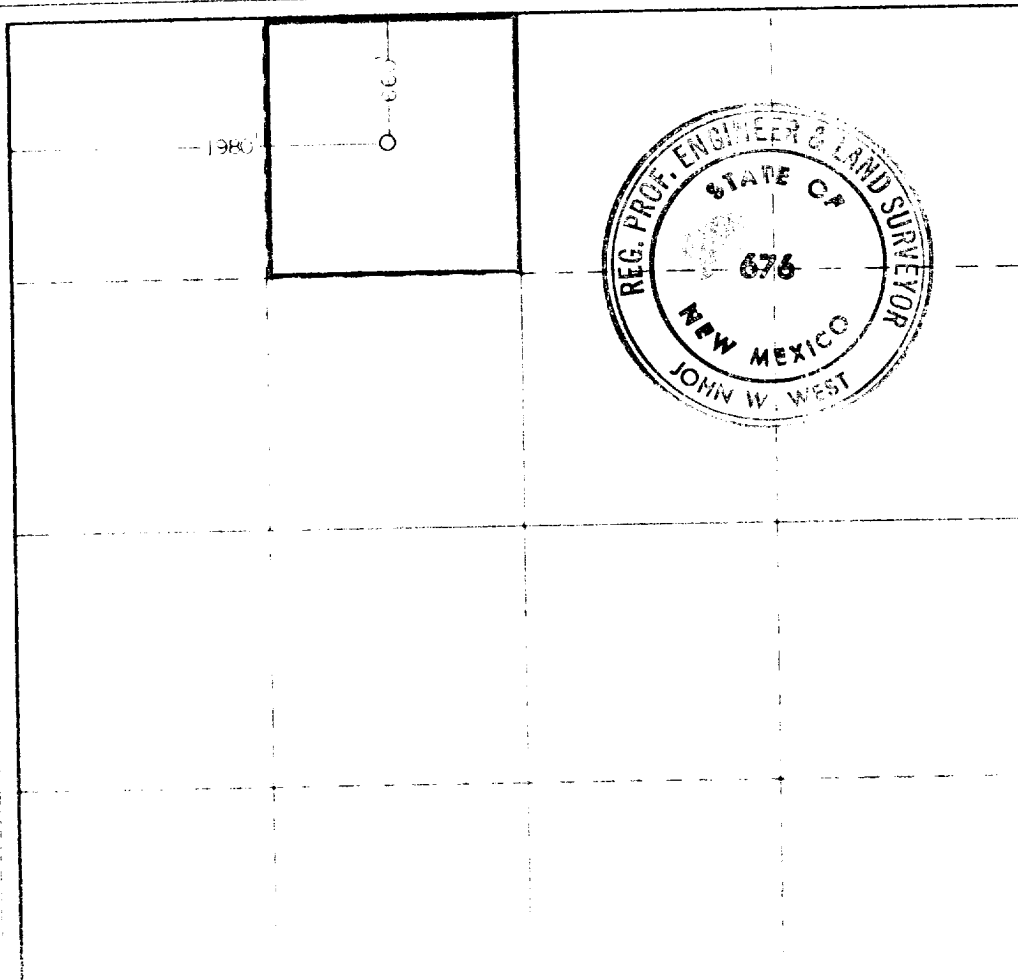

CERTIFICATION

I hereby certify that the information contained herein is true and complete to the best of my knowledge and belief.

C. H. Peeples

Name

C. H. Peeples

Position

Regional Drilling Manager

Company

Enserch Exploration, Inc.

Date

March 2, 1981

I hereby certify that the well location shown on this plat was plotted from field notes of actual surveys made by me or under my supervision, and that the same is true and correct to the best of my knowledge and belief.

Surveyed

2-24-81

Registered Professional Surveyor

State of New Mexico