

UNITED STATES  
DEPARTMENT OF THE INTERIOR  
GEOLOGICAL SURVEY

SUNDRY NOTICES AND REPORTS ON WELLS

(Do not use this form for proposals to drill or to deepen a well in a different reservoir. Use Form 9-331-C for such proposals.)

1. oil well ☒ gas well ☐ other ☐ U.S. GEOLOGICAL SURVEY  
HOBBS, NEW MEXICO
2. NAME OF OPERATOR  
SUNDANCE OIL COMPANY
3. ADDRESS OF OPERATOR  
#910, 1776 Lincoln St., Denver, CO 80203
4. LOCATION OF WELL (REPORT LOCATION CLEARLY. See space 17 below.)  
AT SURFACE: 720' FNL, 1781' FWL, Unit C  
AT TOP PROD. INTERVAL:  
AT TOTAL DEPTH: Same
16. CHECK APPROPRIATE BOX TO INDICATE NATURE OF NOTICE, REPORT, OR OTHER DATA

REQUEST FOR APPROVAL TO:

- TEST WATER SHUT-OFF ☐  
FRACTURE TREAT ☐  
SHOOT OR ACIDIZE ☐  
REPAIR WELL ☐  
PULL OR ALTER CASING ☐  
MULTIPLE COMPLETE ☐  
CHANGE ZONES ☐  
ABANDON\* ☐  
(other) MOVE WELL SITE ☐

SUBSEQUENT REPORT OF:

- ☐  
☐  
☐  
☐  
☐  
☐  
☐  
☐  
☐

5. LEASE  
NM-15019
6. IF INDIAN, ALLOTTEE OR TRIBE NAME
7. UNIT AGREEMENT NAME
8. FARM OR LEASE NAME  
Cone Federal
9. WELL NO.  
31-Y
10. FIELD OR WILDCAT NAME  
Tomahawk, San Andres
11. SEC., T., R., M., OR BLK. AND SURVEY OR AREA  
NE NW Section 19, T.7S., R.32E.
12. COUNTY OR PARISH  
Roosevelt
13. STATE  
New Mexico
14. API NO.
15. ELEVATIONS (SHOW DF, KDB, AND WD)  
4408' GL, 4420' KB

(NOTE: Report results of multiple completion or zone change on Form 9-330.)

17. DESCRIBE PROPOSED OR COMPLETED OPERATIONS (Clearly state all pertinent details, and give pertinent dates, including estimated date of starting any proposed work. If well is directionally drilled, give subsurface locations and measured and true vertical depths for all markers and zones pertinent to this work.)\*

Move well site of original well, Cone Federal #31, 60 feet south to avoid Railroad Mountain Dike. See attached plat.

Subsurface Safety Valve: Manu. and Type \_\_\_\_\_ Set @ \_\_\_\_\_ Ft.

18. I hereby certify that the foregoing is true and correct

SIGNED Richard O. Dimite TITLE V-P, Production DATE February 27, 1981

(This space for Federal or State office use)

APPROVED BY \_\_\_\_\_ TITLE \_\_\_\_\_ DATE \_\_\_\_\_  
CONDITIONS OF APPROVAL, IF ANY:

NEW MEXICO OIL CONSERVATION COMMISSION  
WELL LOCATION AND ACREAGE DEDICATION PLAT

Form C-102  
Supersedes C-128  
Effective 1-1-65

All distances must be from the outer boundaries of the Section

Operator <b>Sundance Oil Co.</b>			Lease <b>Cone</b>		Well No. <b>31</b>
Unit Letter <b>C</b>	Section <b>19</b>	Township <b>7 South</b>	Range <b>32 East</b>	County <b>Roosevelt Co.</b>	
Actual Footage Location of Well: <b>660</b> feet from the <b>North</b> line and <b>1781</b> feet from the <b>West</b> line					
Ground Level Elev. <b>4407.5</b>	Producing Formation <b>San Andres</b>		Pool <b>Tomahawk</b>	Dedicated Acreage: <b>40</b> Acres	

1. Outline the acreage dedicated to the subject well by colored pencil or hachure marks on the plat below.
2. If more than one lease is dedicated to the well, outline each and identify the ownership thereof (both as to working interest and royalty).
3. If more than one lease of different ownership is dedicated to the well, have the interests of all owners been consolidated by communitization, unitization, force-pooling, etc?

☐ Yes ☐ No If answer is "yes," type of consolidation \_\_\_\_\_

If answer is "no," list the owners and tract descriptions which have actually been consolidated. (Use reverse side of this form if necessary.) \_\_\_\_\_

No allowable will be assigned to the well until all interests have been consolidated (by communitization, unitization, forced-pooling, or otherwise) or until a non-standard unit, eliminating such interests, has been approved by the Commission.

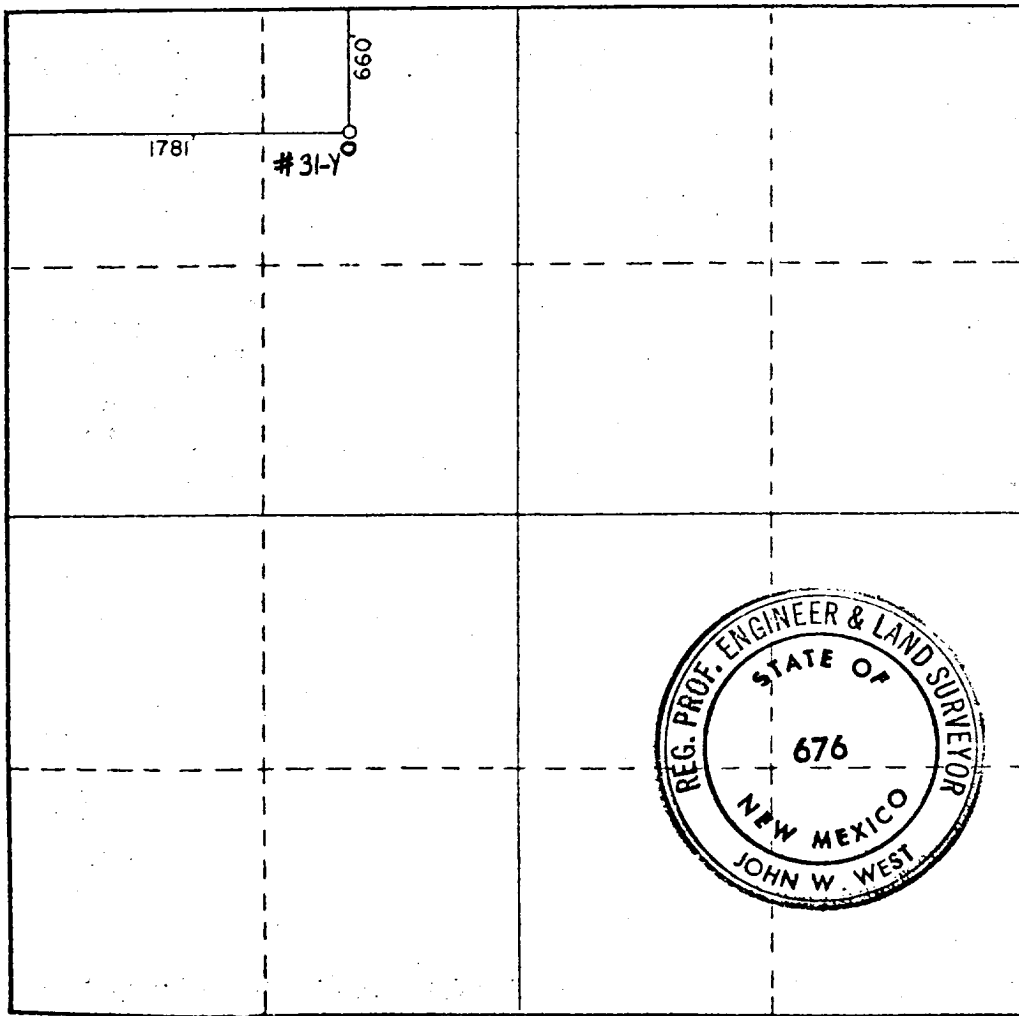

CERTIFICATION

I hereby certify that the information contained herein is true and complete to the best of my knowledge and belief.

Name

**Richard O. Dimit**

Position

**Vice President, Production**

Company

**Sundance Oil Company**

Date

**December 16, 1980**

I hereby certify that the well location shown on this plat was plotted from field notes of actual surveys made by me or under my supervision, and that the same is true and correct to the best of my knowledge and belief.

Date Surveyed

**12-3-80**

Registered Professional Engineer and/or Land Surveyor

Certificate No. **JOHN W. WEST 676**  
**PATRICK A. ROMERO 6663**  
**Ronald J. Eldson 3239**