

30-041-20586

STATE OF NEW MEXICO
ENERGY AND MINERALS DEPARTMENT

OIL CONSERVATION DIVISION

Form C-101
Revised 10-1-78

NO. OF COPIES RECEIVED	
DISTRIBUTION	
SANTA FE	
FILE	
U.S.G.S.	
LAND OFFICE	
OPERATOR	

P. O. BOX 2088
SANTA FE, NEW MEXICO 87501

5A. Indicate Type of Lease
STATE <input type="checkbox"/> FEE <input checked="" type="checkbox"/>
5. State Oil & Gas Lease No.

APPLICATION FOR PERMIT TO DRILL, DEEPEN, OR PLUG BACK

a. Type of Work	DRILL <input checked="" type="checkbox"/>	DEEPEN <input type="checkbox"/>	PLUG BACK <input type="checkbox"/>
b. Type of Well	OIL WELL <input checked="" type="checkbox"/>	GAS WELL <input type="checkbox"/>	OTHER <input type="checkbox"/>
c. Name of Operator			

7. Unit Agreement Name

8. Farm or Lease Name
Hoffman <i>Hofman</i>

9. Well No.
1

Shell Oil Company
Address of Operator
P. O. Box 991, T&C 458, Houston, TX. 77001
Location of Well

10. Field and Pool, or Wildcat
Wildcat

UNIT LETTER	L	LOCATED	1980	FEET FROM THE	South	LINE
ND	660	FEET FROM THE	West	LINE OF SEC.	35	TWP. 4S
				RGE.	34E	NMPM

12. County
Roosevelt

1. Elevations (Show whether DT, KT, etc.)			
4309. Ground			

19. Proposed Depth
8,725

19A. Formation
Pre-Cambrian

20. Rotary or C.T.
Rotary

21A. Kind & Status Plug. Bond
Blanket

22. Approx. Date Work will start
March 23, 1981

21B. Drilling Contractor
Cherokee

3. PROPOSED CASING AND CEMENT PROGRAM

SIZE OF HOLE	SIZE OF CASING	WEIGHT PER FOOT	SETTING DEPTH	SACKS OF CEMENT	EST. TOP
17 1/2"	13 3/8"	48# H-40 (New)	400'	600sx Cl. "C"	Surface
12 1/4"	8 5/8"	32# K-55 (New)	3600'	1st. Stage	2 stages to
				750 sx Cl. "H"	surface
				2nd. Stage	
				1100 sx Lite	
				tail w/300sx	
				Cl. "C" 2 stages	
				DV tool @ 1800'	
7 7/8"	5 1/2"	14# K-55 (new)	8725'	Volume of Class "H"	
				cement will be	
				determined later if	
				5 1/2" csg. is run.	

BOP Program: 3000# Regular Service

APPROVAL VALID FOR 180 DAYS
PERMIT OF DES 7/8/81
UNLESS DRILLING OTHERWISE

ABOVE SPACE DESCRIBE PROPOSED PROGRAM: IF PROPOSAL IS TO DEEPEN OR PLUG BACK, GIVE DATA ON PRESENT PRODUCTIVE ZONE AND PROPOSED NEW PRODUCTIVE ZONE. GIVE BLOWOUT PREVENTER PROGRAM, IF ANY.

I hereby certify that the information above is true and complete to the best of my knowledge and belief.

Signed *A. J. Fore* Title Supervisor, Reg./Permitting Date March 16, 1981

(This space for State Use)

APPROVED BY *[Signature]* TITLE SUPERVISOR DATE March 16, 1981

CONDITIONS OF APPROVAL, IF ANY:

**TW MEXICO OIL CONSERVATION COMM ON
WELL LOCATION AND ACREAGE DEDICATION PLAT**

Form O-102
Supersedes C-128
Effective 1-1-65

All distances must be from the outer boundaries of the Section

Operator SHELL OIL COMPANY			Lease HOFMAN 35		Well No. _____
Section 35	Township 4 SOUTH	Range 34 EAST	County ROOSEVELT		
Actual Well Location of Well:					
1280	feet from the SOUTH	line and	660	feet from the WEST	line
Spot Elevation 4309.0	Producing Formation PENNSYLVANIAN	Pool WILDCAT		Dedicated Acreage 40 Acres	

1. Outline the acreage dedicated to the subject well by colored pencil or hachure marks on the plat below.
2. If more than one lease is dedicated to the well, outline each and identify the ownership thereof (both as to working interest and royalty).
3. If more than one lease of different ownership is dedicated to the well, have the interests of all owners been consolidated by communitization, unitization, force-pooling, etc?

☐ Yes ☐ No If answer is "yes," type of consolidation _____

If answer is "no," list the owners and tract descriptions which have actually been consolidated. (Use reverse side of this form if necessary.) _____

No allowable will be assigned to the well until all interests have been consolidated (by communitization, unitization, forced-pooling, or otherwise) or until a non-standard unit, eliminating such interests, has been approved by the Commission.

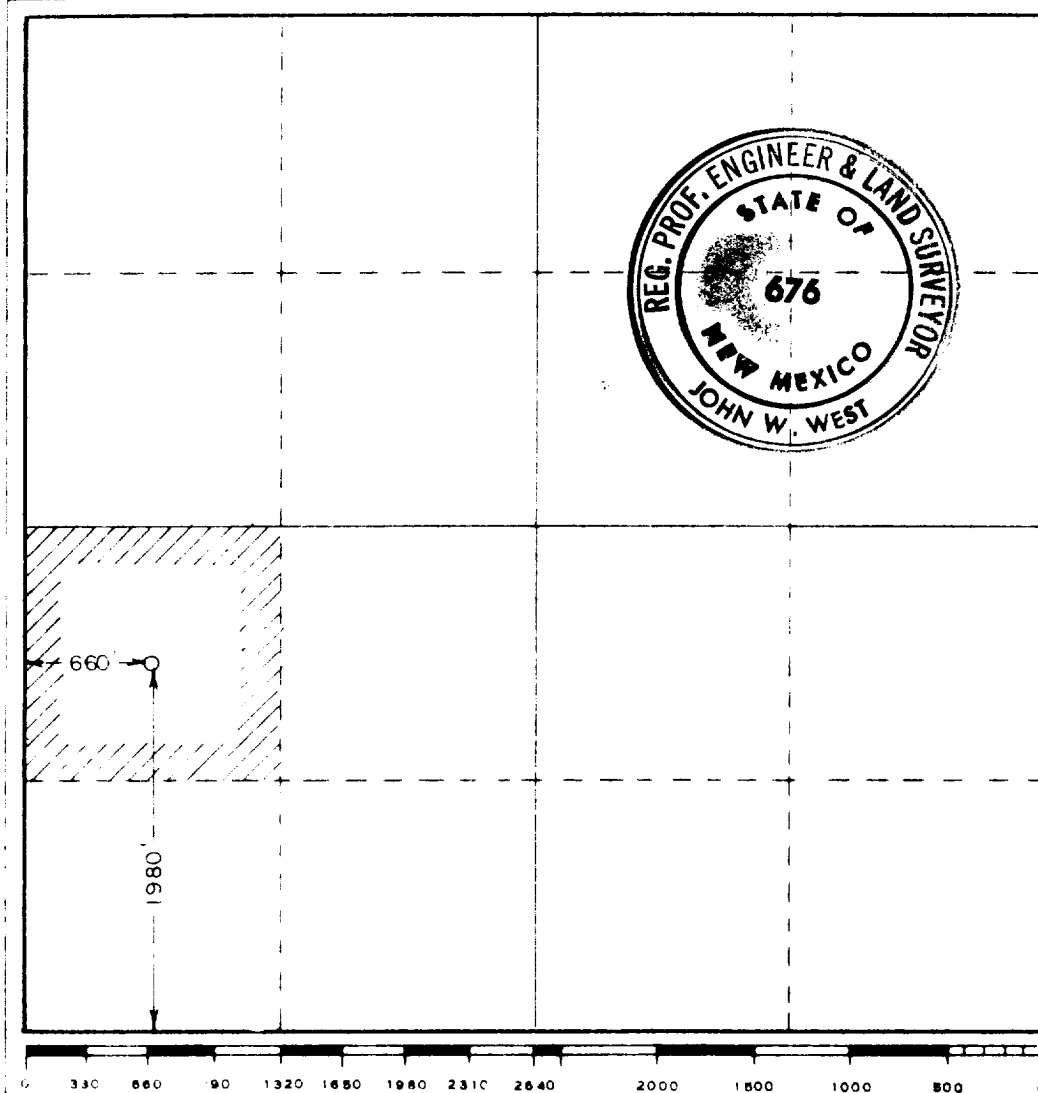

CERTIFICATION

I hereby certify that the information contained herein is true and complete to the best of my knowledge and belief

Name John W. West
 Position AGENT
 Company SHELL OIL CO.
 Date 3-17-31

I hereby certify that the well location shown on this plat was plotted from field notes of actual surveys made by me or under my supervision, and that the same is true and correct to the best of my knowledge and belief

Date Surveyed 3-17-31
 Registered Professional Engineer and/or Land Surveyor

John W. West
 Certificate No **JOHN W. WEST 676**
PATRICK A. ROMERO 6883
Ronald J. Eidson 3239