

30 041-20592

NO. COPIES RECEIVED	
DISTRIBUTION	
SANTA FE	
FILE	
U.S.G.S.	
LAND OFFICE	
OPERATOR	

NEW MEXICO OIL CONSERVATION COMMISSION

Form C-101
Revised 1-1-65

5A. Indicate Type of Lease
STATE <input type="checkbox"/> FEE <input checked="" type="checkbox"/>
5. State Oil & Gas Lease No.

APPLICATION FOR PERMIT TO DRILL, DEEPEN, OR PLUG BACK

1a. Type of Work		7. Unit Agreement No.	
b. Type of Well OIL WELL <input checked="" type="checkbox"/> GAS WELL <input type="checkbox"/> OTHER <input type="checkbox"/>		8. Name of Lessee Terry	
c. Name of Operator Enserch Exploration, Inc.		9. Well No. 1	
3. Address of Operator 1230 River Bend Drive - Suite 136 - Dallas, Texas 75247		10. Field and Loc. or Unit North, Peterson	
4. Location of Well UNIT LETTER D LOCATED 660 FEET FROM THE North LINE AND 660 FEET FROM THE West LINE OF SEC. 5 TWP. 5S RGE. 33E N.M.P.M.		11. County Roosevelt	
12. Proposed Depth 8300'		13A. Formation Mississippian Lm	
13B. Drilling Contractor Republic Drilling		13C. Rotary or C.R.	
21. Elevation (show whether D.F., R.L., etc.) 4471.3 GR		22. Approx. Date when well will start April 15, 1981	
21A. Kind & Status Plug. Bond American Insurance 5171534			

23.

PROPOSED CASING AND CEMENT PROGRAM

SIZE OF HOLE	SIZE OF CASING	WEIGHT PER FOOT	SETTING DEPTH	SACKS OF CEMENT	EST. TOP
17-1/2"	13-3/8"	48#	350	400	Surface
12-1/4"	9-5/8"	36#	2000	1150	Surface
8-3/4"	5-1/2"	15.5# & 17#	8300	1000	6000'

Drill to 8300' in search of oil. Will set 13-3/8" surface casing. A 13-3/8" 3000 psi bradenhead and a 12", 3000 psi BOP will be installed before drilling the intermediate hole. After 9-5/8" casing is set, a 9-5/8", 3000 psi bradenhead will be installed. A 12", 3000 psi double hydraulic BOP and a 12", 3000 psi Hydril will be installed on the 9-5/8" bradenhead. A 3000 psi choke manifold will be used from 2000' to total depth.

APPROVAL VALID FOR 180 DAYS
PERMIT EXPIRES 10/13/81
UNLESS DRILLING UNDERWAY

IN ABOVE SPACE DESCRIBE PROPOSED PROGRAM; IF PROPOSAL IS TO DEEPEN OR PLUG BACK, GIVE DATA ON PRESENT PRODUCTIVE ZONE AND PROPOSED NEW PRODUCTIVE ZONE. GIVE SLOWOUT PREVENTER PROGRAM, IF ANY.

I hereby certify that the information above is true and complete to the best of my knowledge and belief.

Signed C. H. Peoples Title Regional Drilling Manager Date March 31, 1981
(This space for State Use)

APPROVED BY [Signature] TITLE SUPERVISOR DISTRICT 8 DATE APR 1 1981
CONDITIONS OF APPROVAL, IF ANY:

NEW MEXICO OIL CONSERVATION COMMISSION
WELL LOCATION AND ACREAGE DEDICATION PLAT

Form C-102
Supersedes C-128
Effective 1-1-65

All distances must be from the outer boundaries of the Section.

Operator Enserch Exploration, Inc.,			Lease Terry		Well No. 1
Unit Letter D	Section 5	Township 5 South	Range 33 East	County Roosevelt	
Actual Footage Location of Well: 660 feet from the north line and 660 feet from the west line					
Ground Level Elev. 4471.3	Producing Formation Mississippian Lime		Pool Undesignated	Dedicated Acreage: 40 Acres	

1. Outline the acreage dedicated to the subject well by colored pencil or hatchure marks on the plat below.
2. If more than one lease is dedicated to the well, outline each and identify the ownership thereof (both as to working interest and royalty).
3. If more than one lease of different ownership is dedicated to the well, have the interests of all owners been consolidated by communitization, unitization, force-pooling, etc?

☐ Yes ☐ No If answer is "yes," type of consolidation _____

If answer is "no," list the owners and tract descriptions which have actually been consolidated. (Use reverse side of this form if necessary.) _____

No allowable will be assigned to the well until all interests have been consolidated (by communitization, unitization, forced-pooling, or otherwise) or until a non-standard unit, eliminating such interests, has been approved by the Commission.

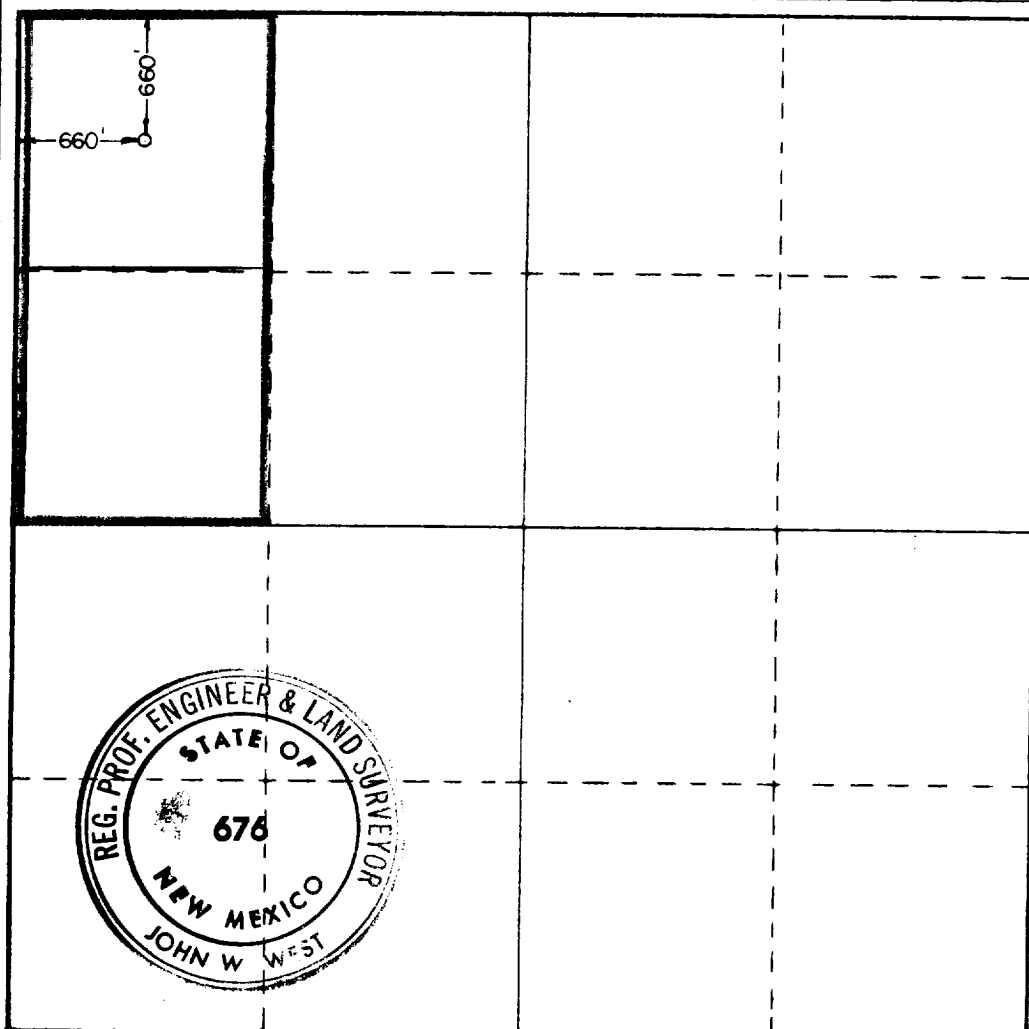

CERTIFICATION

I hereby certify that the information contained herein is true and complete to the best of my knowledge and belief.

C. H. Peeples

Name
C. H. Peeples
Position
Regional Drilling Manager
Company
Enserch Exploration, Inc.
Date
March 31, 1981

I hereby certify that the well location shown on this plat was plotted from field notes of actual surveys made by me or under my supervision, and that the same is true and correct to the best of my knowledge and belief.

Date Surveyed
3-27-81
Registered Professional Engineer and/or Land Surveyor

John W. West
Certificate No. **JOHN W. WEST 676**
PATRICK A. ROMERO 6803
Ronald J. Eidson 3239

RECEIVED
APR 2 1981
OIL CONSERVATION DIV.

ELF

OIL CONSERVATION DIV.

RECEIVED
APR 10 81