

NEW MEXICO OIL CONSERVATION COMMISSION
WELL LOCATION AND ACREAGE DEDICATION PLAT

Form C-102
 Supersedes C-128
 Effective 1-1-65

All distances must be from the outer boundaries of the Section.

Operator Enserch Exploration, Inc.,			Lease La Grone		Well No. 1
Unit Letter H	Section 29	Township 4 South	Range 33 East	County Roosevelt	
Actual Footage Location of Well: 1980 feet from the north line and 510 feet from the east line					
Ground Level Elev. 4359.2	Producing Formation Pennsylvanian	Pool Undesignated		Dedicated Acreage: 40 Acres	

1. Outline the acreage dedicated to the subject well by colored pencil or hachure marks on the plat below.
2. If more than one lease is dedicated to the well, outline each and identify the ownership thereof (both as to working interest and royalty).
3. If more than one lease of different ownership is dedicated to the well, have the interests of all owners been consolidated by communitization, unitization, force-pooling, etc?

☐ Yes ☐ No If answer is "yes," type of consolidation _____

If answer is "no," list the owners and tract descriptions which have actually been consolidated. (Use reverse side of this form if necessary.) _____

No allowable will be assigned to the well until all interests have been consolidated (by communitization, unitization, forced-pooling, or otherwise) or until a non-standard unit, eliminating such interests, has been approved by the Commission.

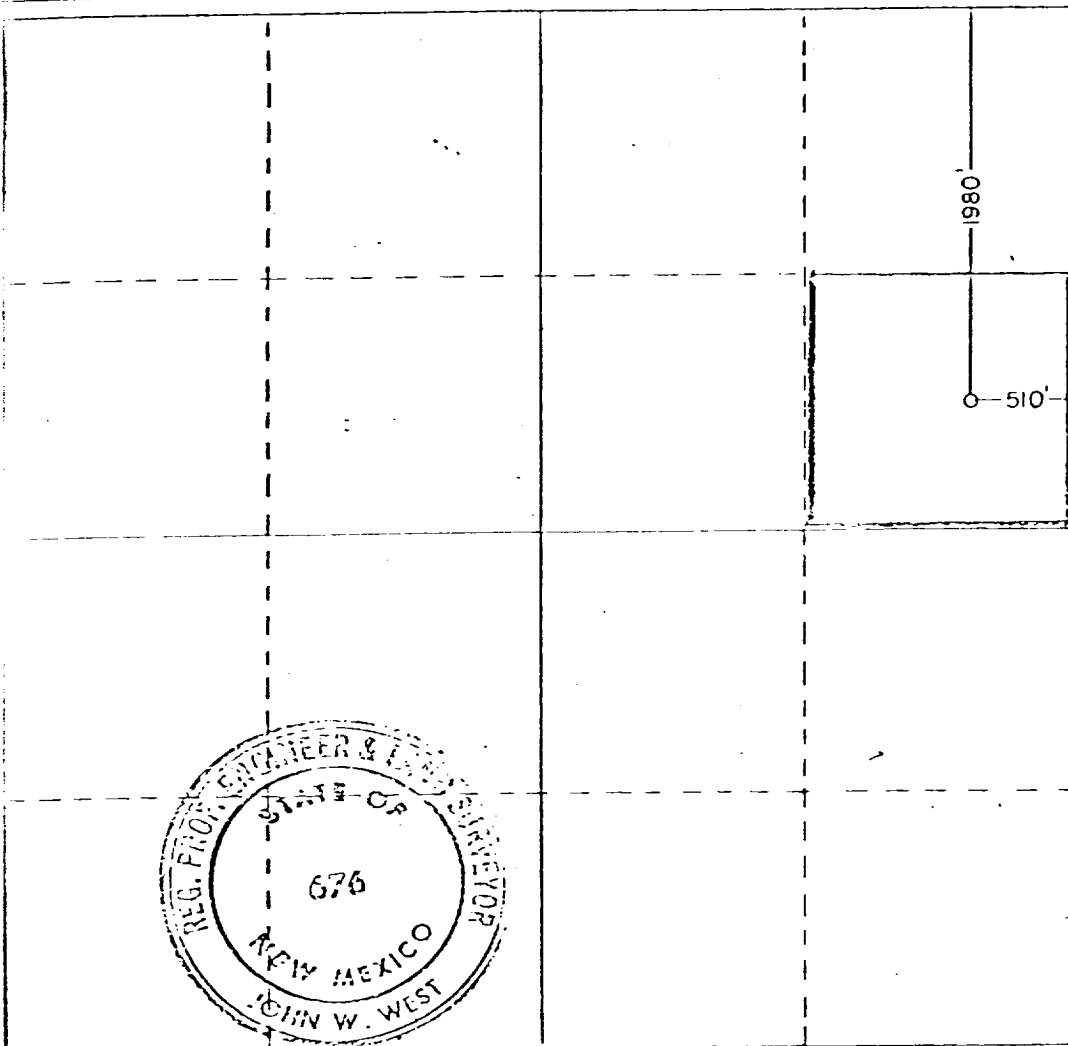

CERTIFICATION

I hereby certify that the information contained herein is true and complete to the best of my knowledge and belief.

Name
C. H. Peebles
 Position
Regional Drilling Manager
 Company
Enserch Exploration, Inc.
 Date
April 21, 1981

I hereby certify that the well location shown on this plat was plotted from field notes of actual surveys made by me or under my supervision, and that the same is true and correct to the best of my knowledge and belief.

Date Surveyed
April 13, 1981
 Registered Professional Engineer and/or Land Surveyor

John W. West
 Certificate No. **JOHN W. WEST 676**
PATRICK A. ROMERO 6868
Ronald J. Eldson 3239

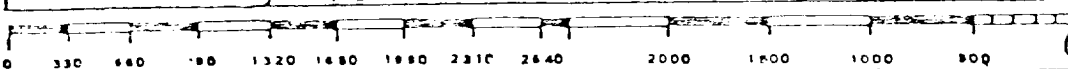

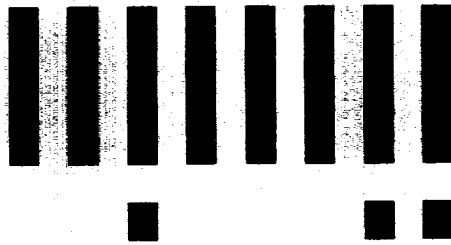

LTR



Job separation sheet

OIL CONSERVATION DIVISION
DISTRICT I

OIL CONSERVATION DIVISION
P. O. BOX 2088
SANTA FE, NEW MEXICO 87501

DATE 12/9/81

RE: Proposed MC _____
Proposed DHC X _____
Proposed NSL _____
Proposed NSP _____
Proposed SWD _____
Proposed WFX _____
Proposed PMX _____

Gentlemen:

I have examined the application for the:

Enserch Expl. Inc. Kathon #1-H 29-4-33
Operator Lease and Well No. Unit, S - T - R

and my recommendations are as follows:

OK JS

Yours very truly,

/mc