

30-041-20612

STATE OF NEW MEXICO
ENERGY AND MINERALS DEPARTMENT

OIL CONSERVATION DIVISION

P. O. BOX 2088
SANTA FE, NEW MEXICO 87501

Form C-101
Revised 10-1-78

NO. OF COPIES RECEIVED	
DISTRIBUTION	
SANTA FE	
FILE	
U.S.G.S.	
LAND OFFICE	
OPERATOR	

5A. Indicate Type of Lease
STATE ☒ FEE ☐
5. State Oil & Gas Lease No.
L-6739

APPLICATION FOR PERMIT TO DRILL, DEEPEN, OR PLUG BACK

1a. Type of Work
DRILL ☒ DEEPEN ☐ PLUG BACK ☐
1b. Type of Well
OIL WELL ☒ GAS WELL ☐ OTHER ☐
SINGLE ZONE ☐ MULTIPLE ZONE ☐

7. Unit Agreement Name
8. Form or Lease Name
State "36"

2. Name of Operator
The Eastland Oil Company
3. Address of Operator
P. O. Drawer 3488, Midland, Texas 79702

9. Well No.
1
10. Field and Pool, or Wildcat
Wildcat

4. Location of Well
UNIT LETTER **I** LOCATED **1650** FEET FROM THE **South** LINE
AND **900 990** FEET FROM THE **East** LINE OF SEC. **36** TWP. **6S** RGE. **33E** NADEN

12. County
Roosevelt

19. Proposed Depth **9000'** 19A. Formation **Ellenburger** 20. Rotary or C.T. **Rotary**
21. Elevations (show whether DE, RT, etc.) **4345' GR** 21A. Kind & Status Plug. Bond **Blanket on file** 21B. Drilling Contractor **Not determined** 22. Approx. Date Work will start **Sept. 1, 1981**

PROPOSED CASING AND CEMENT PROGRAM

SIZE OF HOLE	SIZE OF CASING	WEIGHT PER FOOT	SETTING DEPTH	SACKS OF CEMENT	EST. TOP
17 1/2	13 3/8	54#	400	450 sacks	Circulate
12 1/4	8 5/8	24# & 28#	3,150	1000 sacks	Circulate
7 7/8	5 1/2	15.5# & 17#	9,000	500 sacks	4000'

BOP make and type will be furnished as soon as Contractor is known.

APPROVAL VALID FOR **180** DAYS
PERMIT EXPIRES **2/10/82**
UNLESS DRILLING UNDERWAY

IN ABOVE SPACE DESCRIBE PROPOSED PROGRAM; IF PROPOSAL IS TO DEEPEN OR PLUG BACK, GIVE DATA ON PRESENT PRODUCTIVE ZONE AND PROPOSED NEW PRODUCTIVE ZONE. GIVE BLOWOUT PREVENTER PROGRAM, IF ANY.

I hereby certify that the information above is true and complete to the best of my knowledge and belief.

Signed *Larry E. Hall* Title **Vice-President-Production** Date **8-6-81**

(This space for State Use)

Only Signed By

Jerry Sexton

APPROVED BY *Don J. Suppe* TITLE _____ DATE _____

CONDITIONS OF APPROVAL, IF ANY:

RECEIVED

AUG 7 1981
AUG 7 1981

OIL CONSERVATION DIV.
OIL CONSERVATION DIV.

N MEXICO OIL CONSERVATION COMMISS.
WELL LOCATION AND ACREAGE DEDICATION PLAT

Form C-102
 Supersedes C-128
 Effective 1-1-65

All distances must be from the outer boundaries of the Section

Operator THE EASTLAND OIL CO.			Lease STATE 36		Well No. 1
Unit Letter I	Section 36	Township 6 South	Range 33 East	County Roosevelt	
Actual Footage Location of Well: 1650 feet from the South line and 990 feet from the East line					
Ground Level Elev. 4344.9	Producing Formation Ellenburger		Pool Wildcat	Dedicated Acreage 40	

1. Outline the acreage dedicated to the subject well by colored pencil or hatchure marks on the plat below.
2. If more than one lease is dedicated to the well, outline each and identify the ownership thereof (both as to working interest and royalty).
3. If more than one lease of different ownership is dedicated to the well, have the interests of all owners been consolidated by communitization, unitization, force-pooling, etc?

☐ Yes ☐ No If answer is "yes," type of consolidation _____

If answer is "no," list the owners and tract descriptions which have actually been consolidated. (Use reverse side of this form if necessary.) _____

No allowable will be assigned to the well until all interests have been consolidated (by communitization, unitization, forced-pooling, or otherwise) or until a non-standard unit, eliminating such interests, has been approved by the Commission.

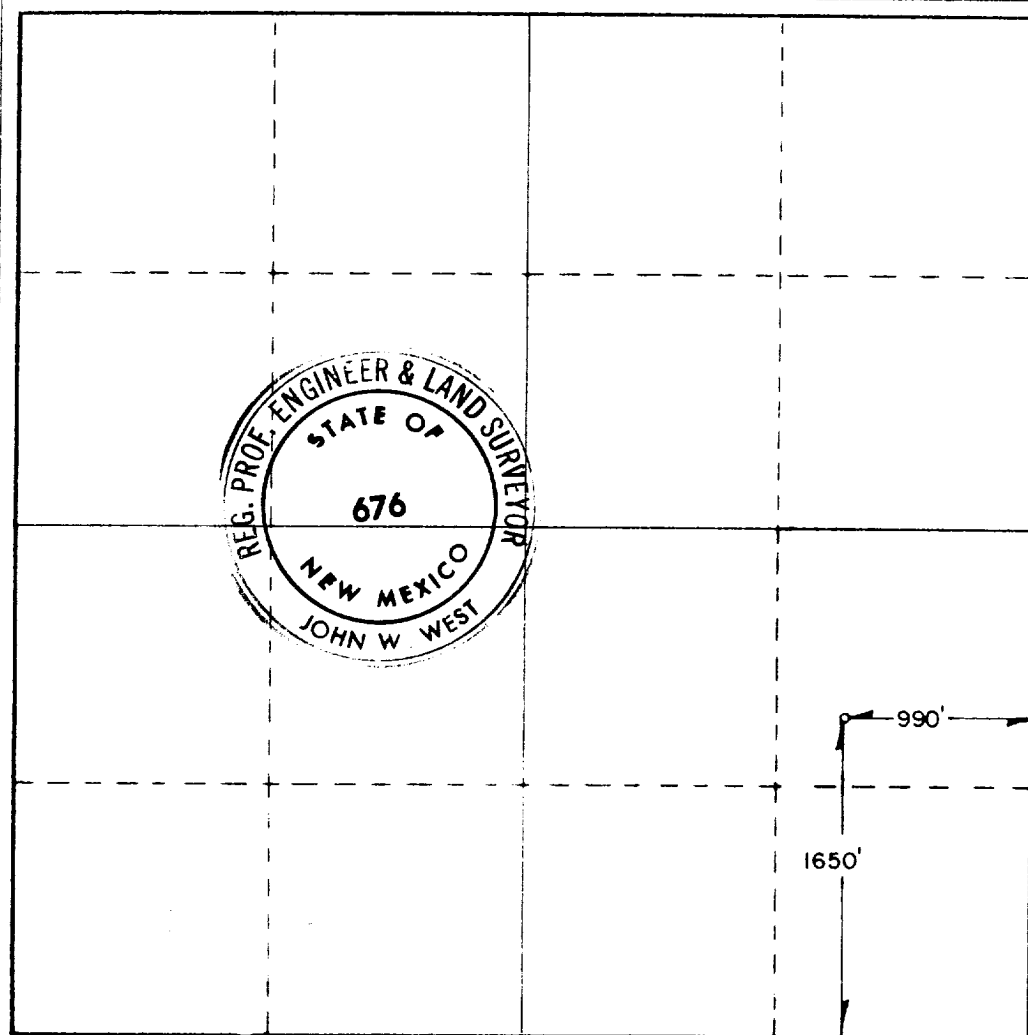

CERTIFICATION

I hereby certify that the information contained herein is true and complete to the best of my knowledge and belief.

George D. Neal
George D. Neal

Position
Vice-President-Production

Company
The Eastland Oil Company

Date
8-6-81

I hereby certify that the well location shown on this plat was plotted from field notes of actual surveys made by me or under my supervision, and that the same is true and correct to the best of my knowledge and belief.

Date Surveyed
8/1/81

Registered Professional Engineer and/or Land Surveyor

John W. West

Certificate No. **JOHN W. WEST 676**
PATRICK A. ROMERO 6863
Ronald J. Eidson 3239



RECEIVED

AUG 7 1981

OIL CONSERVATION DIV.

173