

30-041-20640

NO. OF COPIES RECEIVED	
DISTRIBUTION	
ANTA FE	
FILE	
U.S.G.S.	
LAND OFFICE	
OPERATOR	

NEW MEXICO OIL CONSERVATION COMMISSION

Form O-101
Revised 1-1-65

5A. Indicate Type of Lease STATE <input type="checkbox"/> LIFE <input checked="" type="checkbox"/>
5. State Oil & Gas Lease No.
7. Unit Agreement Name
8. Firm or Lease Name Amoco 5
9. Well No. 1
10. Field and Pool, or Wildcat Peterson
12. County Roosevelt
19. Proposed Depth 8400
19A. Formation Miss Fusselman
20. Rotary or C.T. Rt.
21. Elevations (Show whether DF, RT, etc.) 4460.7 G.L.
21A. Kind & Status Plug. Bond One Well # 2,500
21B. Drilling Contractor Pace Drilling
22. Approx. Date Work will start 2/1/82

APPLICATION FOR PERMIT TO DRILL, DEEPEN, OR PLUG BACK

1a. Type of Work b. Type of Well OIL WELL <input checked="" type="checkbox"/> GAS WELL <input type="checkbox"/> OTHER <input type="checkbox"/> 2. Name of Operator Pace Exploration Co. 3. Address of Operator P.O. Box 588 Artesia, NM 88210 4. Location of Well UNIT LETTER B LOCATED 660 FEET FROM THE North LINE AND 1980 FEET FROM THE East LINE OF SEC. 5 TWP. 5 S RGE. 33 E NMPM	DEEPEEN <input type="checkbox"/> PLUG BACK <input type="checkbox"/> SINGLE ZONE <input type="checkbox"/> MULTIPLE ZONE <input type="checkbox"/>
23. PROPOSED CASING AND CEMENT PROGRAM	

SIZE OF HOLE	SIZE OF CASING	WEIGHT PER FOOT	SETTING DEPTH	SACKS OF CEMENT	EST. TOP
17 1/2"	13 3/8"	48#	350'	450 sxs	Circulate
12 1/4"	9 5/8"	32#	2000'	1100 sxs	300' or circ.
8 5/8"	5 1/2"	15.5#	8400'	aprox. 700 sxs	600' above Cisco

BOP Program attached

Mud Program: Fresh water and native mud to 350'
Brine water and native to 6000'
Salt gel 9.8-10# WT. 6-8 WL. 6000'-8400'

APPROVAL VALID FOR 180 DAYS
PERMIT EXPIRES 7/25/82
UNLESS DRILLING UNDERWAY

IN ABOVE SPACE DESCRIBE PROPOSED PROGRAM; IF PROPOSAL IS TO DEEPEEN OR PLUG BACK, GIVE DATA ON PRESENT PRODUCTIVE ZONE AND PROPOSED NEW PRODUCTIVE ZONE. GIVE BLOWOUT PREVENTER PROGRAM, IF ANY.

I hereby certify that the information above is true and complete to the best of my knowledge and belief.

Signed [Signature] Title Exploration Mgr. Date 1/25/82

(This space for State Use)

APPROVED BY Los Clemente TITLE DATE

CONDITIONS OF APPROVAL, IF ANY:

NEW MEXICO OIL CONSERVATION COMMISSION
WELL LOCATION AND ACREAGE DEDICATION PLAT

Form No. 2
Supersedes O-128
1-1-60

All distances must be from the outer boundaries of the Section

Pace Exploration Co.		Moco 5		1	
B	5	5 South	33 East	Roosevelt	
660	North	1200	East	100	
460.7	Miss	Wildcat	80	100	

- Outline the acreage dedicated to the subject well by colored pencil or black ink marks on the plat below.
- If more than one lease is dedicated to the well, outline each and identify the ownership thereof (both as to working interest and royalty).
- If more than one lease of different ownership is dedicated to the well, have the interests of all owners been consolidated by communitization, unitization, force pooling, etc?

☒ Yes ☐ No If answer is "yes," type of consolidation Voluntary Pooling

If answer is "no," list the owners and tract descriptions which have actually been consolidated. (Use reverse side of this form if necessary.)

No allowable will be assigned to the well until all interests have been consolidated (by communitization, unitization, forced-pooling, or otherwise) or until a non-standard unit, eliminating such interests, has been approved by the Commission.

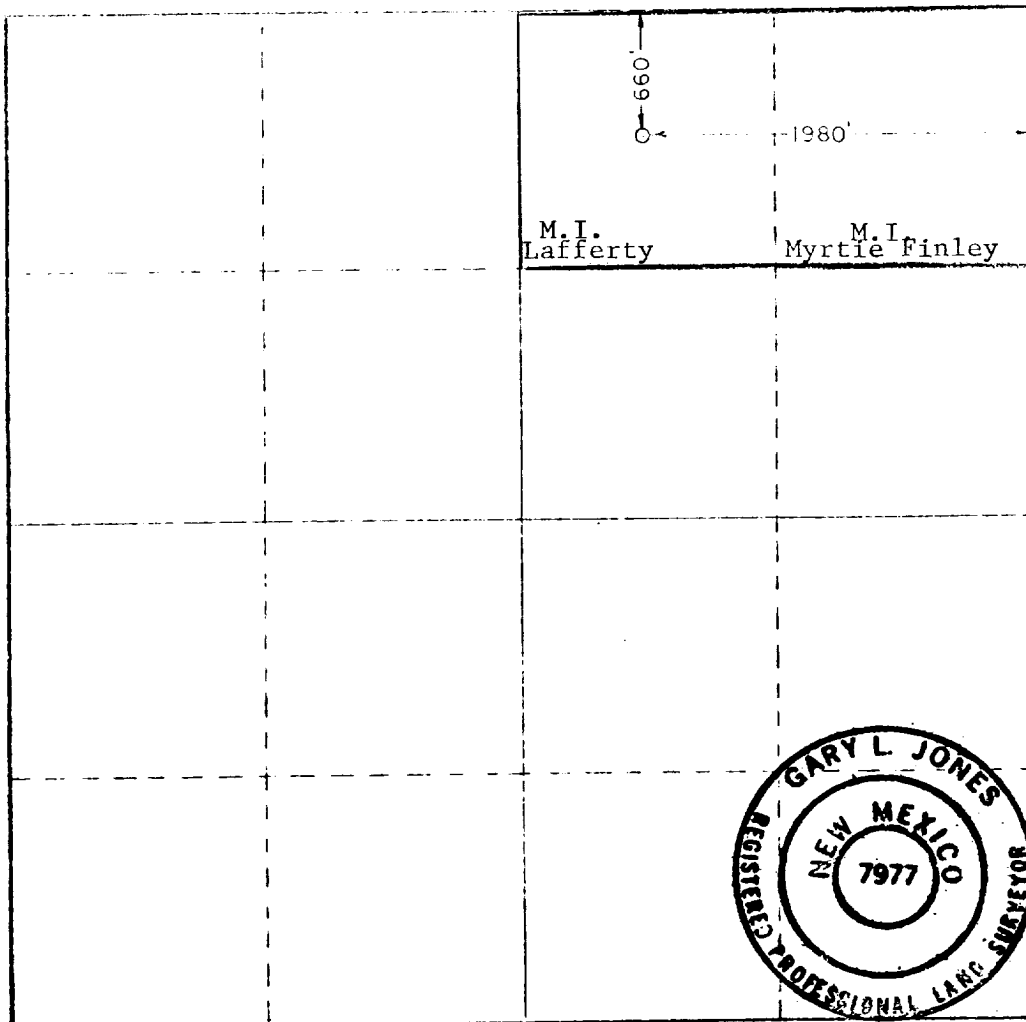

CERTIFICATION

I hereby certify that the information contained herein is true and complete to the best of my knowledge and belief.

Randall L. Harris

Name

Expl. Mgr

Position

Pace Expl.

Company

1/25/82

Date

I hereby certify that the well location shown on this plat was plotted from field notes of actual surveys made by me or under my supervision, and that the same is true and correct to the best of my knowledge and belief.

Date Surveyed

1/19/52

Registered Professional Engineer and/or Land Surveyor

Gary L. Jones

Certificate No.

7977

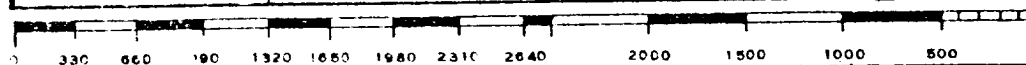

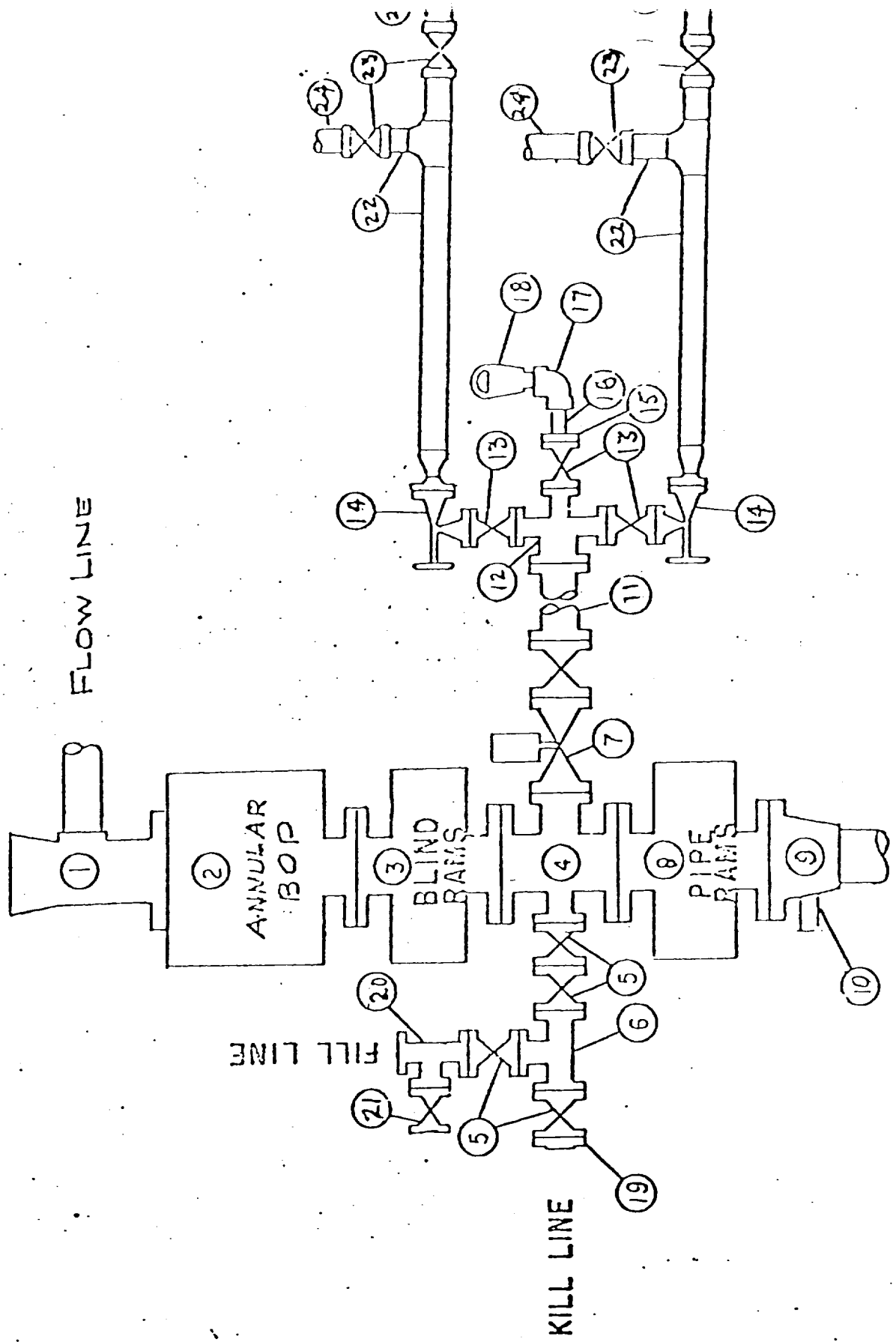

All equipment should be at least 3,000 psi WP or higher unless otherwise specified.

1. Bell nipple.
2. Hydril bag type preventer
3. Ram type pressure operated blowout preventer with blind rams.
4. Flanged spool with one 3-inch and one 2-inch (minimum) outlet.
5. 2-inch (minimum) flanged plug or gate valve.
6. 2-inch by 2-inch by 2-inch (minimum) flanged tee.
7. 3-inch gate valve.
8. Ram type pressure operated blowout preventer with pipe rams.
9. Flanged type casing head with one side outlet.
0. 2-inch threaded (or flanged) plug or gate valve.
Flanged on 5000# WP, threaded on 3000# WP or less.
1. 3-inch flanged spacer spool.
2. 3-inch by 2-inch by 2-inch by 2-inch flanged cross.
3. 2-inch flanged plug or gate valve.
4. 2-inch flanged adjustable choke.
5. 2-inch threaded flange.
6. 2-inch XXH nipple.
7. 2-inch forged steel 90° Ell.
8. Cameron (or equal.) threaded pressure gage.
9. Threaded flange.
0. 2-inch flanged tee.
1. 2-inch flanged plug or gate valve.
2. 2½-inch pipe, 300' to pit, anchored.
3. 2½-inch SE valve.
4. 2½-inch line to steel pit or separator.

NOTES:

1. Items 3, 4 and 8 may be replaced with double ram type preventer with side outlets between the rams.
2. The two valves next to the stack on the fill and kill line to be closed unless drill string is being pulled.
3. Kill line is for emergency use only. This connection shall not be used for filling.
4. Replacement pipe rams and blind rams shall be on location at all times.
5. Only type U, LSW and QRC ram type preventers with secondary seals are acceptable for 5000 psi WP and higher BOP stacks.
6. Type E ram-type BOP's with factory modified side outlets may be used on 3000 psi or lower WP BOP stacks.