

NO. OF COPIES RECEIVED		
DISTRIBUTION		
SANTA FE		
FILE		
U.S.G.S.		
LAND OFFICE		
OPERATOR		

NEW MEXICO OIL CONSERVATION COMMISSION

Form C-101
Revised 1-1-65

5A. Indicate Type of Lease
STATE ☐ FEE ☒

5. State Oil & Gas Lease No.

APPLICATION FOR PERMIT TO DRILL, DEEPEN, OR PLUG BACK

1a. Type of Work b. Type of Well OIL WELL <input checked="" type="checkbox"/> GAS WELL <input type="checkbox"/> OTHER <input type="checkbox"/> SINGLE ZONE <input checked="" type="checkbox"/> MULTIPLE ZONE <input type="checkbox"/>		DRILL <input checked="" type="checkbox"/> DEEPEN <input type="checkbox"/> PLUG BACK <input type="checkbox"/>		7. Unit Agreement Name
2. Name of Operator Getty Oil Company		3. Address of Operator P. O. Drawer DD, Levelland, Texas 79336-2071		8. Farm or Lease Name E.N.Taylor etal "30"
4. Location of Well UNIT LETTER <u>B</u> LOCATED <u>660</u> FEET FROM THE <u>North</u> LINE AND <u>1980</u> FEET FROM THE <u>East</u> LINE OF SEC. <u>30</u> TWP. <u>4S</u> RGE. <u>33E</u> NMPM		10. Field and Pool, or Wildcat Peterson Miss.		9. Well No. 1
				12. County Roosevelt
		19. Proposed Depth 8,500		19A. Formation Miss.
				20. Rotary or C.T. Rotary
21. Elevations (Show whether DF, KT, etc.) 4402.6 GL		21A. Kind & Status Plug. Bond Blanket on File		22. Approx. Date Work will start 1-29-82
		21B. Drilling Contractor Verna Drilling Co.		

23.

PROPOSED CASING AND CEMENT PROGRAM

SIZE OF HOLE	SIZE OF CASING	WEIGHT PER FOOT	SETTING DEPTH	SACKS OF CEMENT	EST. TOP
17 1/2"	13 3/8"	54.5	500	535	Surface
11"	8 5/8"	24	2100	590	Surface
7 7/8"	5 1/2"	17 - 15.5	8500	750	1500

BOP:

Camerson 12" 900 to be set on surface casing.

APPROVAL VALID FOR 180 DAYS
PERMIT EXPIRES 7/26/82
UNLESS DRILLING UNDERWAY

IN ABOVE SPACE DESCRIBE PROPOSED PROGRAM: IF PROPOSAL IS TO DEEPEN OR PLUG BACK, GIVE DATA ON PRESENT PRODUCTIVE ZONE AND PROPOSED NEW PRODUCTIVE ZONE. GIVE BLOWOUT PREVENTER PROGRAM, IF ANY.

I hereby certify that the information above is true and complete to the best of my knowledge and belief.

Signed C. L. Wade Title Area Superintendent Date 1-25-82

(This space for State Use)

APPROVED BY _____ TITLE _____ DATE JAN 25 1982

CONDITIONS OF APPROVAL, IF ANY:

**MEXICO OIL CONSERVATION COMMISSION
WELL LOCATION AND ACREAGE DEDICATION PLAT**

Form C-102
Supersedes C-128
Effective 1-1-65

All distances must be from the outer boundaries of the Section.

Operator Getty Oil Company			Lease E. N. Taylor et al 30		Well No. 1
Map Letter B	Section 30	Township 4 South	Range 33 East	County Roosevelt	
Actual Enclosure Location of Well: 660 feet from the north line and 1980 feet from the east line					
Ground Level Elev. 4402.6'	Producing Formation Mississippian		Pool Peterson Mississippian		Dedicated Acreage: 80 Acres

1. Outline the acreage dedicated to the subject well by colored pencil or hatchure marks on the plat below.
2. If more than one lease is dedicated to the well, outline each and identify the ownership thereof (both as to working interest and royalty).
3. If more than one lease of different ownership is dedicated to the well, have the interests of all owners been consolidated by communitization, unitization, force-pooling, etc?

☐ Yes ☐ No If answer is "yes," type of consolidation _____

If answer is "no," list the owners and tract descriptions which have actually been consolidated. (Use reverse side of this form if necessary.) _____

No allowable will be assigned to the well until all interests have been consolidated (by communitization, unitization, forced-pooling, or otherwise) or until a non-standard unit, eliminating such interests, has been approved by the Commission.

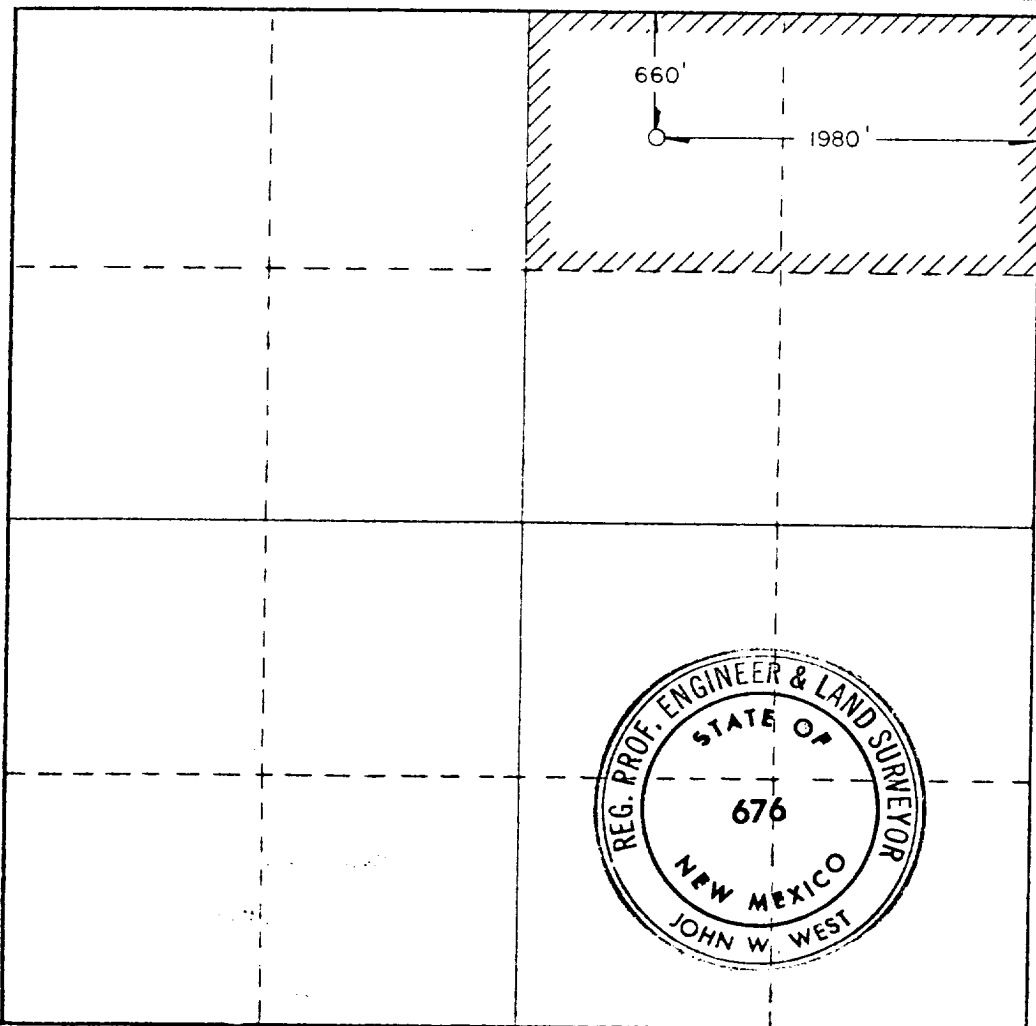

CERTIFICATION

I hereby certify that the information contained herein is true and complete to the best of my knowledge and belief.

C. L. Wade

Name

C. L. Wade

Position

Area Superintendent

Company

Getty Oil Company

Date

1-25-82

I hereby certify that the well location shown on this plat was plotted from field notes of actual surveys made by me or under my supervision, and that the same is true and correct to the best of my knowledge and belief.

Date Surveyed

1-23-82

Registered Professional Engineer and/or Land Surveyor

John W. West

Certificate No. **JOHN W. WEST 676**
PATRICK A. ROMERO 6863
Ronald J. Fiddan 3239

0 800 1000 1500 2000 2640 2310 1980 1650 1320 990 660 330

171
173

RECEIVED

JAN 26 1982

LAND CONSERVATION DIV