

STATE OF NEW MEXICO
ENERGY AND MINERALS DEPARTMENT

L CONSERVATION DIVISION
P. O. BOX 2088
SANTA FE, NEW MEXICO 87501

50-041-20708

Form C-101
Revised 10-1-78

NO. OF COPIES RECEIVED	
DISTRIBUTION	
SANTA FE	
FILE	
U.S.G.S.	
LAND OFFICE	
OPERATOR	

5A. Indicate Type of Lease
STATE ☐ FEE ☒

5. State Oil & Gas Lease No.

APPLICATION FOR PERMIT TO DRILL, DEEPEN, OR PLUG BACK

1a. Type of Work

DRILL ☒

DEEPEN ☐

PLUG BACK ☐

b. Type of Well

OIL WELL ☒

GAS WELL ☐

OTHER

SINGLE ZONE ☐

MULTIPLE ZONE ☐

2. Name of Operator

Yates Petroleum Corporation

3. Address of Operator

207 S. 4th, Artesia, New Mexico 88210

4. Location of Well

UNIT LETTER B

LOCATED 330

FEET FROM THE North

LINE

AND 1980

FEET FROM THE

East LINE OF SEC. 19

TWP. 7S

RGE. 32E

N.M.P.M.

7. Unit Agreement Name

8. Farm or Lease Name

Wilcox "TS"

9. Well No.

3

10. Field and Pool, or Wildcat

Tomahawk SA

17. County

Roosevelt

19. Proposed Depth

4250'

19A. Formation

San Andres

20. Rotary or C.T.

Rotary

21. Elevations (Show whether DE, RI, etc.)

4442.1' GL

21A. Kind & Status Plug. Bond

Blanket

21B. Drilling Contractor

L&M #1

22. Approx. Date Work will start

ASAP

23.

PROPOSED CASING AND CEMENT PROGRAM

SIZE OF HOLE	SIZE OF CASING	WEIGHT PER FOOT	SETTING DEPTH	SACKS OF CEMENT	EST. TOP
12 1/2"	8 5/8"	24# J-55	appr 1700'	500 sx	circ
7 7/8"	4 1/2"	9.5#	4250 TD	300 sx	

We propose to drill and test the San Andres and intermediate formations. Approximately 1700' of surface casing will be set and cement circulated to shut off gravel and caving. If commercial, production casing will be run and cemented with adequate cover, perforated and stimulated as needed for production.

MUD PROGRAM: Native mud to 1700', fresh water to TD.

BOP PROGRAM: BOP's will be installed at 1700' and tested daily.

APPROVAL VALID FOR 180 DAYS
PERMIT EXPIRES 6/12/84
UNLESS DRILLING UNDERWAY

ABOVE SPACE DESCRIBE PROPOSED PROGRAM; IF PROPOSAL IS TO DEEPEN OR PLUG BACK, GIVE DATA ON PRESENT PRODUCTIVE ZONE AND PROPOSED NEW PRODUCTIVE ZONE. GIVE BLOWOUT PREVENTER PROGRAM, IF ANY.

hereby certify that the information above is true and complete to the best of my knowledge and belief.

Signed Eddie Seay Title Regulatory Agent

Date 12/12/83

(This space for State Use)

ORIGINAL SIGNED BY EDDIE SEAY
OIL & GAS INSPECTOR

APPROVED BY _____ TITLE _____

DEC 12 1983

CONDITIONS OF APPROVAL, IF ANY:

**N / MEXICO OIL CONSERVATION COMMISSION
WELL LOCATION AND ACREAGE DEDICATION PLAT**

Form C-102
Supersedes C-128
Effective 1-1-65

All distances must be from the outer boundaries of the Section.

Operator YATES PETROLEUM CORPORATION			Lease Wilcox "TS"		Well No. 3
Unit Letter B	Section 19	Township 7	Range 32	County Roosevelt	
Actual Footage Location of Well: 330 feet from the North line and 1980 feet from the East line					
Ground Level Elev. 4442.1' GL	Producing Formation San Andres	Pool Tomahawk SA		Dedicated Acreage: 40 Acres	

1. Outline the acreage dedicated to the subject well by colored pencil or hatchure marks on the plat below.
2. If more than one lease is dedicated to the well, outline each and identify the ownership thereof (both as to working interest and royalty).
3. If more than one lease of different ownership is dedicated to the well, have the interests of all owners been consolidated by communitization, unitization, force-pooling, etc?

☐ Yes ☐ No If answer is "yes," type of consolidation _____

If answer is "no," list the owners and tract descriptions which have actually been consolidated. (Use reverse side of this form if necessary.) _____

No allowable will be assigned to the well until all interests have been consolidated (by communitization, unitization, forced-pooling, or otherwise) or until a non-standard unit, eliminating such interests, has been approved by the Commission.

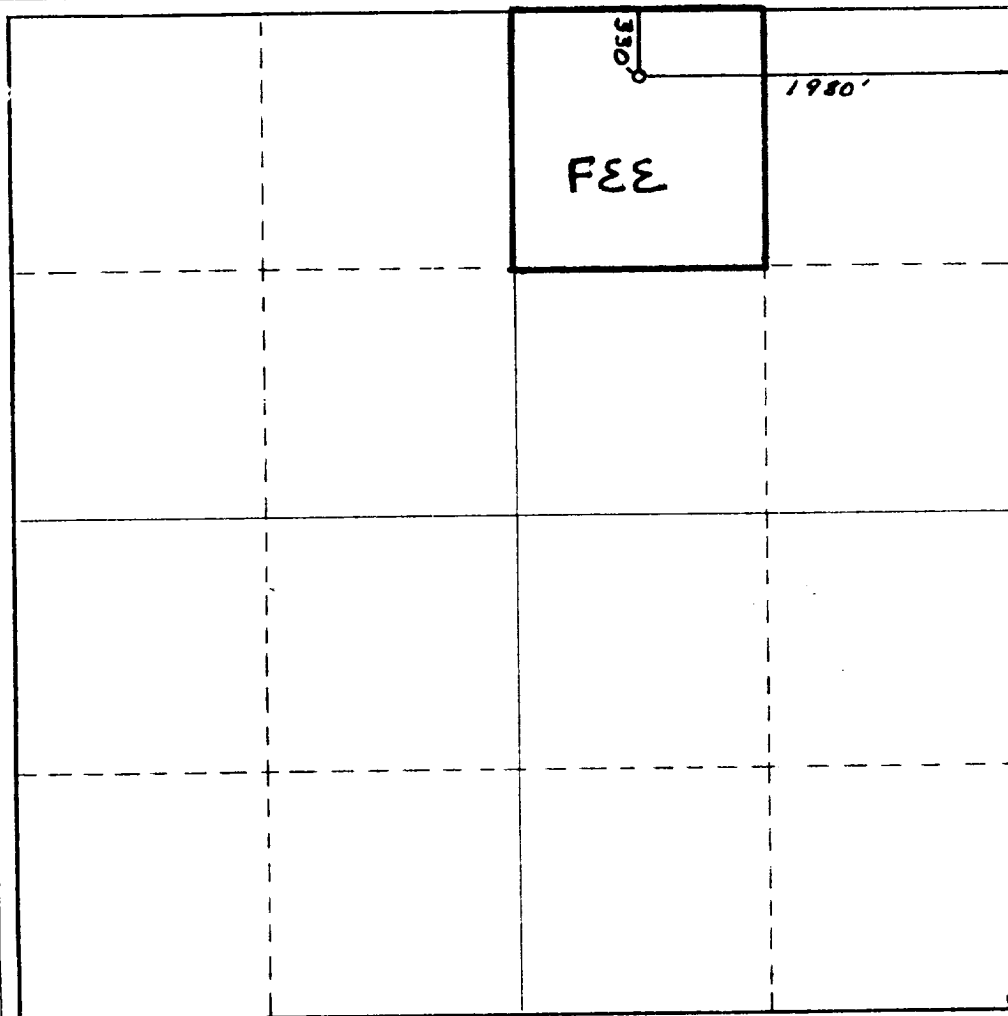

CERTIFICATION

I hereby certify that the information contained herein is true and complete to the best of my knowledge and belief.

Name
Gliserio Rodriguez
Position
Regulatory Agent
Company
Yates Petroleum Corp.

Date
12/12/83

I hereby certify that the well location shown on this plat was plotted from field notes of actual surveys made by me or under my supervision, and that the same is true and correct to the best of my knowledge and belief.

Date Surveyed
December 9, 1983
Registered Professional Engineer
and/or Land Surveyor

Certificate No. **3640**

0 330 660 990 1320 1650 1980 2310 2640 2000 1500 1000 500 0

EXHIBIT B
BDP DIAGRAM

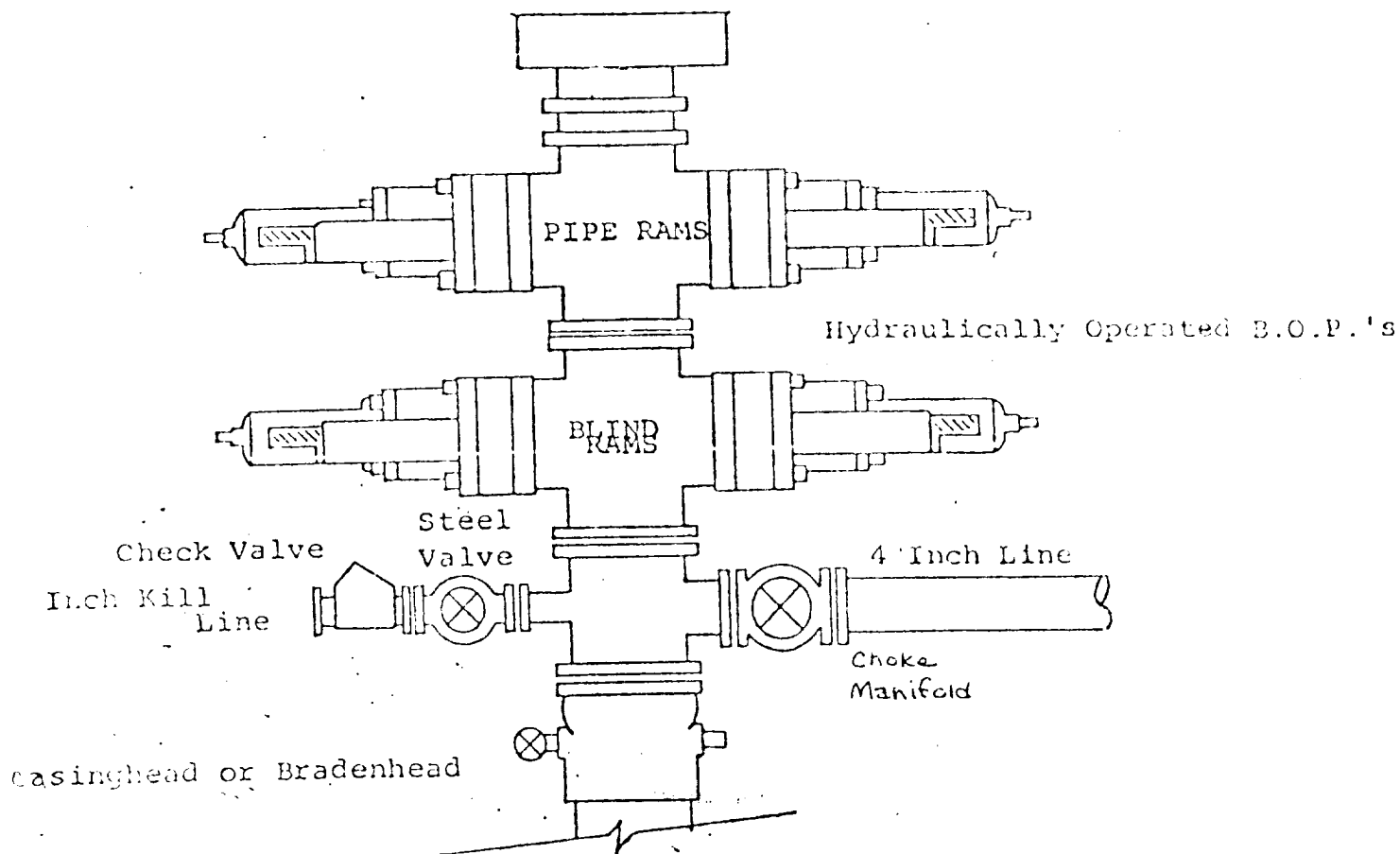

RECEIVED

DEC 12 1983

O.C.D.
HOBBS OFFICE

12
1983