

STATE OF NEW MEXICO
ENERGY AND MINERALS DEPARTMENT

L CONSERVATION DIVISION
P. O. BOX 2088
SANTA FE, NEW MEXICO 87501

NO. OF COPIES RECEIVED	
DISTRIBUTION	
SANTA FE	
FILE	
U.S.G.S.	
LAND OFFICE	
OPERATOR	

RECEIVED
DEC 19 1983
O. C. D.
ARTESIA, OFFICE

30-041-20713
Form C-101
Revised 10-1-78

5A. Indicate Type of Lease
STATE ☐ FEE ☒

5. State Oil & Gas Lease No.

7. Unit Agreement Name

8. Farm or Lease Name
Durwood "XW"

9. Well No.
1

10. Field and Pool, or Wildcat
Tomahawk/SA

11. Undesignated

12. County
Roosevelt

APPLICATION FOR PERMIT TO DRILL, DEEPEN, OR PLUG BACK

1a. Type of Work
DRILL ☒ DEEPEN ☐ PLUG BACK ☐

b. Type of Well
OIL WELL ☒ GAS WELL ☐ OTHER ☐ SINGLE ZONE ☐ MULTIPLE ZONE ☐

2. Name of Operator
Yates Petroleum Corporation

3. Address of Operator
207 S. 4th, Artesia, New Mexico 88210

4. Location of Well
UNIT LETTER P LOCATED 990 FEET FROM THE South LINE
AND 330 FEET FROM THE East LINE OF SEC. 18 TWP. 7S RGE. 32E NMPM

19. Proposed Depth
4280'

19A. Formation
San Andres

20. Rotary or C.T.
Rotary

21. Elevations (show whether DF, RT, etc.)
4448 GL

21A. Kind & Status Plug. Bond
Blanket

21B. Drilling Contractor
L&M #1

22. Approx. Date Work will start
ASAP

23. PROPOSED CASING AND CEMENT PROGRAM

SIZE OF HOLE	SIZE OF CASING	WEIGHT PER FOOT	SETTING DEPTH	SACKS OF CEMENT	EST. TOP
12 1/2"	8 5/8"	24# J-55	appr. 1670'	500 sx	circ
7 7/8"	4 1/2"	9.5#	TD	300 sx	

We propose to drill and test the San Andres and intermediate formations. Approximately 1700' of surface casing will be set and cement circulated to shut off gravel and caving. If commercial, production casing will be run and cemented with adequate cover, perforated and stimulated as needed for production.

MUD PROGRAM: Native mud to 1670', FW to TD.

BOP PROGRAM: BOP's will be installed at 1680' and tested daily.

APPROVAL VALID FOR 180 DAYS
PERMIT EXPIRES 6/29/84
UNLESS DRILLING UNDERWAY

4. ABOVE SPACE DESCRIBE PROPOSED PROGRAM; IF PROPOSAL IS TO DEEPEN OR PLUG BACK, GIVE DATA ON PRESENT PRODUCTIVE ZONE AND PROPOSED NEW PRODUCTIVE ZONE. GIVE BLOWOUT PREVENTER PROGRAM, IF ANY.

hereby certify that the information above is true and complete to the best of my knowledge and belief.

Signed [Signature] Title Regulatory Agent Date 12/19/83

(This space for State Use)

ORIGINAL SIGNED BY JERRY SEXTON
DISTRICT I SUPERVISOR

APPROVED BY _____ TITLE _____ DATE DEC 29 1983

CONDITIONS OF APPROVAL, IF ANY:

RECEIVED
DEC 28 1983
O.C.D.
HOBBS OFFICE

**MEXICO OIL CONSERVATION COMMISSION
WELL LOCATION AND ACREAGE DEDICATION PLAT**

Form C-102
Supersedes C-128
Effective 1-1-65

All distances must be from the outer boundaries of the Section.

Operator YATES PETROLEUM CORPORATION			Lease Durwood VII		Well No. 1
Unit Letter P	Section 18	Township 7 South	Range 32 East	County Roosevelt	
Actual Footage Location of Well: <div style="display: flex; justify-content: space-between;"> 990 feet from the South line and 330 feet from the East line </div>					
Ground Level Elev. 4448	Producing Formation SAN ANDRES		Pool UNDES TOMAHAWK SA	Dedicated Acreage 40 Acres	

1. Outline the acreage dedicated to the subject well by colored pencil or hatchure marks on the plat below.
2. If more than one lease is dedicated to the well, outline each and identify the ownership thereof (both as to working interest and royalty).
3. If more than one lease of different ownership is dedicated to the well, have the interests of all owners been consolidated by communitization, unitization, force-pooling, etc?

☐ Yes ☐ No If answer is "yes," type of consolidation _____

If answer is "no," list the owners and tract descriptions which have actually been consolidated. (Use reverse side of this form if necessary.) _____

No allowable will be assigned to the well until all interests have been consolidated (by communitization, unitization, forced-pooling, or otherwise) or until a non-standard unit, eliminating such interests, has been approved by the Commission.

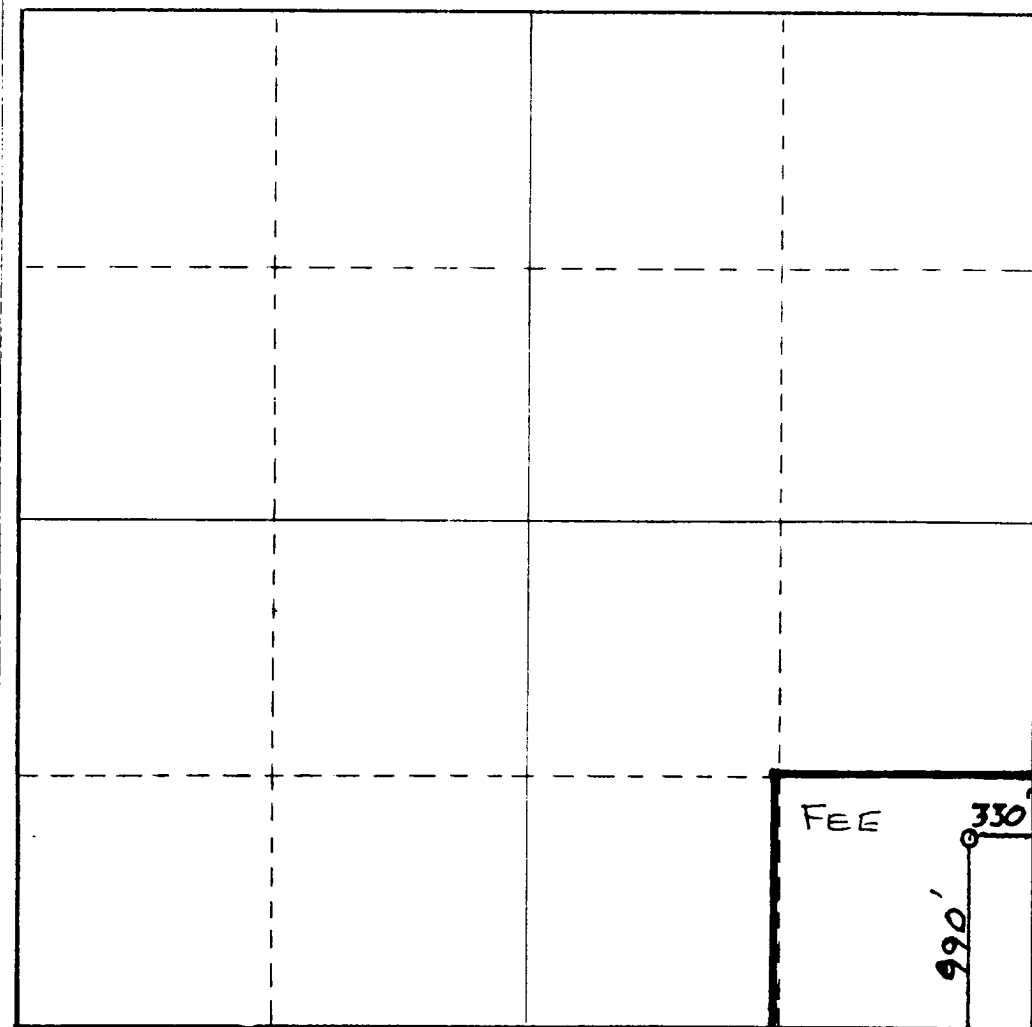

CERTIFICATION

I hereby certify that the information contained herein is true and complete to the best of my knowledge and belief.

Griserio Rodriguez
Name

GRISERIO RODRIGUEZ
Position

REG. AGT.

Company
YATES PET. CORP.

Date
12-19-83

I hereby certify that the well location shown on this plat was plotted from field notes of actual surveys made by me or under my supervision, and that the same is true and correct to the best of my knowledge and belief.

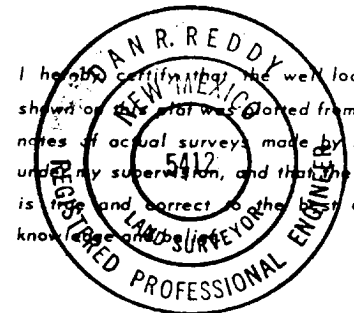

Date Surveyed

Dec. 17, 1983

Registered Professional Engineer and/or Land Surveyor

Dan R. Reddy
Certificate No.

NMPE&LS #5412

330 660 990 1320 1650 1980 2310 2640 2970 3300 3630 3960 4290 4620 4950 5280 5610 5940 6270 6600

EXHIBIT B

BOP DIAGRAM

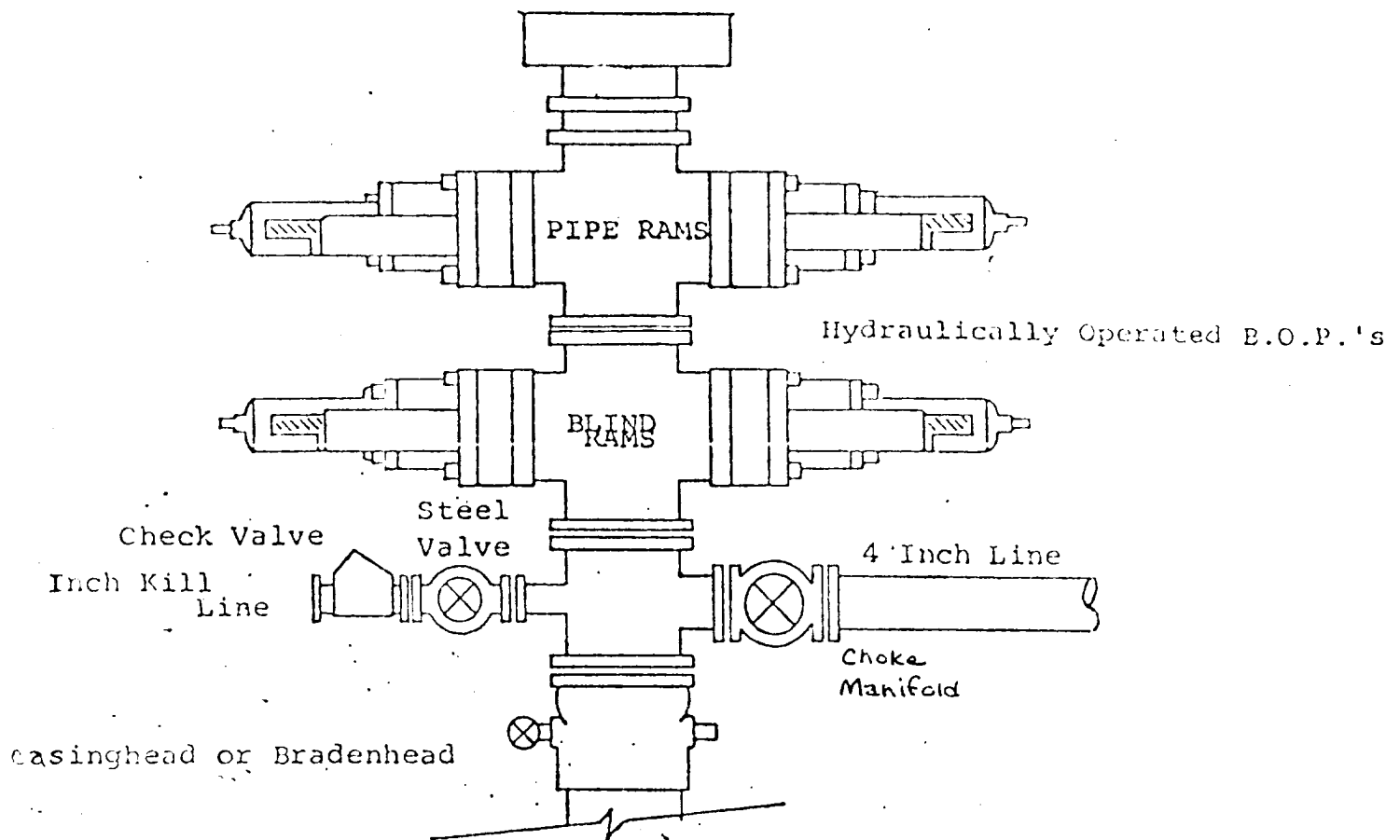

RECEIVED
DEC 28 1983
O.C.D.
HOBBS OFFICE

FILE