

30-041-20716

NO. OF COPIES RECEIVED	
DISTRIBUTION	
SANTA FE	
FILE	
U.S.G.S.	
LAND OFFICE	
OPERATOR	

## NEW MEXICO OIL CONSERVATION COMMISSION

Form C-101  
Revised 1-1-65

5A. Indicate Type of Lease	
STATE <input type="checkbox"/>	FEE <input checked="" type="checkbox"/>

5. State Oil &amp; Gas Lease No.

## APPLICATION FOR PERMIT TO DRILL, DEEPEN, OR PLUG BACK

1a. Type of Work		7. Unit Agreement Name	
b. Type of Well DRILL <input checked="" type="checkbox"/> DEEPEN <input type="checkbox"/> PLUG BACK <input type="checkbox"/> OIL WELL <input type="checkbox"/> GAS WELL <input type="checkbox"/> OTHER <input type="checkbox"/> SINGLE ZONE <input type="checkbox"/> MULTIPLE ZONE <input type="checkbox"/>		8. Farm or Lease Name Miller 10	
2. Name of Operator Energy Reserves Group, Inc.		9. Well No. 1	
3. Address of Operator P.O. Drawer 2437, Midland, Texas 79702		10. Field and Pool, or Wildcat Tanneyhill Granite Wash	
4. Location of Well UNIT LETTER <u>G</u> LOCATED <u>1980</u> FEET FROM THE <u>N</u> LINE AND <u>1650</u> FEET FROM THE <u>E</u> LINE OF SEC. <u>10</u> TWP. <u>6S</u> RGE. <u>33E</u> NMPM		12. County Roosevelt	
19. Proposed Depth 8000		19A. Formation Granite Wash	20. Rotary or C.T. Rotary
21. Elevations (Show whether DF, RT, etc.) 4390.2 GL	21A. Kind & Status Plug. Bond Blanket on file	21B. Drilling Contractor Norton Drlg. Co.	22. Approx. Date Work will start 1/24/84

## PROPOSED CASING AND CEMENT PROGRAM

SIZE OF HOLE	SIZE OF CASING	WEIGHT PER FOOT	SETTING DEPTH	SACKS OF CEMENT	EST. TOP
17 1/2	13 3/8	48#	400	300	surf.
11	8 5/8	24 & 32#	3250	500	surf.
7 7/8	4 1/2	11.6	8000	700	6000

Blowout prevention program: Cameron 11", 5000 PSI, Double Hydraulic space saver with remote control station.

Approved by 180 DAYS  
7/18/84  
 UNLESS DRILLING UNDERWAY.

IN ABOVE SPACE DESCRIBE PROPOSED PROGRAM: IF PROPOSAL IS TO DEEPEN OR PLUG BACK, GIVE DATA ON PRESENT PRODUCTIVE ZONE AND PROPOSED NEW PRODUCTIVE ZONE. GIVE BLOWOUT PREVENTER PROGRAM, IF ANY.

I hereby certify that the information above is true and complete to the best of my know edge and belief.

Signed R. L. Robertson Title Production Engineer III Date 1/16/84

(This space for State Use)

ORIGINAL SIGNED BY FODIE SEAY

APPROVED BY OIL & GAS INSPECTORDATE JAN 18 1984

CONDITIONS OF APPROVAL, IF ANY:

**NEW MEXICO OIL CONSERVATION COMMISSION  
WELL LOCATION AND ACREAGE DEDICATION PLAT**

Form C-122  
Supersedes C-128  
Effective 1-1-65

All distances must be from the outer boundaries of the Section

Operator <b>ENERGY RESERVES GROUP</b>			Lease <b>MILLER 10</b>		Well No. <b>1</b>
Tract Letter <b>G</b>	Section <b>10</b>	Township <b>6 SOUTH</b>	Range <b>33 EAST</b>	County <b>ROOSEVELT</b>	
Actual Footage Location of Well:					
<b>1980</b> feet from the <b>NORTH</b> line and		<b>1650</b> feet from the <b>EAST</b> line			
Ground Level Elev. <b>4390.2</b>	Producing Formation <b>Granite Wash</b>	Pool <b>Tanneyhill Granite Wash</b>		Dedicated Acreage: <b>40</b> Acres	

1. Outline the acreage dedicated to the subject well by colored pencil or hachure marks on the plat below.
2. If more than one lease is dedicated to the well, outline each and identify the ownership thereof (both as to working interest and royalty).
3. If more than one lease of different ownership is dedicated to the well, have the interests of all owners been consolidated by communitization, unitization, force-pooling, etc?

☐ Yes    ☐ No    If answer is "yes," type of consolidation \_\_\_\_\_

If answer is "no," list the owners and tract descriptions which have actually been consolidated. (Use reverse side of this form if necessary.) \_\_\_\_\_

No allowable will be assigned to the well until all interests have been consolidated (by communitization, unitization, forced-pooling, or otherwise) or until a non-standard unit, eliminating such interests, has been approved by the Commission.

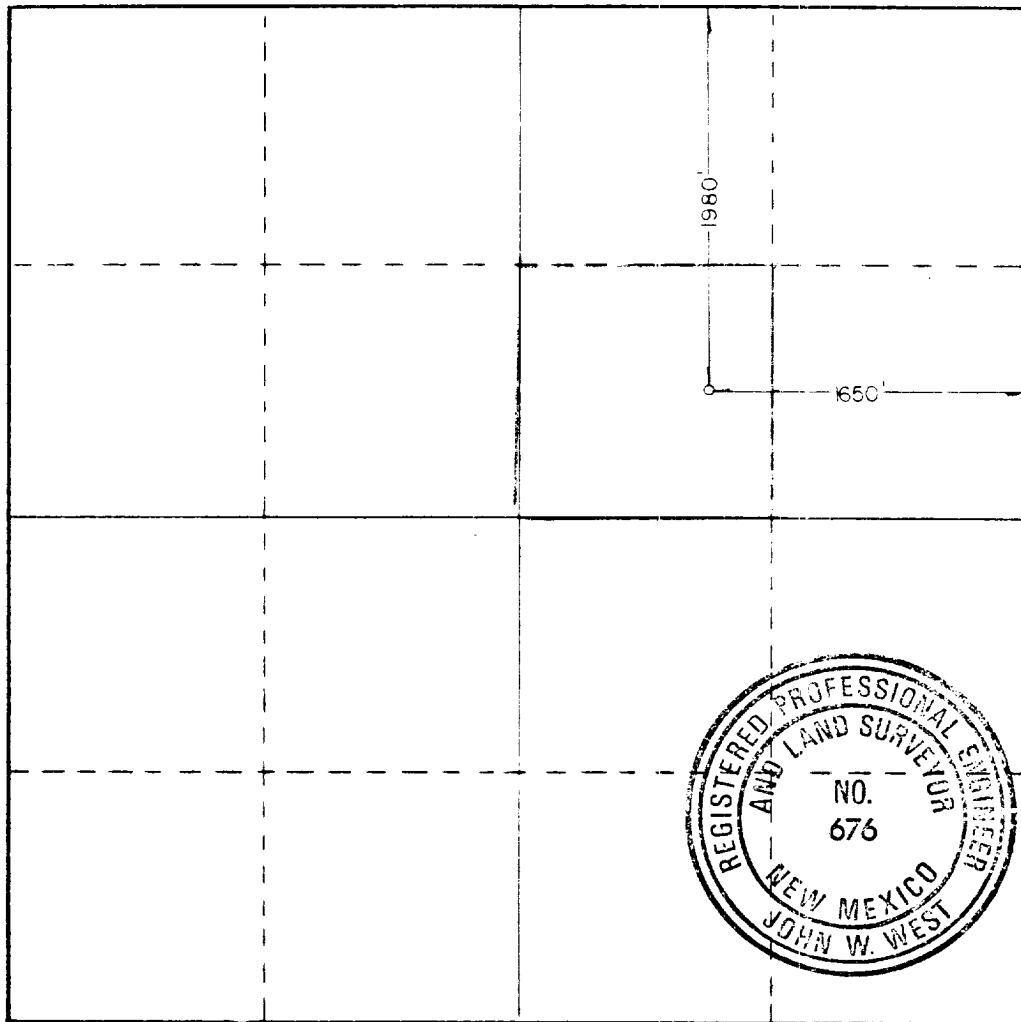

**CERTIFICATION**

I hereby certify that the information contained herein is true and complete to the best of my knowledge and belief.

*RL Robertson*

**R. L. Robertson**

Position

**Production Engineer III**

Company

**Energy Reserves Group, Inc.**

Date

**1/16/84**

I hereby certify that the well location shown on this plat was plotted from field notes of actual surveys made by me or under my supervision, and that the same is true and correct to the best of my knowledge and belief.

Date Surveyed

**1/13/84**

Registered Professional Engineer and/or Land Surveyor

*John W. West*

Certificate No. **JOHN W. WEST, 676**  
**RONALD J. EIDSON, 3239**

