

30-041-20769

NO. OF COPIES RECEIVED		
DISTRIBUTION		
NTA FEE		
FILE		
U.S.G.S.		
LAND OFFICE		
OPERATOR		

NEW MEXICO OIL CONSERVATION COMMISSION

Form C-101  
Revised 1-1-65

5A. Indicate Type of Lease	
STATE <input type="checkbox"/>	FEE <input checked="" type="checkbox"/>
5. State Oil & Gas Lease No.	

APPLICATION FOR PERMIT TO DRILL, DEEPEN, OR PLUG BACK

1a. Type of Work			7. Unit Agreement Name		
b. Type of Well DRILL <input checked="" type="checkbox"/> DEEPEN <input type="checkbox"/> PLUG BACK <input type="checkbox"/> OIL WELL <input checked="" type="checkbox"/> GAS WELL <input type="checkbox"/> OTHER <input type="checkbox"/> SINGLE ZONE <input checked="" type="checkbox"/> MULTIPLE ZONE <input type="checkbox"/>			8. Farm or Lease Name Tucker		
c. Name of Operator Chaveroo Operating Company, Inc.			9. Well No. 5		
d. Address of Operator c/o Oil Reports & Gas Services, Inc., Box 763, Hobbs, NM 88241			10. Field and Pool, or Wildcat Chaveroo San Andres		
4. Location of Well UNIT LETTER M LOCATED 1310 ECT FROM THE South LINE AND 1310 FEET FROM THE West LINE OF SEC. 24 TWP. 7S RGE. 32E NMPM			12. County Roosevelt		
19. Proposed Depth 4500			19A. Formation San Andres		20. Rotary or C.T. Rotary
21. Elevations (Show whether DE, RT, etc.) 4452.6		21A. Kind & Status Plug. Bond Blanket	21B. Drilling Contractor Young Drilling Company		22. Approx. Date Work will start Upon Approval

PROPOSED CASING AND CEMENT PROGRAM

SIZE OF HOLE	SIZE OF CASING	WEIGHT PER FOOT	SETTING DEPTH	SACKS OF CEMENT	EST. TOP
12 1/4	8 5/8	24#	1800	600	Circulated
7 7/8	4 1/2	10.5#	4500	300	2750

Completion to be conventional perforation & treatment

Blowout preventer sketch attached

Filed pending approval of unorthodox location.

Permit Expires 6 Months From Approval  
Date Unless Drilling Underway.

R-7774 NSL

IN ABOVE SPACE DESCRIBE PROPOSED PROGRAM: IF PROPOSAL IS TO DEEPEN OR PLUG BACK, GIVE DATA ON PRESENT PRODUCTIVE ZONE AND PROPOSED NEW PRODUCTIVE ZONE. GIVE BLOWOUT PREVENTER PROGRAM, IF ANY.

I hereby certify that the information above is true and complete to the best of my knowledge and belief.

Signed W. J. Sexton Title Agent Date 11/26/84

(This space for State Use)

ORIGINAL SIGNED BY JERRY SEXTON

APPROVED BY DISTRICT SUPERVISOR TITLE  DATE JAN 16 1985

CONDITIONS OF APPROVAL, IF ANY:

**NEW MEXICO OIL CONSERVATION COMMISSION  
WELL LOCATION AND ACREAGE DEDICATION PLAT**

Form C-102  
Supersedes C-128  
Effective 1-1-65

All distances must be from the outer boundaries of the Section

Operator <b>CHAVEROO OPERATING CO.</b>			Lease <b>TUCKER</b>		Well No. <b>5</b>
Unit Letter <b>M</b>	Section <b>24</b>	Township <b>7S</b>	Range <b>32E</b>	County <b>ROOSEVELT</b>	
Actual Footage Location of Well: <b>1310</b> feet from the <b>SOUTH</b> line and <b>1310</b> feet from the <b>WEST</b> line					
Ground Level Elev. <b>4452.6</b>	Producing Formation <b>San Andres</b>	Pool <b>Chaveroo</b>		Dedicated Acreage: <b>40</b> Acres	

1. Outline the acreage dedicated to the subject well by colored pencil or hachure marks on the plat below.
2. If more than one lease is dedicated to the well, outline each and identify the ownership thereof (both as to working interest and royalty).
3. If more than one lease of different ownership is dedicated to the well, have the interests of all owners been consolidated by communitization, unitization, force-pooling, etc?

☐ Yes    ☐ No    If answer is "yes," type of consolidation \_\_\_\_\_

If answer is "no," list the owners and tract descriptions which have actually been consolidated. (Use reverse side of this form if necessary.) \_\_\_\_\_

No allowable will be assigned to the well until all interests have been consolidated (by communitization, unitization, forced-pooling, or otherwise) or until a non-standard unit, eliminating such interests, has been approved by the Commission.

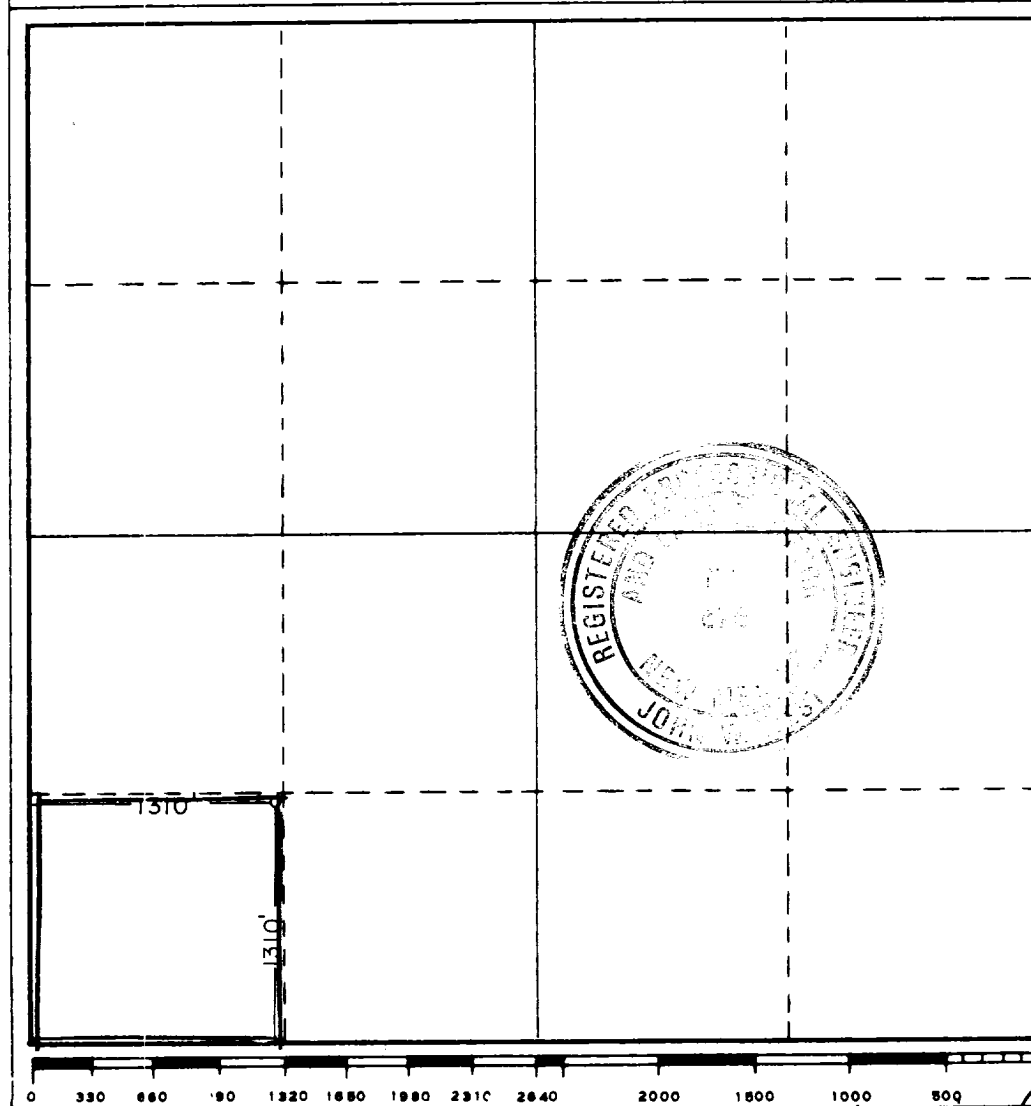

**CERTIFICATION**

I hereby certify that the information contained herein is true and complete to the best of my knowledge and belief.

Name  
*Thomas Walker*  
Position  
**Agent**  
Company  
**Chaveroo Operating Co., Inc.**  
Date  
**11/26/84**

I hereby certify that the well location shown on this plat was plotted from field notes of actual surveys made by me or under my supervision, and that the same is true and correct to the best of my knowledge and belief.

Date Surveyed  
**10/25/84**  
Registered Professional Engineer and/or Land Surveyor  
*John W. West*  
Certificate No. **JOHN W. WEST, 676**  
**RONALD J. EIDSON, 3239**

