

Submit to Appropriate
District Office
State Lease - 6 copies
Fee Lease - 5 copies

State of New Mexico
Energy, Minerals and Natural Resources Department

Form C-101
Revised 1-1-89

OIL CONSERVATION DIVISION

DISTRICT I
P.O. Box 1980, Hobbs, NM 88240

DISTRICT II
P.O. Drawer DD, Artesia, NM 88210

DISTRICT III
1000 Rio Brazos Rd., Aztec, NM 87410

P.O. Box 2088

Santa Fe, New Mexico 87504-2088

API NO. (assigned by OCD on New Wells)

30-041-20866

5. Indicate Type of Lease

STATE ☐

FEE ☒

6. State Oil & Gas Lease No.

Fee

APPLICATION FOR PERMIT TO DRILL, DEEPEN, OR PLUG BACK

1a. Type of Work:

DRILL ☒

RE-ENTER ☐

DEEPEN ☐

PLUG BACK ☐

b. Type of Well:

OIL
WELL ☒

GAS
WELL ☐

OTHER ☐

SINGLE
ZONE ☐

MULTIPLE
ZONE ☐

7. Lease Name or Unit Agreement Name

Askew

2. Name of Operator

Strata Production Company

8. Well No.

#1

3. Address of Operator

P. O. Box 1030, Roswell, New Mexico 88202-1030

9. Pool name or Wildcat

Wildcat

4. Well Location

Unit Letter H : 1980 Feet From The North Line and 660 Feet From The East Line

Section 27

Township 5 South

Range 35 East

NMPM

Roosevelt

County

10. Proposed Depth

8100'

11. Formation

Devonian

12. Rotary or C.T.

Rotary

13. Elevations (Show whether DF, RT, GR, etc.)

4172' GR

14. Kind & Status Plug. Bond

Statewide

15. Drilling Contractor

WEK

16. Approx. Date Work will start

10/26/92

17. PROPOSED CASING AND CEMENT PROGRAM

SIZE OF HOLE	SIZE OF CASING	WEIGHT PER FOOT	SETTING DEPTH	SACKS OF CEMENT	EST. TOP
17 1/2"	13 3/8"	48#	350'	Circulate	Surface
12 1/4" & 11"	8 5/8"	24# & 32#	3350'	Circulate	Surface
7 7/8"	5 1/2"	17#	8100'	Tie back to intermediate casing	

We propose to drill a 17 1/2" hole to 350' and set 13 3/8" casing. The 13 3/8" casing will be cemented with a sufficient amount of cement to circulate to the surface.

We then propose to drill a 12 1/4" hole to 2000' and a 11" hole from 2000' to 3350' and set 3350' of 8 5/8" casing and circulate cement to surface. We will then drill a 7 7/8" hole to 8100' and log with GR-CNL-LDT and DLL-MSFL-GR logs. If the well is dry, it will be plugged pursuant to NMOC rules and regulations. If the well is completed as a producer, 5 1/2" casing will be run and cemented with a sufficient amount of cement to tie back to the intermediate string.

The hole from surface to 350' will be drilled with native mud. The hole from 350' to 3350' will be drilled with cut brine. The hole from 3350' to TD will be drilled with salt gel and starch to maintain adequate viscosity and water loss. SEE BOP DIAGRAM ATTACHED

IN ABOVE SPACE DESCRIBE PROPOSED PROGRAM: IF PROPOSAL IS TO DEEPEN OR PLUG BACK, GIVE DATA ON PRESENT PRODUCTIVE ZONE AND PROPOSED NEW PRODUCTIVE ZONE. GIVE BLOWOUT PREVENTER PROGRAM, IF ANY.

I hereby certify that the information above is true and complete to the best of my knowledge and belief.

SIGNATURE

Carol J. Garcia

TITLE

Production Supervisor

DATE

10/21/92

TYPE OR PRINT NAME

Carol J. Garcia

TELEPHONE NO.

622-1127

(This space for State Use)

Drig. Signed by
Paul Kautz

APPROVED BY

Geologist

TITLE

DATE

OCT 22 '92

CONDITIONS OF APPROVAL, IF ANY:

Permit Expires 6 Months From Approval
Date Unless Drilling Underway.

Submit to Appropriate
District Office
State Lease - 4 copies
Lease - 3 copies

State of New Mexico
Energy, Minerals and Natural Resources Department

Form C-102
Revised 1-1-89

OIL CONSERVATION DIVISION

P.O. Box 2088
Santa Fe, New Mexico 87504-2088

DISTRICT I
P.O. Box 1980, Hobbs, NM 88240

DISTRICT II
P.O. Drawer DD, Artesia, NM 88210

DISTRICT III
1000 Pro Brazos Rd., Aztec, NM 87410

WELL LOCATION AND ACREAGE DEDICATION PLAT

All Distances must be from the outer boundaries of the section

Operator STRATA PRODUCTION Co.			Lease ASKEW		Well No. #1
Section Letter H	Section 27	Township 5S.	Range 35E.	County NMPM	ROOSEVELT
Actual Footage Location of Well: 1980 feet from the NORTH line and 660 feet from the EAST line					
Ground Level Elev. 4172	Producing Formation Devonian	Pool Wildcat	Dedicated Acreage: 40 Acres		

- Outline the acreage dedicated to the subject well by colored pencil or hatchure marks on the plat below.
- If more than one lease is dedicated to the well, outline each and identify the ownership thereof (both as to working interest and royalty).
- If more than one lease of different ownership is dedicated to the well, have the interest of all owners been consolidated by communitization, unitization, force-pooling, etc.?
☐ Yes ☐ No If answer is "yes" type of consolidation _____
If answer is "no" list the owners and tract descriptions which have actually been consolidated. (Use reverse side of this form if necessary.)
No allowable will be assigned to the well until all interests have been consolidated (by communitization, unitization, forced-pooling, or otherwise) or until a non-standard unit, eliminating such interest, has been approved by the Division.

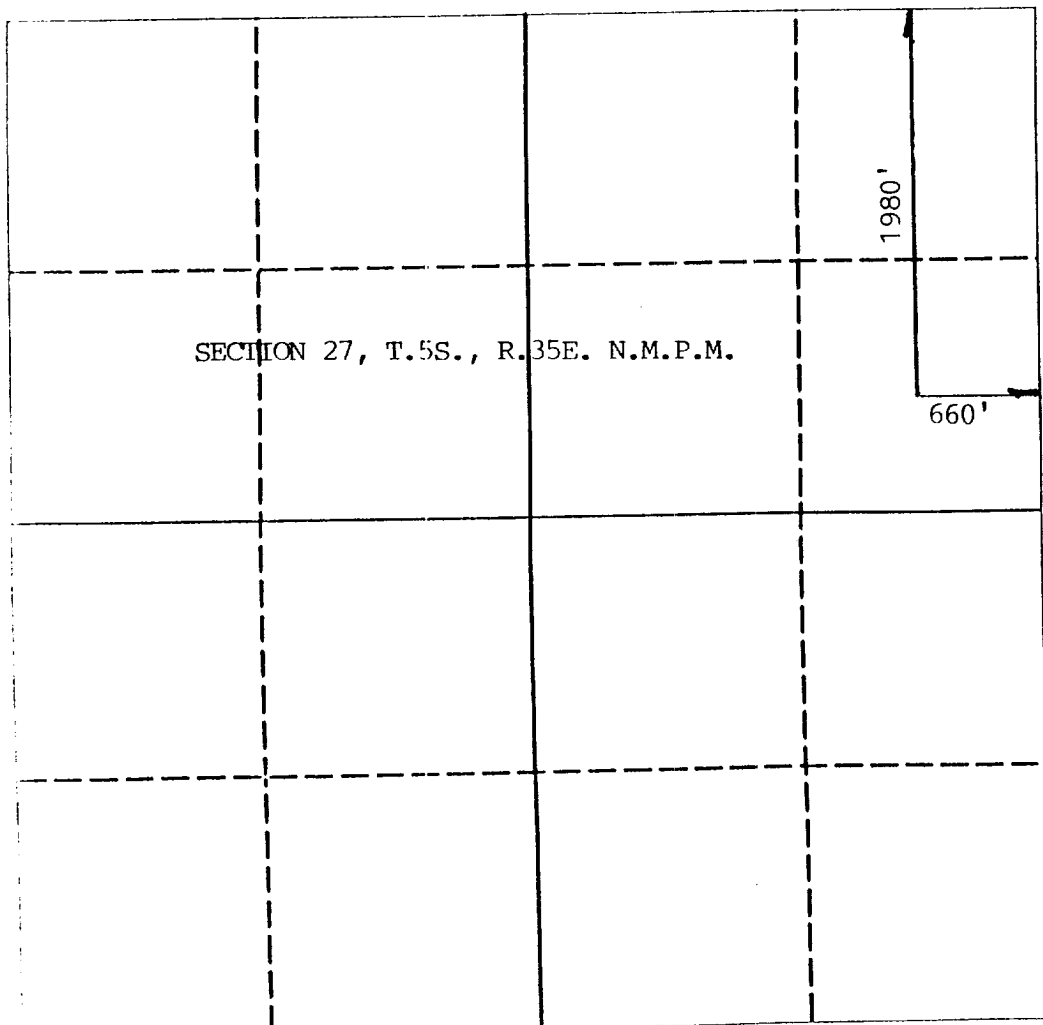

OPERATOR CERTIFICATION

I hereby certify that the information contained herein is true and complete to the best of my knowledge and belief.

Signature
Carol J. Garcia
Printed Name
Carol J. Garcia
Position
Production Supervisor
Company
Strata Production Company
Date
10/21/92

SURVEYOR CERTIFICATION

I hereby certify that the well location shown on this plat was plotted from field notes of actual surveys made by me or under my supervision, and that the same is true and correct to the best of my knowledge and belief.

Date Surveyed
10/20/92
Signature & Seal of Professional Surveyor
6290
Certificate No.
6290

EQUIPMENT DESCRIPTION

All equipment should be at least 3,000 psi WP or higher unless otherwise specified.

1. Bell nipple
2. Hydril bag type preventer
3. Ram type pressure operated blowout preventer with blind rams.
4. Flanged spool with one 3" and one 2" (minimum) outlet.
5. 2" (minimum) flanged plug or gate valve.
6. 2"x 2"x 2" (minimum) flanged.
7. 3" gate valve.
8. Ram type pressure operated blowout preventer with pipe rams.
9. Flanged type casing head with one side outlet.
10. 2" threaded (or flanged) plug or gate valve. Flanged on 5000# WP, threaded on 3000# WP or less.
11. 3" flanged spacer spool.
12. 3"x 2"x 2"x 2" flanged cross.
13. 2" flanged plug or gate valve.
14. 2" flanged adjustable choke.
15. 2" threaded flange.
16. 2" XXH nipple.
17. 2" forged steel 90° Ell.
18. Cameron (or equal) threaded pressure gauge.
19. Threaded flange.
20. 2" flanged tee.
21. 2" flanged plug or gate valve.
22. 2 1/2" pipe, 300' to pit, anchored.
23. 2 1/2" SE valve.
24. 2 1/2" line to steel pit or separator.

NOTES:

- 1). Items 3, 4 and 8 may be replaced with double ram type preventer with side outlets between the rams.
- 2). The two valves next to the stack on the fill and kill line to be closed unless drill string is being pulled.
- 3). Kill line is for emergency use only. This connection shall not be used for filling.
- 4). Replacement pipe rams and blind rams shall be on location at all times.
- 5). Only type U, LSW and QRC ram type preventers with secondary seals are acceptable for 5000 psi WP and higher BOP stacks.
- 6). Type E ram-type BOP's with factory modified side outlets may be used on 3000 psi or lower WP BOP stacks.

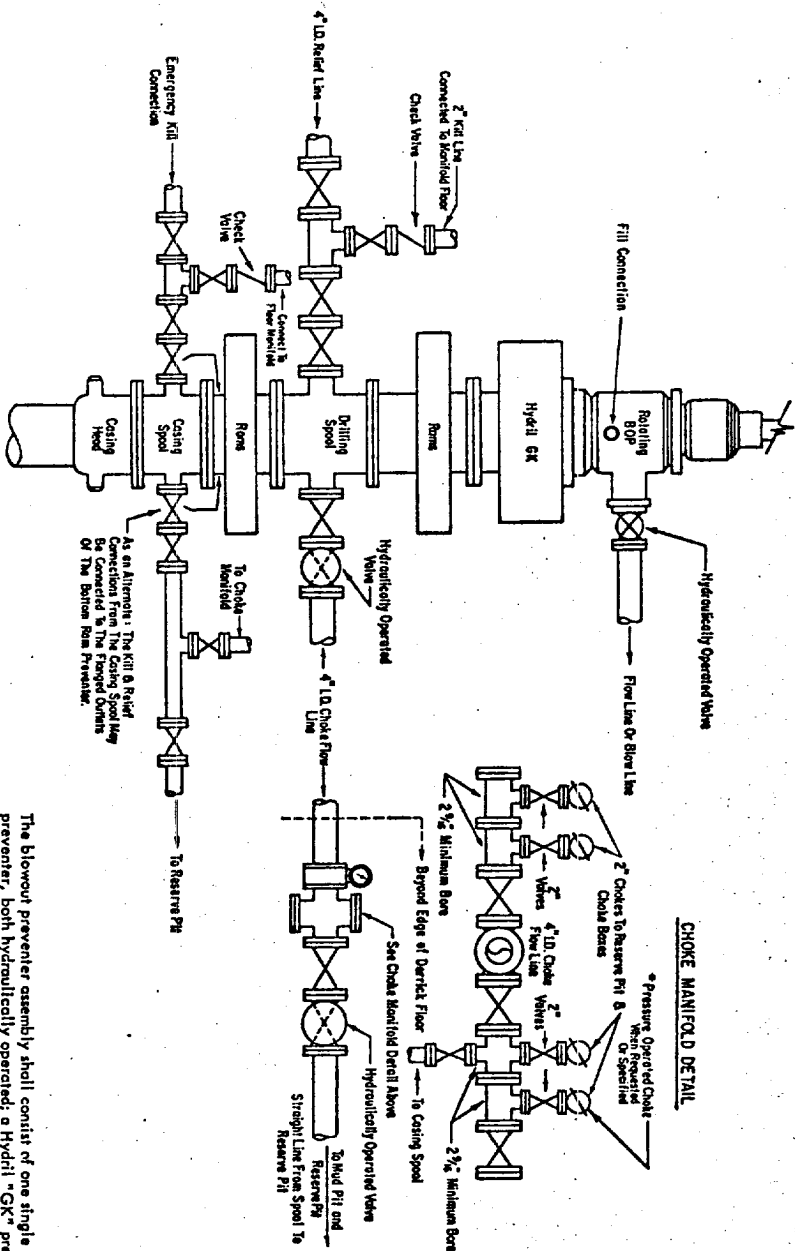

CHOKE MANIFOLD DETAIL

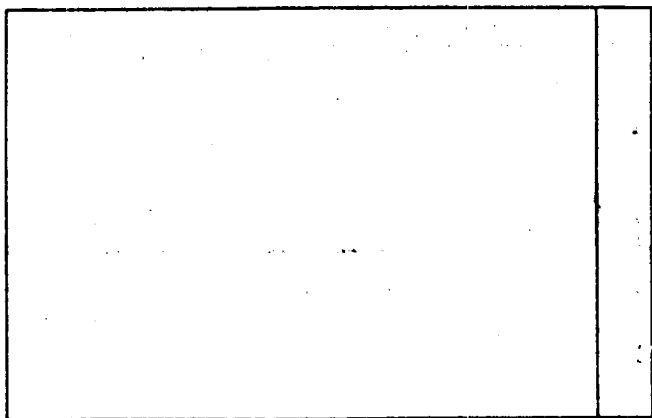

5000 # PSI WORKING PRESSURE BLOWOUT PREVENTER HOOK-UP

hydraulic operating system which is to be a closed system. (2) Accumulators with a precharge of nitrogen of not less than 750 PSI and connected so as to receive the aforementioned fluid charge. With the charging pumps shut down, the pressurized fluid volume stored in the accumulator must be sufficient to close all the pressure-operated devices simultaneously within _____ seconds, after closure, the remaining accumulator pressure shall be not less than 1000 PSI with the remaining accumulator fluid volume of at least _____ percent of the original. (3) When requested, an additional source of power, remote and equivalent, is to be available to operate the above pumps; or there shall be additional pumps operated by separate power and equal in performance capabilities.

The closing manifold and remote closing manifold shall have a separate control for each pressure-operated device. Controls are to be labeled, with control handles indicating open and closed positions. A pressure reducer and regulator must be provided for operating the Hydril preventer. When requested, a second pressure reducer shall be available to limit operating fluid pressures to ram preventers. Gulf Legion No. 38 hydraulic oil, an equivalent or better, is to be used as the fluid to operate the hydraulic equipment.

The choke manifold, choke flow line, relief line, and choke lines are to be supported by metal stands and adequately anchored. The choke flow line, relief line, and choke lines shall be constructed as straight as possible and without sharp bends. Easy and safe access is to be maintained to the choke manifold. If deemed necessary, walkways and stairways shall be erected in and around the choke manifold. All valves are to be selected for operation in the presence of oil, gas, and drilling fluids. The choke flow line valves and relief line valves connected to the drilling spool and all ram type preventers must be equipped with stem extensions, universal joints if needed, and hand wheels which are to extend beyond the edge of the derrick substructure. All other valves are to be equipped with handles.

* To include derrick floor mounted controls.

23 21 17 21 21
173

Rec.
OCT 22 '92
/6665-000