

NEW MEXICO OIL CONSERVATION COMMISSION

Well Location and Acreage Dedication Plat

HOBBS OFFICE UCC

Section A.

Date April 29, 1962

Operator Aztec Oil & Gas Company 1962 MAY 1 AM 8:48
Well No. 1 Unit Letter K Section 28 Township 15 Range 32 NMPM
Located 2310 Feet From West Line, 1650 Feet From South Line
County Lea G. L. Elevation 4297 Dedicated Acreage 80 Acres
Name of Producing Formation Wolfcamp Pool Anderson Ranch

1. Is the Operator the only owner* in the dedicated acreage outlined on the plat below?
Yes _____ No x.
2. If the answer to question one is "no," have the interests of all the owners been consolidated by communitization agreement or otherwise? Yes x No _____. If answer is "yes," Type of Consolidation Unitized.
3. If the answer to question two is "no," list all the owners and their respective interests below:

Owner

Land Description

Section B

Section 28-15S-32E

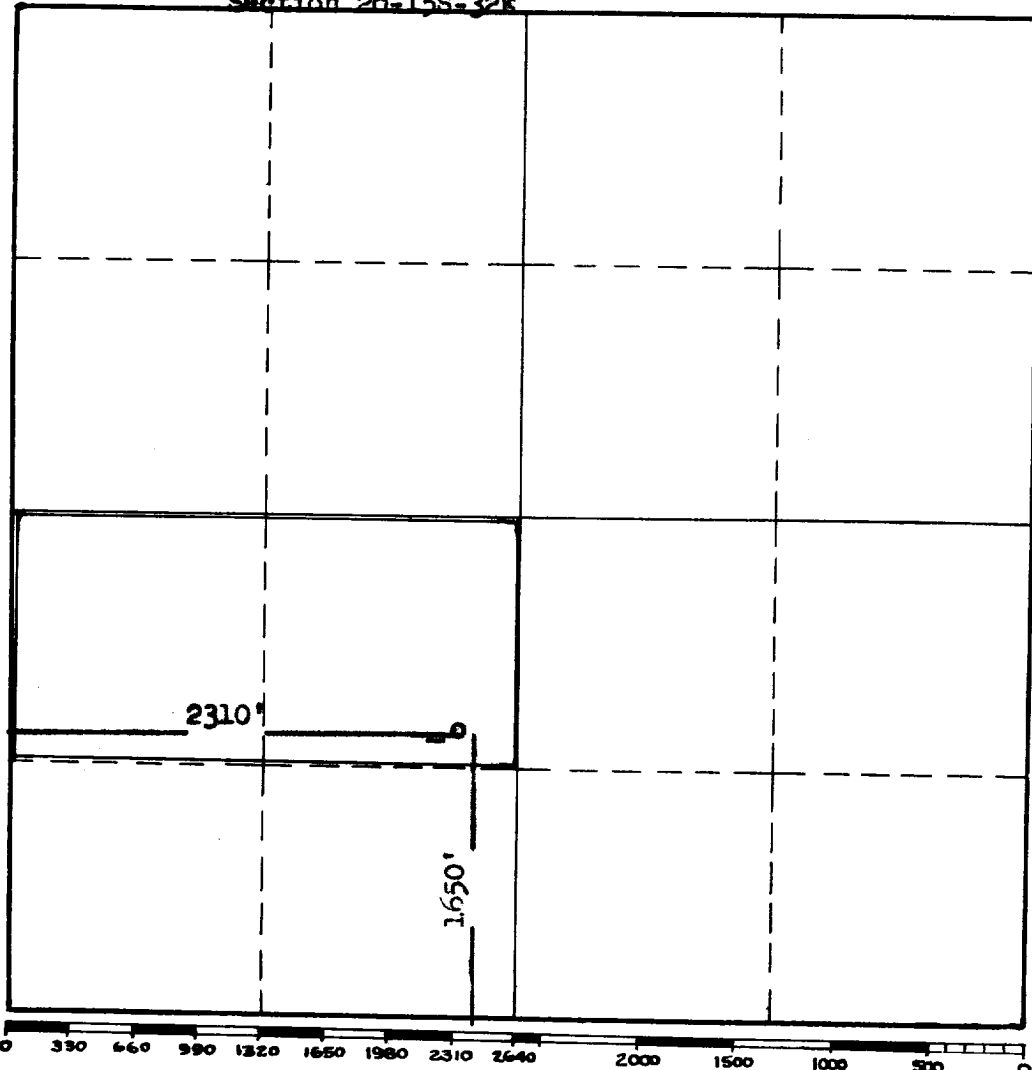

This is to certify that the information in Section A above is true and complete to the best of my knowledge and belief.

Aztec Oil & Gas Company
(Operator)

John Elliott
(Representative)

Box 347, Hobbs, New Mexico
Address

This is to certify that the well location shown on the plat in Section B was plotted from field notes of actual surveys made by me or under my supervision and that the same is true and correct to the best of my knowledge and belief.

Date Surveyed Originally by

John West
Registered Professional
Engineer and/or Land Surveyor.

Certificate No. NM-PE-L.S.-#676
the reverse side)

(See instructions for completing this form on

INSTRUCTIONS FOR COMPLETION:

1. Operator shall furnish and certify to the information called for in Section A.
2. Operator shall outline the dedicated acreage for both oil and gas wells on the plat in Section B.
3. A registered professional engineer or land surveyor registered in the State of New Mexico or approved by the Commission shall show on the plat the location of the well and certify this information in the space provided.
4. All distances shown on the plat must be from the outer boundaries of Section.
5. If additional space is needed for listing owners and their respective interests as required in question 3, Section A, please use space below

* "Owner" means the person who has the right to drill into and to produce from any pool and to appropriate the production either for himself or for himself and another. (65-3-29 (e) NMSA 1953 Comp.)

OWNO

COUNTY LEA FIELD Anderson Ranch, N. STATE NM MN 00345

OPR AZTEC OIL & GAS CO. MAP

1 State "AW" Com

Sec 28, T-15-S, R-32-E

1650' FSL, 2310' FWL of Sec CO-ORD

Re-Cmp 3-19-71		CLASS OWDF EL 43142	
CSG & SX . TUBING	FORMATION	DATUM	FORMATION
13 3/8" at 292' w/300 sx			
8 5/8" at 4050' w/800 sx			
4 1/2" at 10,000' w/400 sx.			
LOGS EL GR RA IND HC A			
	TD 10,000'; PBD 9850'		

TEMPORARILY ABANDONED

Distribution limited and publication prohibited by subscribers' agreement.
Reproduction rights reserved by Williams & Lee Scouting Service, Inc.

CONT. PROP DEPTH 9800' TYPE WO
DATE

F.R.C. 4-1-71; Opr's Elev. 4309' DF
PD 9800' WO (Wolfcamp)
(Orig. comp 4-5-62 thru (Wolfcamp) Perfs 9915-58',
OTD 10,000')

3-29-71 TD 10,000'; PBD 9850'; TEMPORARILY ABANDONED
PB to 9850'
Perf (Wolfcamp) 9563-69', 9790-96' w/4 SPF
Acid (9790-96') 1000 gals (15% NE)
Swbd 6 BF in 1 hr (95% salt wtr + 5% oil)
Acid (9563-69') 500 gals (15% NE)
Swbd 100% wtr (9763-69')

4-1-71 COMPLETION REPORTED

ANDERSON RANCH WOLFCAMP NORTH

Pool ~~(And. Ranch)~~ Anderson Ranch 2/C Operator AZTEC OIL & GAS CO.Lease State ~~NE~~ OK Well No. L Unit K S 28 T 15 R 32

DATE OF TEST	4	Daily Allowable	PRODUCED DURING TEST			Gas Oil Ratio	Packer Leakage Field
			Water Bbls.	Oil, Bbls.	Gas, MCF		
5-7-62	24	163	0	100	172.3	11158	
5-8-62	24	166	0	197	281.4	1428	
5-7-63	24	172	0	191	207.2	1085	
5-5-64	24	187	0	170	357	2100	
5-3-65	24	170	0	131	355	2710	
2-21-66	24	131	0	84	323	3845	
4-2-66	24	84	0	66	281	4258	
7-21-66	24	66	0	54	313	5796	
4-13-67	24	54	0	41	218	5317	
4-11-68	24	36	0	37	154	4162	
5-15-69	24	32	0	35	151	4321	
4-8-69	24	32	0	28	121	4356	
4-1-70	24	32	0	22	125	5681	
		S I.					

Pool	Operator
1	1
2	2
3	3
4	4
5	5
6	6
7	7
8	8
9	9
10	10
11	11
12	12
13	13
14	14
15	15
16	16
17	17
18	18
19	19
20	20
21	21
22	22
23	23
24	24
25	25
26	26
27	27
28	28
29	29
30	30
31	31
32	32
33	33
34	34
35	35
36	36
37	37
38	38
39	39
40	40
41	41
42	42
43	43
44	44
45	45
46	46
47	47
48	48
49	49
50	50
51	51
52	52
53	53
54	54
55	55
56	56
57	57
58	58
59	59
60	60
61	61
62	62
63	63
64	64
65	65
66	66
67	67
68	68
69	69
70	70
71	71
72	72
73	73
74	74
75	75
76	76
77	77
78	78
79	79
80	80
81	81
82	82
83	83
84	84
85	85
86	86
87	87
88	88
89	89
90	90
91	91
92	92
93	93
94	94
95	95
96	96
97	97
98	98
99	99
100	100

Lease _____ Well No. _____ Unit _____ S _____ T _____ R _____

[illegible]