

NEW MEXICO OIL CONSERVATION COMMISSION
WELL LOCATION AND ACREAGE DEDICATION PLAT

FORM C-128
 Revised 5/1/57

SEE INSTRUCTIONS FOR COMPLETING THIS FORM ON THE REVERSE SIDE

SECTION A

Operator Union Oil Co. of Calif.		Lease		State	Well No. 4-32
Unit Letter I	Section 32	Township 15 South	Range 32 East	County Lea	
Actual Footage Location of Well: 2310 feet from the South line and 330 feet from the East line					
Ground Level Elev. Unknown	Producing Formation Wolfcamp		Pool Anderson Ranch Wolfcamp	Dedicated Acreage: 40 Acres	

1. Is the Operator the only owner in the dedicated acreage outlined on the plat below? YES _____ NO X . ("Owner" means the person who has the right to drill into and to produce from any pool and to appropriate the production either for himself or for himself and another. (65-3-29 (e) NMSA 1935 Comp.)
2. If the answer to question one is "no," have the interests of all the owners been consolidated by communitization agreement or otherwise? YES X NO ____ . If answer is "yes," Type of Consolidation Communitization agreement
3. If the answer to question two is "no," list all the owners and their respective interests below:

Owner	Land Description

SECTION B

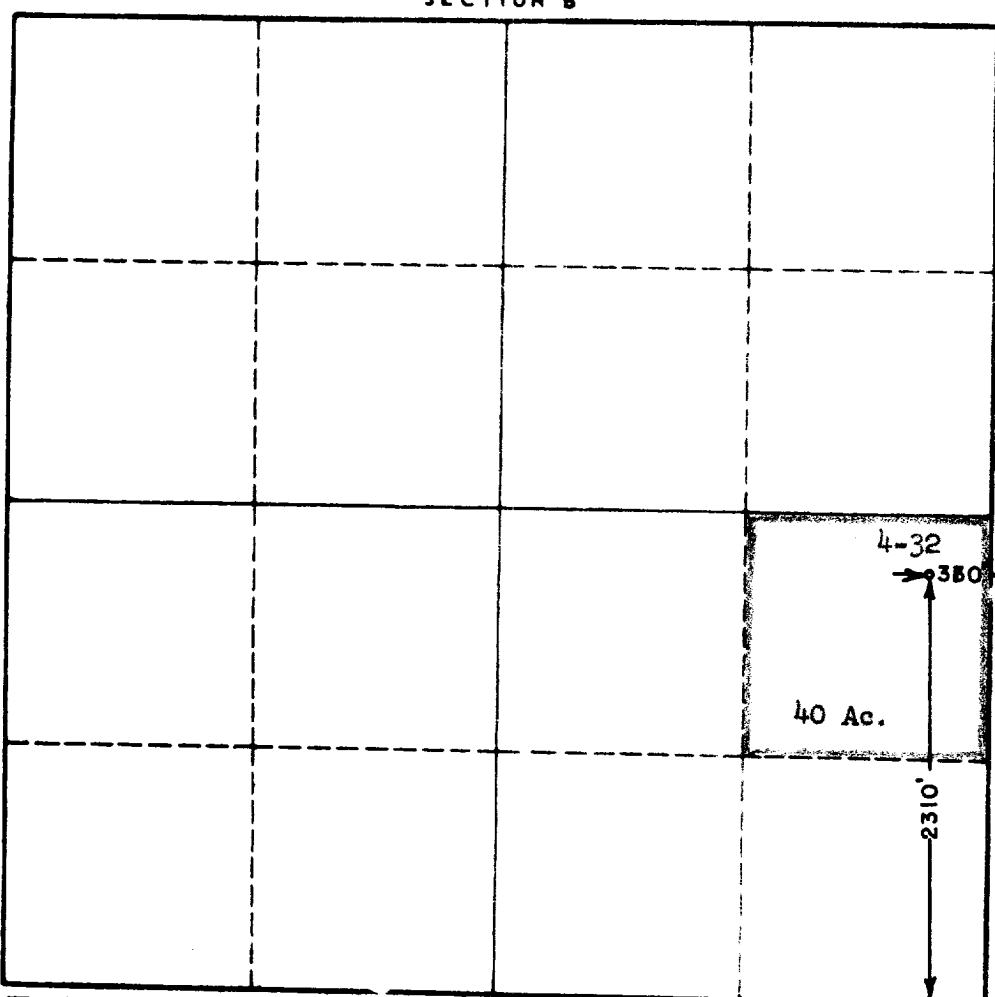

CERTIFICATION

I hereby certify that the information in SECTION A above is true and complete to the best of my knowledge and belief.

Name <i>[Signature]</i>
Position Production Clerk
Company Union Oil Co. of California
Date March 20, 1962

I hereby certify that the well location shown on this plat in SECTION B was plotted from field notes of actual surveys made by me or under my supervision, and that the same is true and correct to the best of my knowledge and belief.

Date Surveyed 3-15-62
Registered Professional Engineer and/or Land Surveyor, JOHN W. WEST
<i>[Signature]</i>
Certificate No. N.M. - P.E. & L.S. NO. 676

