

WELL LOCATION SURVEY PLAT. HOBBS OFFICE OCC

COMPANY CONTINENTAL OIL COMPANY

1954 JUN 9 AM 11:34

LEASE Anderson Ranch Unit

WELL NO. 15

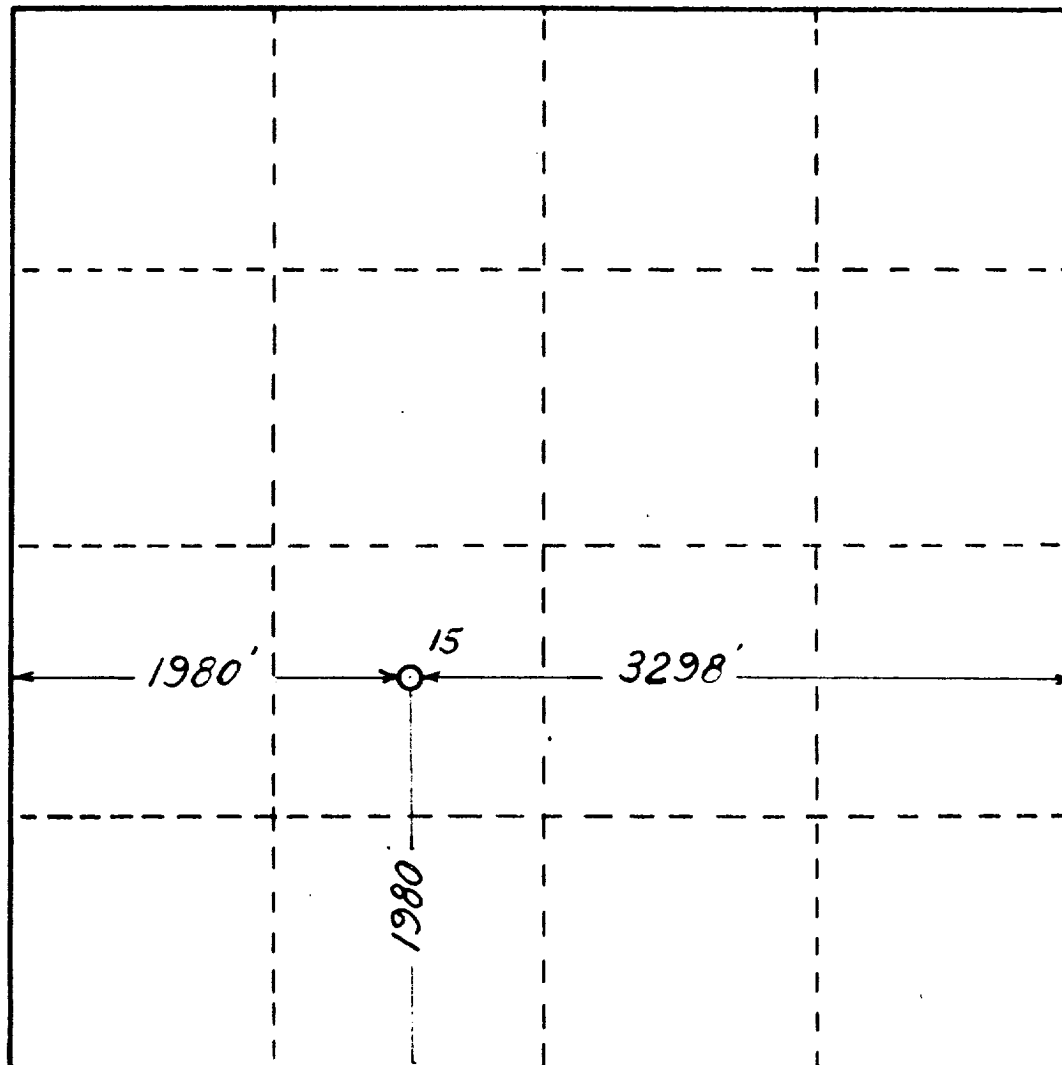

N

SEC. 2 TWP. 16 S. RGE. 32 E. N.M.P.M.

I CERTIFY THAT THIS SURVEY WAS MADE UNDER  
MY DIRECTION, AND THAT THE PLAT IS CORRECT  
TO THE BEST OF MY KNOWLEDGE.

*S. J. Stanley*

NEW MEXICO LICENSE NO. 1510