

SECTION 6 TOWNSHIP 16 RANGE 32 COUNTY Lea STATE N. M.

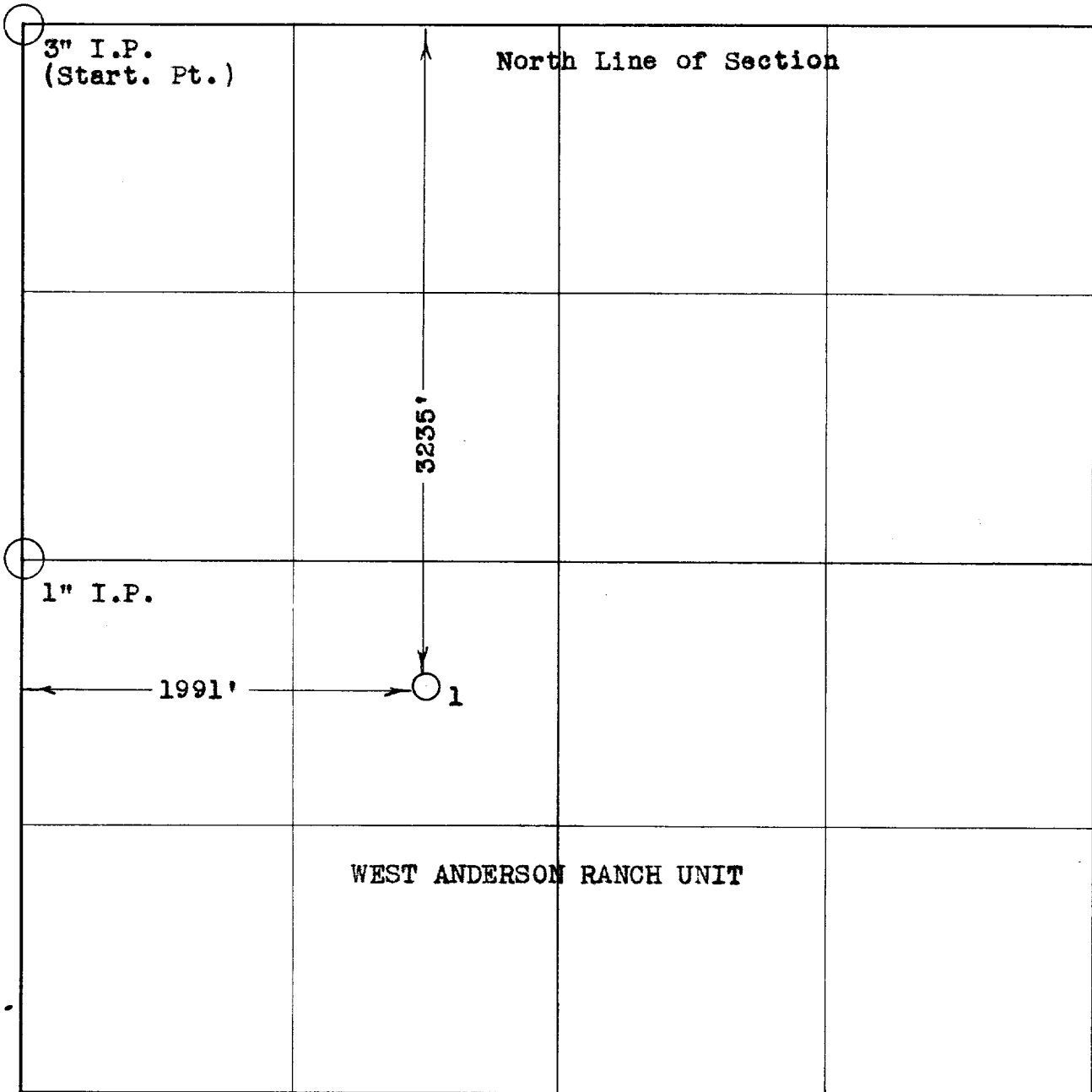

CONTINENTAL OIL COMPANY  
Well No.1, West Anderson Ranch Unit  
In Section 6-16-32,  
Lea County, New Mexico.

I, Jack B. Collins, do hereby certify that  
this location was made on the ground by me  
and is correct,

*Jack B Collins*