

UNITED STATES  
DEPARTMENT OF THE INTERIOR  
GEOLOGICAL SURVEY

## APPLICATION FOR PERMIT TO DRILL, DEEPEN, OR PLUG BACK

1a. TYPE OF WORK Re-enter abandoned &amp; plugged well

~~DRILL~~ ☒DEEPEN ☐PLUG BACK ☐

b. TYPE OF WELL

OIL  
WELL ☒GAS  
WELL ☐

OTHER

SINGLE  
ZONE ☒MULTIPLE  
ZONE ☐

2. NAME OF OPERATOR

Ryder Scott Management Company

3. ADDRESS OF OPERATOR

922 8th St., Wichita Falls, Texas

4. LOCATION OF WELL (Report location clearly and in accordance with any State requirements.\*)

At surface

Unit letter A, 650' FNL & 690' FEL,  
At proposed prod. zone Sec. 7, T 17S, R 32E

14. DISTANCE IN MILES AND DIRECTION FROM NEAREST TOWN OR POST OFFICE\*

15. DISTANCE FROM PROPOSED\*

LOCATION TO NEAREST  
PROPERTY OR LEASE LINE, FT.  
(Also to nearest drig. unit line, if any)

650'

16. NO. OF ACRES IN LEASE

40

17. NO. OF ACRES ASSIGNED  
TO THIS WELL

40

18. DISTANCE FROM PROPOSED LOCATION\*  
TO NEAREST WELL, DRILLING, COMPLETED,  
OR APPLIED FOR, ON THIS LEASE, FT.

1320

19. PROPOSED DEPTH  
3970 (old well)20. ROTARY OR CABLE TOOLS  
Rotary

21. ELEVATIONS (Show whether DF, RT, GR, etc.)

4025' G. L.

22. APPROX. DATE WORK WILL START\*

On approval

23.

## PROPOSED CASING AND CEMENTING PROGRAM

SIZE OF HOLE	SIZE OF CASING	WEIGHT PER FOOT	SETTING DEPTH	QUANTITY OF CEMENT
Abandoned in well	8-5/8"	28#	507' - 804'	
Abandoned in well	7"	20#	2137' - 3566'	
To be installed at time of Recompletion	4-1/2"	9.5#	3570'	Sufficient cement to circulate to surface.

Well to be completed as a producer &amp; pumped.

This is the former Green Bay Co., Mitchell "A" Lease, well no. 3, which was plugged  
& abandoned in 1942.

IN ABOVE SPACE DESCRIBE PROPOSED PROGRAM: If proposal is to deepen or plug back, give data on present productive zone and proposed new productive zone. If proposal is to drill or deepen directionally, give pertinent data on subsurface locations and measured and true vertical depths. Give blowout preventer program, if any.

24.

SIGNED

*E. J. Sandy*

TITLE Agent

DATE Dec. 28, 1966

(This space for Federal or State office use)

PERMIT NO. \_\_\_\_\_

APPROVAL DATE

DEC 29 1966

APPROVED BY \_\_\_\_\_

TITLE

A. H. BROWN  
DISTRICT ENGINEER

DATE

CONDITIONS OF APPROVAL, IF ANY:

NEW MEXICO OIL CONSERVATION COMMISSION  
WELL LOCATION AND ACREAGE DEDICATION PL.

Form C-102  
Supersedes C-128  
Effective 1-1-65

All distances must be from the outer boundaries of the Section.

Operator <b>Ryder Scott Management Co.</b>			Lease <b>Mitchell</b>		Well No. <b>3-2</b>
Unit Letter <b>A</b>	Section <b>7</b>	Township <b>T-17-S</b>	Range <b>R-32-E</b>	County <b>Los</b>	
Actual Footage Location of Well: <b>650</b> feet from the <b>North</b> line and <b>690</b> feet from the <b>East</b> line					
Ground Level Elev. <b>4025</b>	Producing Formation		Pool	Dedicated Acreage: <b>40</b> Acres	

1. Outline the acreage dedicated to the subject well by colored pencil or hachure marks on the plat below.
2. If more than one lease is dedicated to the well, outline each and identify the ownership thereof (both as to working interest and royalty).
3. If more than one lease of different ownership is dedicated to the well, have the interests of all owners been consolidated by communitization, unitization, force-pooling, etc?

☐ Yes ☐ No If answer is "yes," type of consolidation \_\_\_\_\_

If answer is "no," list the owners and tract descriptions which have actually been consolidated. (Use reverse side of this form if necessary.) \_\_\_\_\_

No allowable will be assigned to the well until all interests have been consolidated (by communitization, unitization, forced-pooling, or otherwise) or until a non-standard unit, eliminating such interests, has been approved by the Commission.

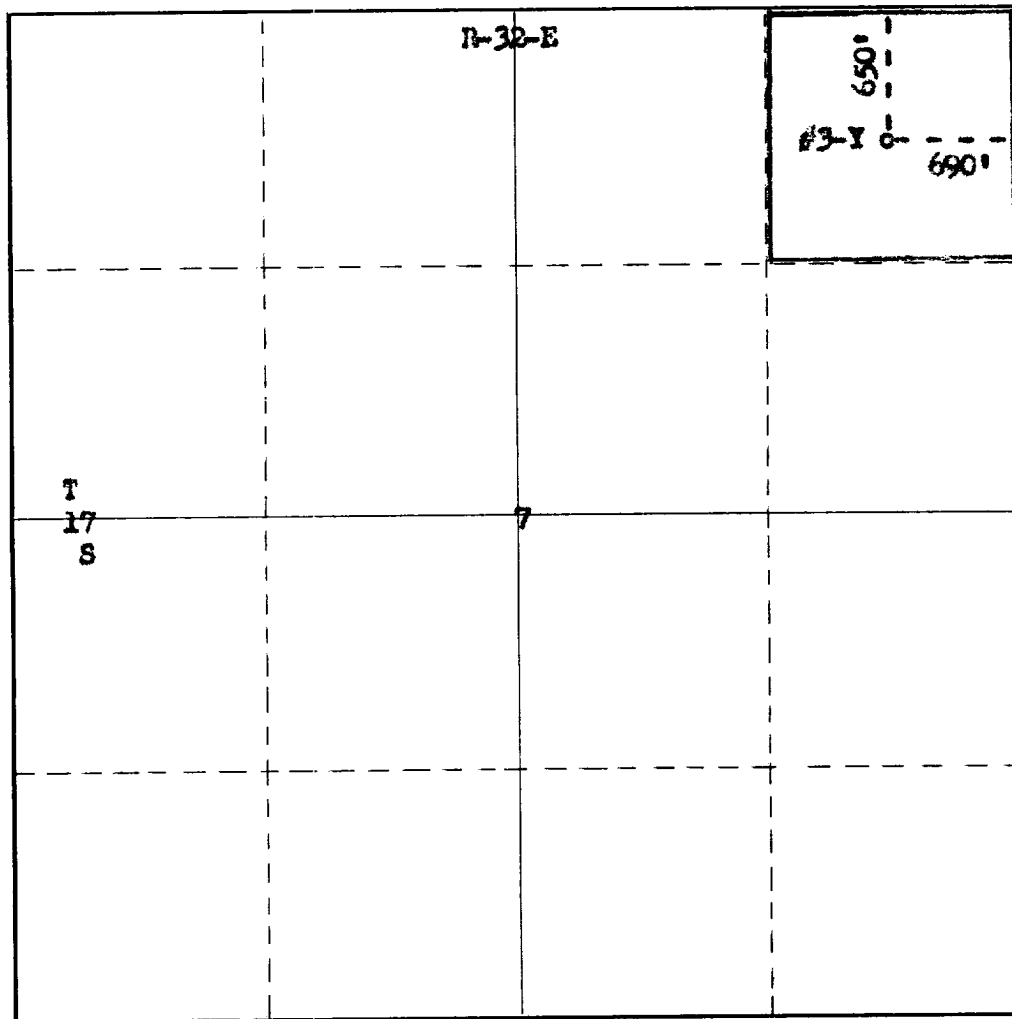

CERTIFICATION

I hereby certify that the information contained herein is true and complete to the best of my knowledge and belief.

Name *John N. Moffat*  
Position *Prod. Supv.*

Company  
**Ryder Scott Management Co.**  
Date  
**December 13, 1966**

I hereby certify that the well location shown on this plat was plotted from field notes of actual surveys made by me or under my supervision, and that the same is true and correct to the best of my knowledge and belief.

Date Surveyed  
**December 13, 1966**  
Registered Professional Engineer  
and/or Land Surveyor

*James H. L... ..*  
Certificate No.

542