

(SUBMIT IN TRIPLICATE)

Land Office Las CrucesLease No. 061842Unit LeaseUNITED STATES
DEPARTMENT OF THE INTERIOR
GEOLOGICAL SURVEY

RECEIVED

DEC 11 1961

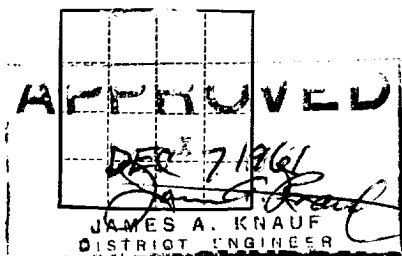

SUNDRY NOTICES AND REPORTS ON WELLS. C. C.

ARTESIA, OFFICE

NOTICE OF INTENTION TO DRILL.....	<input checked="" type="checkbox"/>	SUBSEQUENT REPORT OF WATER SHUT-OFF.....	
NOTICE OF INTENTION TO CHANGE PLANS.....		SUBSEQUENT REPORT OF SHOOTING OR ACIDIZING.....	
NOTICE OF INTENTION TO TEST WATER SHUT-OFF.....		SUBSEQUENT REPORT OF ALTERING CASING.....	
NOTICE OF INTENTION TO RE-DRILL OR REPAIR WELL.....		SUBSEQUENT REPORT OF RE-DRILLING OR REPAIR.....	
NOTICE OF INTENTION TO SHOOT OR ACIDIZE.....		SUBSEQUENT REPORT OF ABANDONMENT.....	
NOTICE OF INTENTION TO PULL OR ALTER CASING.....		SUPPLEMENTARY WELL HISTORY.....	
NOTICE OF INTENTION TO ABANDON WELL.....			

(INDICATE ABOVE BY CHECK MARK NATURE OF REPORT, NOTICE, OR OTHER DATA)

Miller 32

January 5, 1961

Well No. 6 is located 1900 ft. from NP line and 1900 ft. from E line of sec. 14N4 1/4 Sec. 14 17-5 32-E N 41
(1/4 Sec. and Sec. No.) (Twp.) (Range) (Meridian)Malheur Lea New Mexico
(Field) (County or Subdivision) (State or Territory)

The elevation of the derrick floor above sea level is _____ ft.

DETAILS OF WORK

(State names of and expected depths to objective sands; show sizes, weights, and lengths of proposed casings; indicate mudding jobs, cementing points, and all other important proposed work)

It is our intention to drill a well at the above location to a total depth of approximately 4300'. All casing points will be cemented in accordance with approved methods of the U. S. G. S. and any other special requirements will be complied with.

It is planned to use the following casing pattern: 9 7/8" hole to be drld, 7 5/8" OD 24 1/2' S-40 Casing to be set at approximately 1050' and cemented with 450 sacks, cut to be circulated. 6 3/4" hole to be drld, 4 1/2" OD 9.50# J-55 casing to be set at approximately 4050' and cemented with 200 sacks. It is calculated the cement behind the 4 1/2" casing will return to 2050'

Approval to produce this well upon completion is also requested.

RECEIVED

DEC 7 1961

I understand that this plan of work must receive approval in writing by the Geological Survey before operation. U. S. GEOLOGICAL SURVEY

Company Continental Oil CompanyAddress Howley BuildingArtesia, New Mexico

By _____

Title District Superintendent

ARTESIA, NEW MEXICO

NEW MEXICO OIL CONSERVATION COMMISSION
WELL LOCATION AND ACREAGE DEDICATION PLAT

FORM C-128
Revised 5/1/57

SEE INSTRUCTIONS FOR COMPLETING THIS FORM ON THE REVERSE SIDE

SECTION A

Operator Continental Oil Company		Lease Federal (Miller 19)		Well No. 6
Unit Letter C	Section 1	Township 7-17-8	Range 5-12-8	County ARIZ
Actual Footage Location of Well: 275 feet from the 1/4 line and 2000 feet from the 1/4 line				
Ground Level Elev. 4050	Producing Formation Grayburg San Andres		Pool Maljamar	Dedicated Acreage: 10 Acres

1. Is the Operator the only owner in the dedicated acreage outlined on the plat below? YES ☒ NO ____ ("Owner" means the person who has the right to drill into and to produce from any pool and to appropriate the production either for himself or for himself and another. (65-3-29 (e) NMSA 1935 Comp.)
2. If the answer to question one is "no," have the interests of all the owners been consolidated by communitization agreement or otherwise? YES ____ NO ____ . If answer is "yes," Type of Consolidation ____
3. If the answer to question two is "no," list all the owners and their respective interests below:

RECEIVED

Owner	Land Description

DEC 7 1961

U. S. GEOLOGICAL SURVEY
ARTESIA, NEW MEXICO

SECTION B

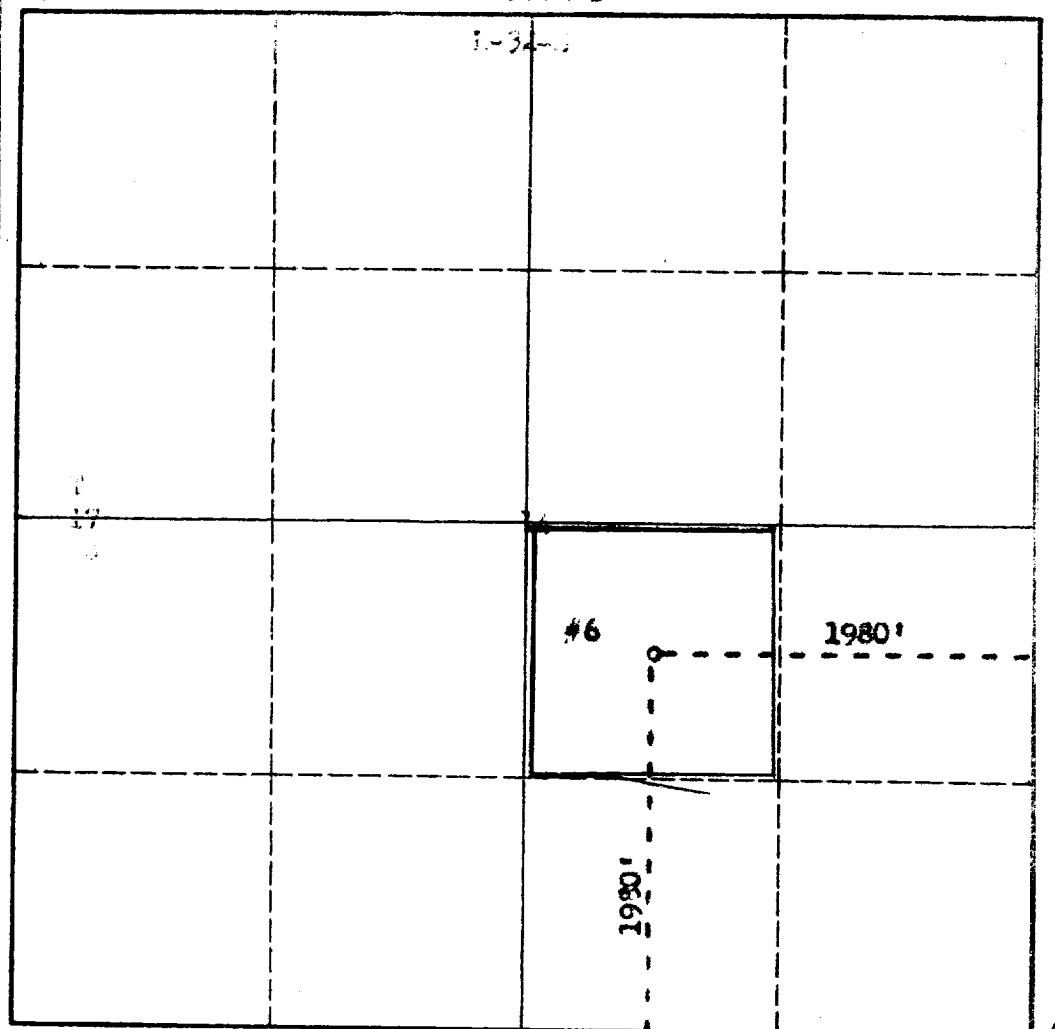

CERTIFICATION

I hereby certify that the information in SECTION A above is true and complete to the best of my knowledge and belief.

Name

Position

District Superintendent

Company

Continental Oil Company

Date

12-6-61

I hereby certify that the well location shown on the plat in SECTION B was plotted from field notes of actual surveys made by me or under my supervision, and that the same is true and correct to the best of my knowledge and belief.

Date Surveyed

December 1, 1961

Registered Professional Engineer
and/or Land Surveyor

Certificate No.

John J. Hewitt

0 330 660 990 1320 1650 1980 2310 2640 2000 1500 1000 500 0

INSTRUCTIONS FOR COMPLETION OF FORM C-128

1. Operator shall furnish and certify to the information called for in Section A.
2. Operator shall outline the dedicated acreage for *both* oil and gas wells on the plat in Section B.
3. A registered professional engineer or land surveyor registered in the State of New Mexico or approved by the Commission shall show on the plat the location of the well and certify this information in the space provided.
4. All distances shown on the plat must be from the outer boundaries of the Section.
5. If additional space is needed for listing owners and their respective interests as required in question 3 of Section A, please use space below.