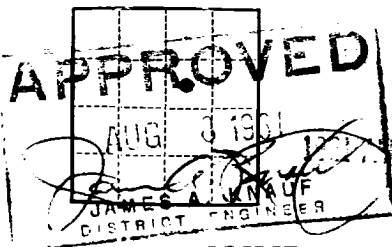

(SUBMIT IN TRIPLICATE)

Land Office **LAS CRUCES**Lease No. **000076**Unit **6**UNITED STATES  
DEPARTMENT OF THE INTERIOR  
GEOLOGICAL SURVEY

RECEIVED

AUG 11 1961

## SUNDRY NOTICES AND REPORTS ON WELLS

NOTICE OF INTENTION TO DRILL	<input checked="" type="checkbox"/>	SUBSEQUENT REPORT OF WATER SHUT-OFF	
NOTICE OF INTENTION TO CHANGE PLANS		SUBSEQUENT REPORT OF SHOOTING OR ACIDIZING	
NOTICE OF INTENTION TO TEST WATER SHUT-OFF		SUBSEQUENT REPORT OF ALTERING CASING	
NOTICE OF INTENTION TO RE-DRILL OR REPAIR WELL		SUBSEQUENT REPORT OF RE-DRILLING OR REPAIR	
NOTICE OF INTENTION TO SHOOT OR ACIDIZE		SUBSEQUENT REPORT OF ABANDONMENT	
NOTICE OF INTENTION TO PULL OR ALTER CASING		SUPPLEMENTARY WELL HISTORY	
NOTICE OF INTENTION TO ABANDON WELL			

(INDICATE ABOVE BY CHECK MARK NATURE OF REPORT, NOTICE, OR OTHER DATA)

0-7-1961, 19

Well No. **25** is located **2519** ft. from **N** line and **1980** ft. from **E** line of sec. **18**

<b>SW 1/4</b>	<b>17</b>	<b>32</b>	<b>2E</b>	<b>6</b>
(1/4 Sec. and Sec. No.)	(Twp.)	(Range)	(Meridian)	
<b>MALJANAR</b>	<b>LEA</b>	<b>NEW MEXICO</b>		
(Field)	(County or Subdivision)	(State or Territory)		

The elevation of the ~~surface~~ **GROUND** above sea level is **4044.3** ft.

## DETAILS OF WORK

(State names of and expected depths to objective sands; show sizes, weights, and lengths of proposed casings; indicate mud logs, core logs, and all other important proposed work)

**12 1/2" HOLE 8 5/8" CASIN 300' CIRCULATE CEMENT****7 7/8" HOLE 5 1/2" CASIN 4000' CEMENT WITH 350 SACS CEMENT****DRILL WITH ROTARY TOOLS TOP TO BOTTOM****CONTRACTOR EUEL DRILLING COMPANY**AUG 8 1961  
U. S. GEOLOGICAL SURVEY  
ARTESIA, NEW MEXICO

I understand that this plan of work must receive approval in writing by the Geological Survey before operations may be commenced.

Company **BOLLER & NICHOLS**Address **MALJANAR****NEW MEXICO**By **O. L. McCUTCHEN**Title **SEPT.**

NEW MEXICO OIL CONSERVATION COMMISSION RE  
WELL LOCATION AND ACREAGE DEDICATION PLAT

FORM C-128  
Revised 5/1/57

AUG 11 1961

SEE INSTRUCTIONS FOR COMPLETING THIS FORM ON THE REVERSE SIDE

SECTION A

Operator **Boller and Nichols**

**N. C. C.**  
**ARTESIAN OFFICE**  
**Well No.**

2.5

Unit Letter	Section	Township	Range	County
G	15	17 South	32 East	Lea

Actual Footage Location of Well:		2310		feet from the		north		line and		1980		feet from the		east		line	
----------------------------------	--	------	--	---------------	--	-------	--	----------	--	------	--	---------------	--	------	--	------	--

Ground Level Elev. 4044.9	Producing Formation GRANITE	Pool NATURAL	Dedicated Acreage: Acre
------------------------------	--------------------------------	-----------------	----------------------------

1. Is the Operator the only owner in the dedicated acreage outlined on the plat below? YES ☒ NO ☐ . ("Owner" means the person who has the right to drill into and to produce from any pool and to appropriate the production either for himself or for himself and another. (65-3-29 (e) NMSA 1935 Comp.)
2. If the answer to question one is "no," have the interests of all the owners been consolidated by communitization agreement or otherwise? YES ☐ NO ☐ . If answer is "yes," Type of Consolidation \_\_\_\_\_
3. If the answer to question two is "no," list all the owners and their respective interests below: \_\_\_\_\_

Owner	Land Description
-------	------------------

AUG 8 1961

U. S. GEOLOGICAL SURVEY  
ARTESIA, NEW MEXICO

## SECTION 6

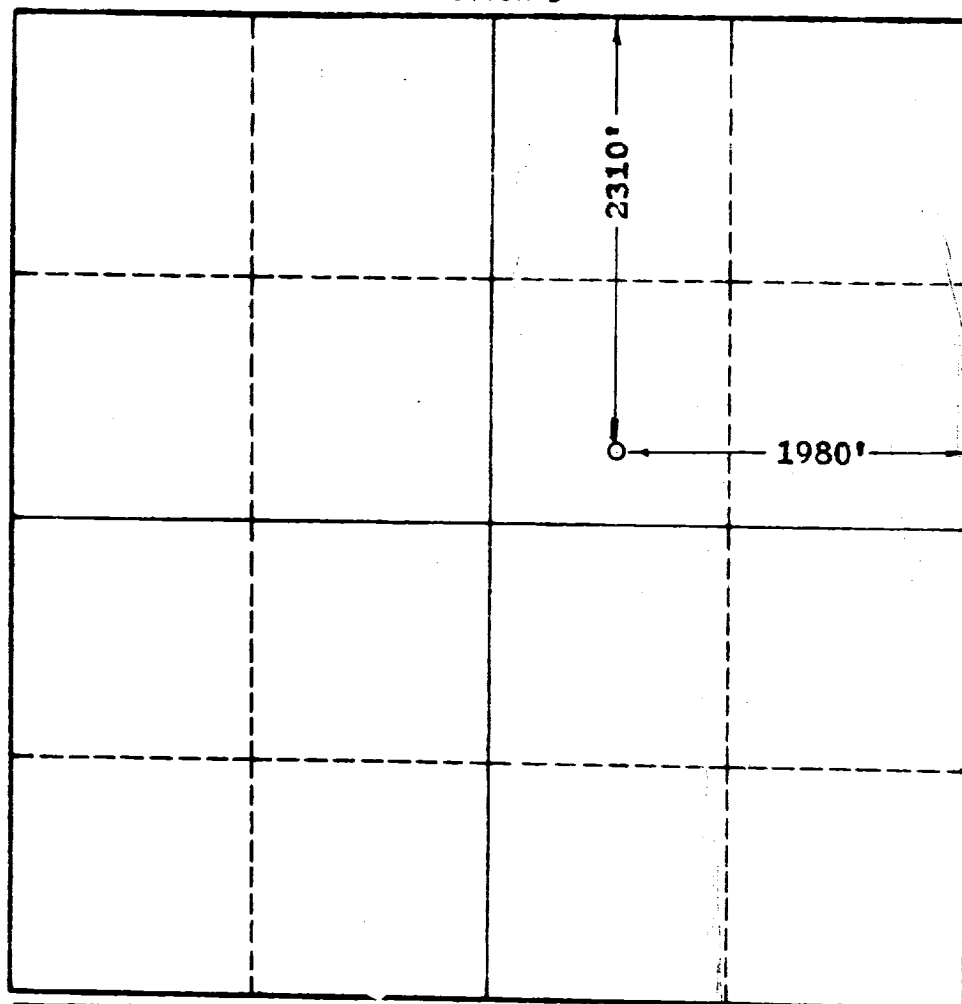

### CERTIFICATION

I hereby certify that the information in SECTION A above is true and complete to the best of my knowledge and belief.

Name \_\_\_\_\_

Position

Company

**Dr.**

I hereby certify that the well location shown on the plat in SECTION B was plotted from field notes of actual surveys made by me or under my supervision, and that the same is true and correct to the best of my knowledge and belief.

Date Surveyed:

Registered Professional Engineer

and the Land Surveyor, JOHN W. WEST

**Certificate No**

W. M. F. E. O. L. S. NO. 670