

**NEW MEXICO OIL CONSERVATION COMMISSION  
WELL LOCATION AND ACREAGE DEDICATION PLAT**

Form C-102  
Supersedes C-128  
Effective 1-1-65

All distances must be from the outer boundaries of the Section.

Operator <b>Continental Oil Company</b>			Lease <b>State #</b>		Well No. <b>2</b>
Unit Letter <b>G</b>	Section <b>16</b>	Township <b>17</b>	Range <b>32</b>	County <b>Lea</b>	
Actual Footage Location of Well:					
<b>1650</b> feet from the <b>North</b> line and		<b>1650</b> feet from the <b>East</b> line			
Ground Level Elev: <b>4062</b>	Producing Formation	Pool <b>Maljamar Queen Gas</b>	Dedicated Acreage: <b>160</b> Acres		

1. Outline the acreage dedicated to the subject well by colored pencil or hachure marks on the plat below.
2. If more than one lease is dedicated to the well, outline each and identify the ownership thereof (both as to working interest and royalty).
3. If more than one lease of different ownership is dedicated to the well, have the interests of all owners been consolidated by communitization, unitization, force-pooling, etc?

☐ Yes    ☐ No    If answer is "yes," type of consolidation \_\_\_\_\_

If answer is "no," list the owners and tract descriptions which have actually been consolidated. (Use reverse side of this form if necessary.) \_\_\_\_\_

No allowable will be assigned to the well until all interests have been consolidated (by communitization, unitization, forced-pooling, or otherwise) or until a non-standard unit, eliminating such interests, has been approved by the Commission.

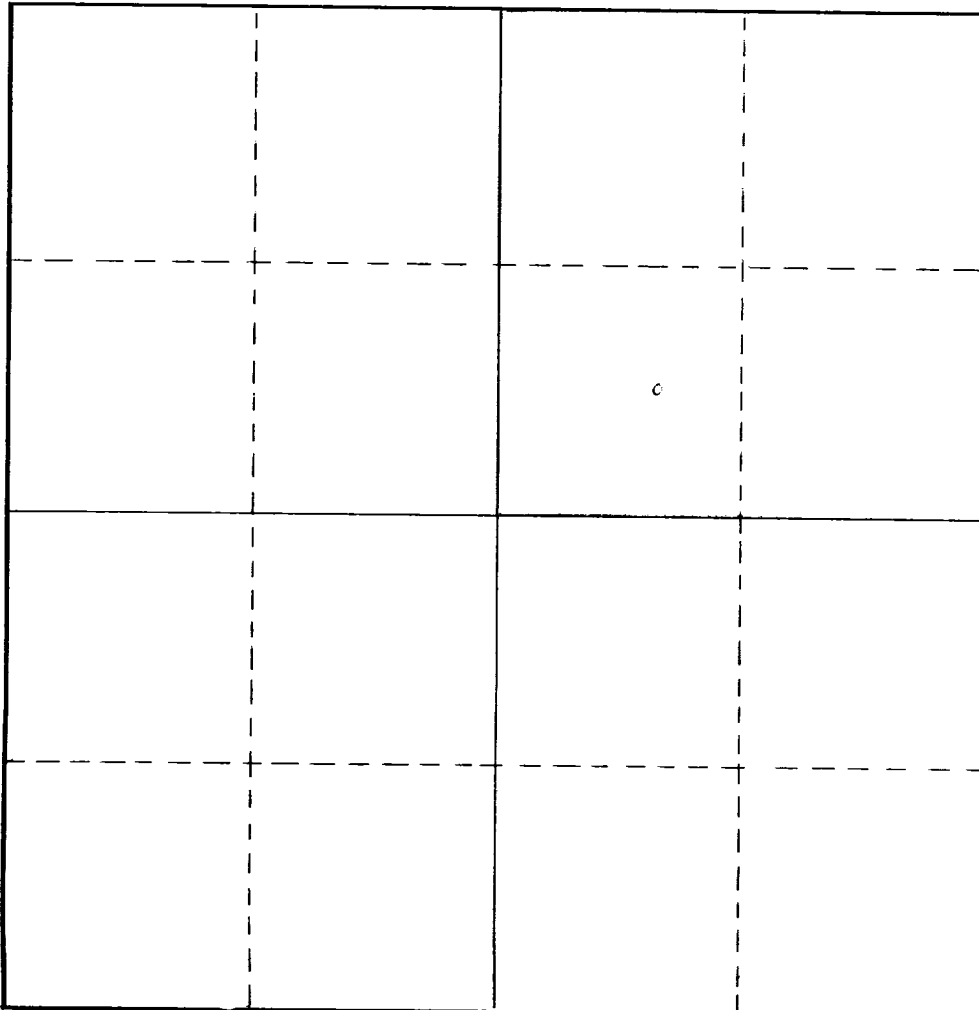

**CERTIFICATION**

*I hereby certify that the information contained herein is true and complete to the best of my knowledge and belief.*

**H. A. Ingram**  
Name  
**Admin. Section Chief**  
Position  
**Continental Oil Co.**  
Company  
**February 13, 1970**  
Date

*I hereby certify that the well location shown on this plat was plotted from field notes of actual surveys made by me or under my supervision, and that the same is true and correct to the best of my knowledge and belief.*

Date Surveyed

Registered Professional Engineer  
and/or Land Surveyor

Certificate No.

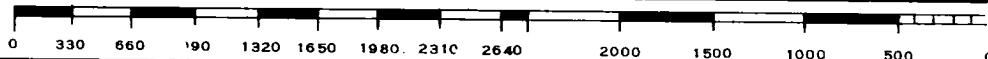

NEW MEXICO  
OIL CONSERVATION COMMISSION

SUPPLEMENT TO  
FORM C-128 Filed  
June 29, 1956  
Form C-128

Well Location and/or Gas Proration Plat  
HOBBS OFFICE CCC

Date \_\_\_\_\_

Operator Buffalo Oil Company Lease \_\_\_\_\_ State "B"

Well No. 2 Section 16 Township 17S Range 32E NMPM

Located 1650 Feet From N. Line, 1650 Feet From E. Line,

Lea County, New Mexico. G. L. Elevation \_\_\_\_\_

Name of Producing Formation Queen Pool Undesignated Dedicated Acreage 160

(Note: All distances must be from outer boundaries of Section)

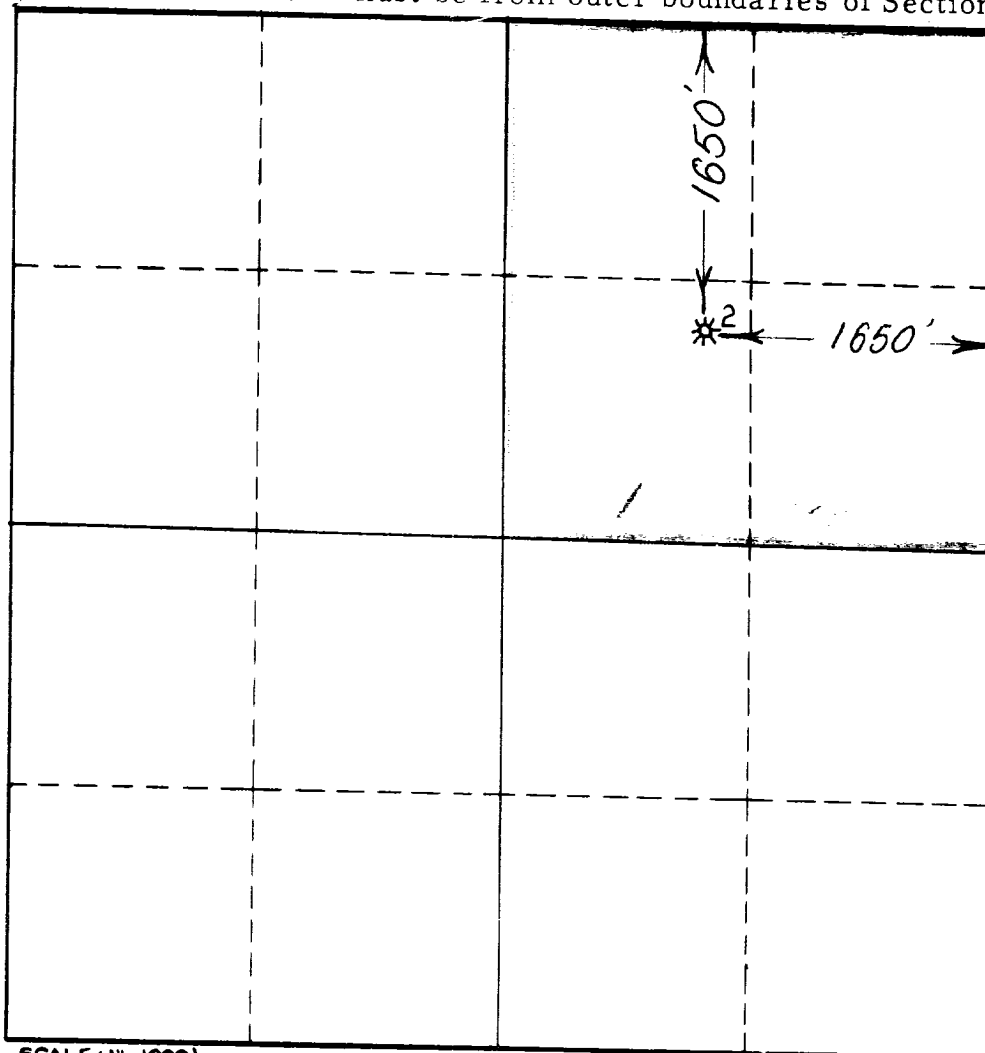

SCALE: 1" = 1000'

1. Is this Well a Dual Comp.? Yes    No X
2. If the answer to Question 1 is yes, are there any other dually completed wells within the dedicated acreage? Yes    No

This is to certify that the above plat was prepared from field notes of actual surveys made by me or under my supervision and that the same are true and correct to the best of my knowledge and belief.

Name Max E. Curry  
Position District Superintendent  
Representing Buffalo Oil Company  
Address 203 Carper Bldg., Artesia, N. M.

Date Surveyed June 29, 1956  
See other Plat submitted  
Registered Professional Engineer and/or  
Land Surveyor