

(SUBMIT IN TRIPLICATE)

UNITED STATES
DEPARTMENT OF THE INTERIOR
GEOLOGICAL SURVEY

Land Office Las Cruces

Lease No. 029405-n

Unit B

SUNDRY NOTICES AND REPORTS ON WELLS

| | | | |
|---|-------------------------------------|---|--|
| NOTICE OF INTENTION TO DRILL..... | <input checked="" type="checkbox"/> | SUBSEQUENT REPORT OF WATER SHUT-OFF..... | |
| NOTICE OF INTENTION TO CHANGE PLANS..... | | SUBSEQUENT REPORT OF SHOOTING OR ACIDIZING..... | |
| NOTICE OF INTENTION TO TEST WATER SHUT-OFF..... | | SUBSEQUENT REPORT OF ALTERING CASING..... | |
| NOTICE OF INTENTION TO RE-DRILL OR REPAIR WELL..... | | SUBSEQUENT REPORT OF REDRILLING OR REPAIR..... | |
| NOTICE OF INTENTION TO SHOOT OR ACIDIZE..... | | SUBSEQUENT REPORT OF ABANDONMENT..... | |
| NOTICE OF INTENTION TO PULL OR ALTER CASING..... | | SUPPLEMENTARY WELL HISTORY..... | |
| NOTICE OF INTENTION TO ABANDON WELL..... | | | |

(INDICATE ABOVE BY CHECK MARK NATURE OF REPORT, NOTICE, OR OTHER DATA)

Mr. Mitchell B

Artesia, New Mexico, Aug. 22, 1950

Well No. 24-P is located 660 ft. from N line and 1780 ft. from W line of sec. 17
SE 1/4 Sec. 17 17S 12E HIGH
(1/4 Sec. and Sec. No.) (Twp.) (Range) (Meridian)
Haljazar-Paddock Lea New Mexico
(Field) (County or Subdivision) (State or Territory)

The elevation of the derrick floor above sea level is _____ ft.

DETAILS OF WORK

(State names of and expected depths to objective sands; show sizes, weights, and lengths of proposed casings; indicate mudding jobs, cementing points, and all other important proposed work)

This well will be drilled with rotary tools to a depth sufficient to test the Paddock zone, estimated at 5400'.

Approximately 60' of 13-3/8" OD Armer casing will be set as conductor string and cemented to the surface.

An intermediate string of 8-5/8" OD casing will be set through the salt to approximately 2500'. This will be cemented in two stages, using enough cement on the first stage to come above the Base of Salt, estimated at 20 sacks; the second stage tool will be placed at the Top of the Salt and enough cement used to come approximately 300' above the salt, estimated at 100 sacks.

In the event commercial production is found in the Paddock zone 5-1/2" OD casing will be cemented with enough cement to come approximately 500' above the Haljazar producing zone.

I understand that this plan of work must receive approval in writing by the Geological Survey before operations may be commenced.

Company BUFFALO OIL COMPANY

Address 203 GARDEN BLDG.

ARTESIA, NEW MEXICO

By

Title Vice President

Company Buffalo Oil Company

Lease Wm. Mitchell B Well No. 24 P

Sec. 17 T. 17 S., R. 32 E., N.M.P.M.

Location 660' from south and 1780' from west lines

County Lea New Mexico

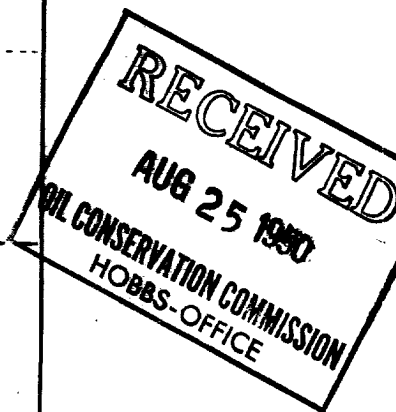
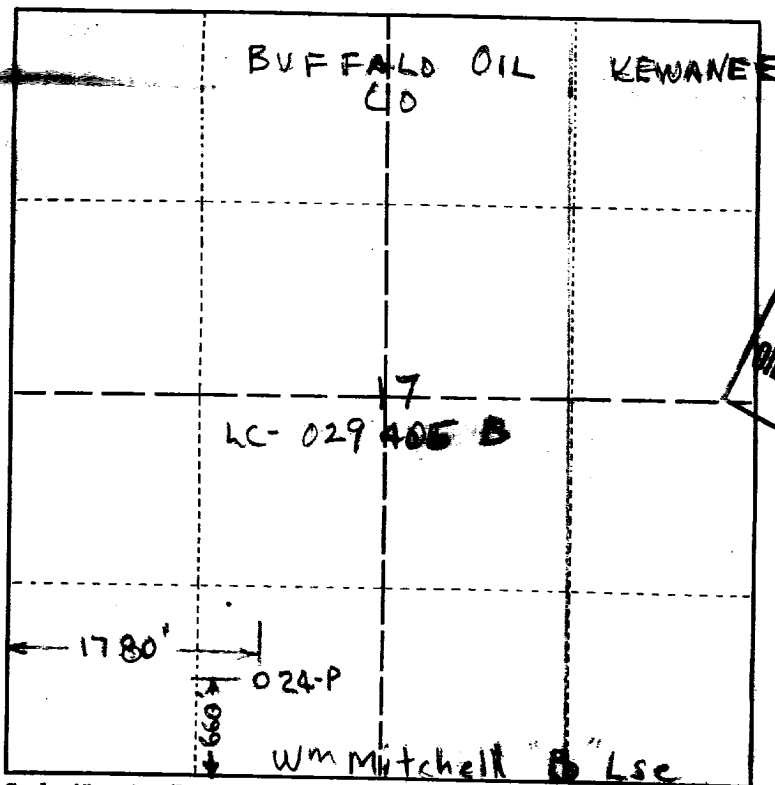

This is to certify that the above plat was prepared from field notes of actual surveys made by me or under my supervision and that the same are true and correct to the best of my knowledge and belief.

Seal:
Artesia, New Mexico

Ralph L Gray
Registered Professional
Engineer and Land Surveyor.

Surveyed Aug. 21, 1950

14982 Advocate Print