

(SUBMIT IN TRIPLICATE)

UNITED STATES  
DEPARTMENT OF THE INTERIOR  
GEOLOGICAL SURVEY

Land Office Las Cruces  
Lease No. 022405 (b)  
Unit FIVED

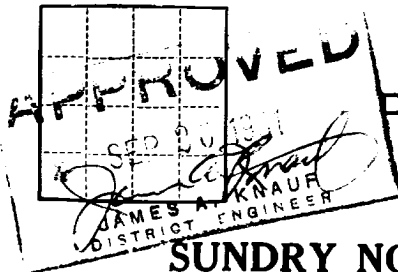

SEP 20 1961  
U.S.G.S. OFFICE

SUNDRY NOTICES AND REPORTS ON WELLS

NOTICE OF INTENTION TO DRILL.....	SUBSEQUENT REPORT OF WATER SHUT-OFF.....
NOTICE OF INTENTION TO CHANGE PLANS.....	SUBSEQUENT REPORT OF SHOOTING OR ACIDIZING.....
NOTICE OF INTENTION TO TEST WATER SHUT-OFF.....	SUBSEQUENT REPORT OF ALTERING CASING.....
NOTICE OF INTENTION TO RE-DRILL OR REPAIR WELL.....	SUBSEQUENT REPORT OF RE-DRILLING OR REPAIR.....
NOTICE OF INTENTION TO SHOOT OR ACIDIZE.....	SUBSEQUENT REPORT OF ABANDONMENT.....
NOTICE OF INTENTION TO PULL OR ALTER CASING.....	SUPPLEMENTARY WELL HISTORY.....
NOTICE OF INTENTION TO ABANDON WELL.....	

(INDICATE ABOVE BY CHECK MARK NATURE OF REPORT, NOTICE, OR OTHER DATA)

W. Mitchell

September 25

19 61

Well No. 43 is located 660 ft. from N line and 140 ft. from W line of sec. 17

15/4 SW/4 Sec. 17 (1/4 Sec. and Sec. No.) 17-1 (Twp.) 32-1 (Range) N19E (Meridian)  
Valjean-Paddock (Field) Los (County or Subdivision) New Mexico (State or Territory)

The elevation of the derrick floor above sea level is \_\_\_\_\_ ft.

DETAILS OF WORK

(State names of and expected depths to objective sands; show sizes, weights, and lengths of proposed casings; indicate mudding jobs, cementing points, and all other important proposed work)

It is our intention to drill a well with rotary tools at the above location to a total depth of approximately 1400'. All casing points will be cemented in accordance with approved methods of the U.S.G.S. and any other special requirements will be complied with. It is planned to use the following casing pattern: 11" hole to be drilled, 7 5/8" OD Casing to be set at approximately 750' and cemented with 250 sacks cement to be circulated. 6 7/8" hole to be drilled, 4 1/2" ID casing to be set at approximately 1400' and cemented with 250 sacks. It is calculated that the cement behind the 4 1/2" casing will return to 2500'.

Approval to produce this well upon completion is also requested.

I understand that this plan of work must receive approval in writing by the Geological Survey before operations may be commenced.

Company Continental Oil Company  
Address Rowley Building,  
Artesia, New Mexico

By \_\_\_\_\_

Title District Superintendent

Copies to: LOGS 401 File

**NEW MEXICO OIL CONSERVATION COMMISSION**  
**WELL LOCATION AND ACREAGE DEDICATION PLAT**

FORM C-128  
 Revised 5/1/57

**SEE INSTRUCTIONS FOR COMPLETING THIS FORM ON THE REVERSE SIDE**

**SECTION A**

Operator <b>Continental Oil Company</b>			Lease <b>Mitchell</b>		Well No. <b>43</b>
Unit Letter <b>M</b>	Section <b>17</b>	Township <b>17 South</b>	Range <b>32 East</b>	County <b>Lea</b>	
Actual Footage Location of Well: <b>660</b> feet from the <b>South</b> line and <b>460</b> feet from the <b>West</b> line					
Ground Level Elev. <b>3983</b>	Producing Formation <b>Paddock</b>		Pool <b>Maljamar - Paddock</b>		Dedicated Acreage: <b>40</b> Acres

1. Is the Operator the only owner in the dedicated acreage outlined on the plat below? YES ☒ NO \_\_\_\_ . ("Owner" means the person who has the right to drill into and to produce from any pool and to appropriate the production either for himself or for himself and another. (65-3-29 (e) NMSA 1935 Comp.)
2. If the answer to question one is "no," have the interests of all the owners been consolidated by communitization agreement or otherwise? YES \_\_\_\_ NO \_\_\_\_ . If answer is "yes," Type of Consolidation \_\_\_\_
3. If the answer to question two is "no," list all the owners and their respective interests below:

Owner	Land Description

**RECEIVED**

**SEP 26 1961**

U. S. GEOLOGICAL SURVEY  
 ARTESIA, NEW MEXICO

**SECTION B**

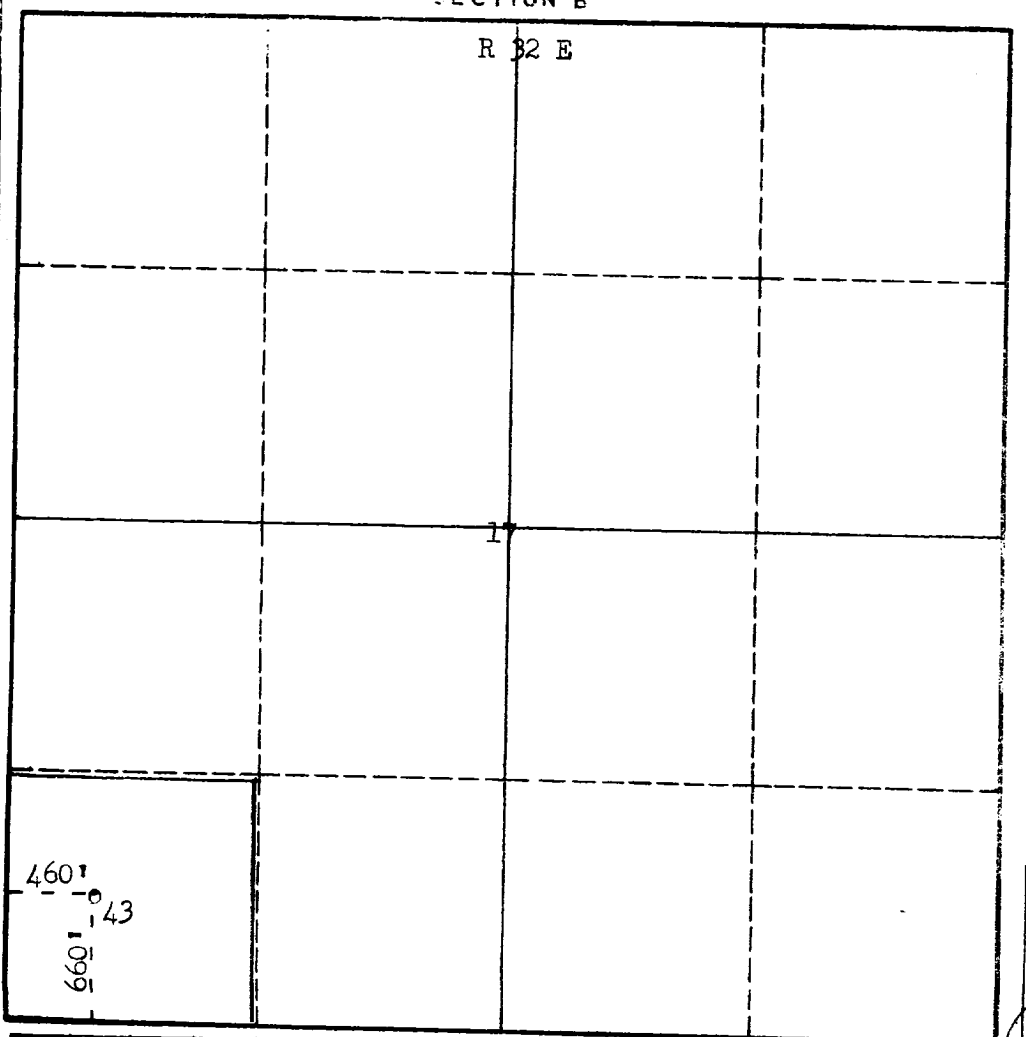

**CERTIFICATION**

I hereby certify that the information in SECTION A above is true and complete to the best of my knowledge and belief.

Name	<i>J. H. Hesser</i>
Position	<b>District Superintendent</b>
Company	<b>Continental Oil Company</b>
Date	<b>9-25-61</b>

I hereby certify that the well location shown on the plat in SECTION B was plotted from field notes of actual surveys made by me or under my supervision, and that the same is true and correct to the best of my knowledge and belief.

Date Surveyed	<b>September 23, 1961</b>
Registered Professional Engineer and/or Land Surveyor	<i>[Signature]</i>
Certificate No.	<b>N.M.L.S. No. 3280</b>

T  
17  
S

## **INSTRUCTIONS FOR COMPLETION OF FORM C-128**

1. Operator shall furnish and certify to the information called for in Section A.
2. Operator shall outline the dedicated acreage for *both* oil and gas wells on the plat in Section B.
3. A registered professional engineer or land surveyor registered in the State of New Mexico or approved by the Commission shall show on the plat the location of the well and certify this information in the space provided.
4. All distances shown on the plat must be from the outer boundaries of the Section.
5. If additional space is needed for listing owners and their respective interests as required in question 3 of Section A, please use space below.