

(SUBMIT IN TRIPLICATE)
UNITED STATES
DEPARTMENT OF THE INTERIOR
GEOLOGICAL SURVEY

Land Office Las Cruces
Lease No. 029509-A
Unit J

SUNDRY NOTICES AND REPORTS ON WELLS

NOTICE OF INTENTION TO DRILL.....	<input checked="" type="checkbox"/>	SUBSEQUENT REPORT OF WATER SHUT-OFF.....	
NOTICE OF INTENTION TO CHANGE PLANS.....		SUBSEQUENT REPORT OF SHOOTING OR ACIDIZING.....	
NOTICE OF INTENTION TO TEST WATER SHUT-OFF.....		SUBSEQUENT REPORT OF ALTERING CASING.....	
NOTICE OF INTENTION TO RE-DRILL OR REPAIR WELL.....		SUBSEQUENT REPORT OF REDRILLING OR REPAIR.....	
NOTICE OF INTENTION TO SHOOT OR ACIDIZE.....		SUBSEQUENT REPORT OF ABANDONMENT.....	
NOTICE OF INTENTION TO PULL OR ALTER CASING.....		SUPPLEMENTARY WELL HISTORY.....	
NOTICE OF INTENTION TO ABANDON WELL.....			

(INDICATE ABOVE BY CHECK MARK NATURE OF REPORT, NOTICE, OR OTHER DATA)

Artesia, New Mex. March 7, 1952

M. E. Balish
Well No. A-22Y is located 2310 ft. from N line and 1650 ft. from E line of sec. 21
NW/4 SE/4 Sec. 21 17S 32E NMPM
(1/4 Sec. and Sec. No.) (Twp.) (Range) (Meridian)
Balish Lea New Mexico
(Field) (County or Subdivision) (State or Territory)

The elevation of the derrick floor above sea level is _____ ft.

DETAILS OF WORK

(State names of and expected depths to objective sands; show sizes, weights, and lengths of proposed casings; indicate mudding jobs, cementing points, and all other important proposed work)

This well will be drilled with cable tools for a Yates sand producer to an approximate depth of 2350 ft.
A conductor string of 10-3/4" casing will be run to approximately 75 ft. and cemented to the surface. An intermediate string of 8-5/8" casing will be set in the Rustler Anhydrite at approximately 850 ft., if water be encountered above that point. This casing will not be cemented, but will be mudded and pulled when the production string is set. If no water be encountered, the 8-5/8" will not be run. The production string will be 7" 20# casing cemented at approximately 2300 ft. with 125 sacks of cement.

I understand that this plan of work must receive approval in writing by the Geological Survey before operations may be commenced.

Company BUFFALO OIL COMPANY
Address BOX 686
ARTESIA, NEW MEXICO
By [Signature]
Title Vice President

N

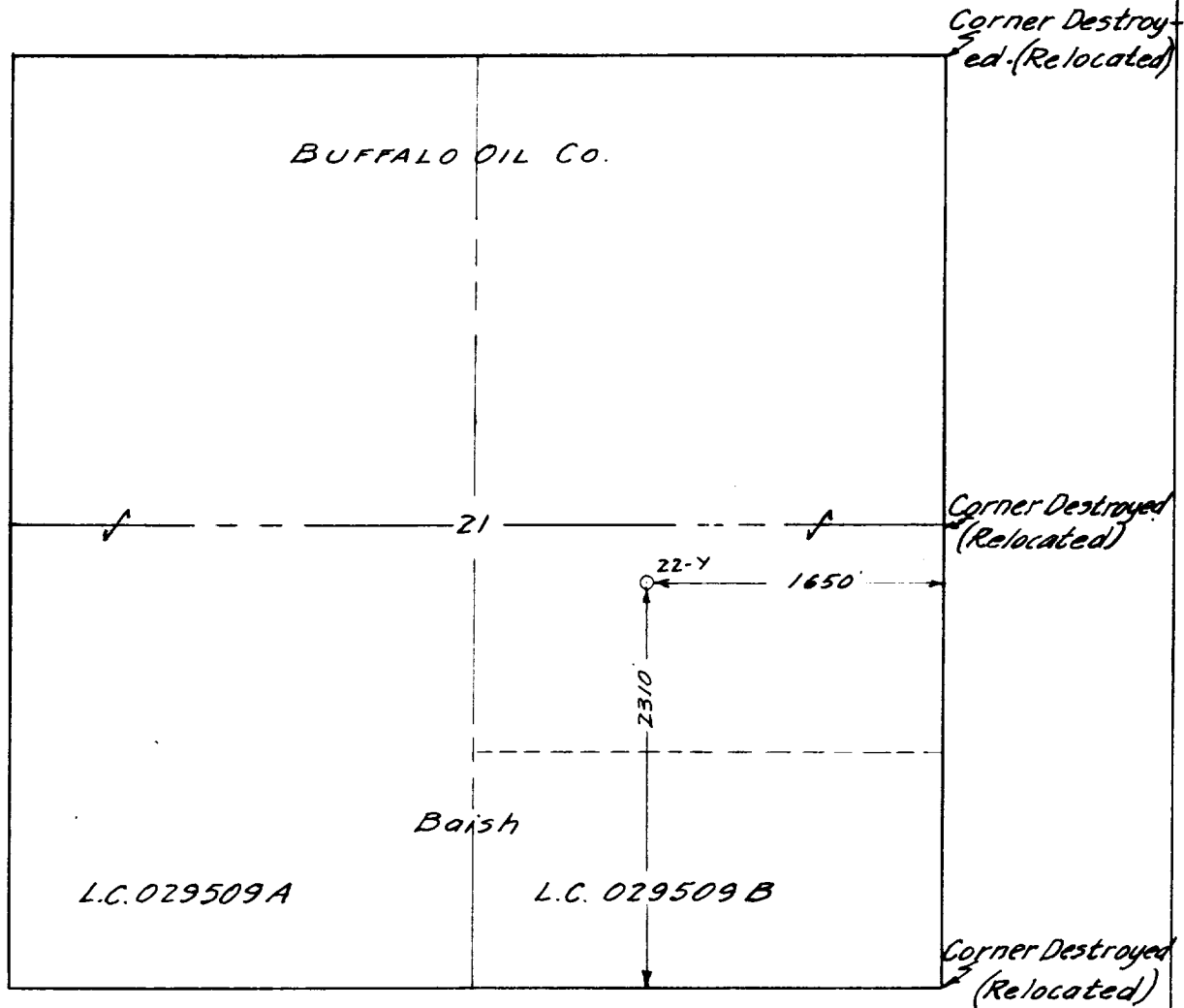

Sec. 21-T17S-R32E
Scale 5"=1 Mile

I, Charles P. Miller a licensed surveyor of the State of New Mexico, hereby certify that I have surveyed upon the ground, as platted herewith, a location site for BUFFALO OIL COMPANY, and that said site is 2310 feet from the South line and 1650 feet from the East line of section 21, township 17 South, range 32 East, N.M.P.M.

In witness whereof I hereunto affix my hand and seal this 26th day of February 1952.

Charles P. Miller
Charles P. Miller