

COUNTY	Lea	FIELD	Maljamar-Abo	STATE	N.M.	NO.	OWWO
OPR.	Continental Oil Company						MAP
NO.	14	LSE Baish, M. E. - Federal "B"					
SEC.	22	T.	17S	BLK.	32E	SUR.	CO-ORD.
LOC. 660' fr N Line & 1650' fr W Line of Sec.							
Re-	MI.	FROM	Re-	CLASS.	owd P		
SPUD.	7-31-63	COMP.	8-4-63	FORMATION	DATUM	FORMATION	DATUM
IRT.	Natural						
CSG. & SX.							
	7"	12500'	800				
TBG.	DEPTH	SIZE					
LOGS	EL	GR	RA	IND	HC	A	
				OTD	13657'	PB	9200'
PROD INT.	(DAILY RATE)	BS&W	GH	GOR	GTY	C. P.	T. P.
8928-64'	Flo. 246 BO		14/64"	1602	24.6		500#
(Abo)							24'

Distribution limited and publication prohibited by subscribers' agreement.  
Reproduction rights reserved by Williams & Lee Scouting Service, Inc.

CONT.	PROP DEPTH	TYPE
DATE		

*VP*

8-19-63 F.R.C. 8-22-63, OWWO. Oper's Elev. 4023'  
Re-Complete from Wolfcamp to Abo.  
OTD 13657' dolo., PB 9200', COMPLETED  
Set BP @ 9200', Perf 4/8985', & squeezed with  
100 sx.  
Perf (Abo) 13/8928-41', & 14/8950-64',  
Natural.

COUNTY	Lea	FIELD	Baish-Wolfcamp	S	N.M.	NO. OWWO
OPR.	Continental Oil Company					MAP
NO.	1	LSE.	Baish "B"	BLK.		
SEC.	22	T.	17S	R.	32E	SUR. CO-ORD.
LOC.	660' fr N Line & 1650' fr W Line of Sec.					
Re-	MI.	FROM	Re-	CLASS.	EL. 4023' LS	
SPUD.	9-25-63	COMP.	10-2-63	FORMATION	DATUM	FORMATION DATUM
IRT.						
CSG. & SX.						
	13 3/8"	473'	350			
	9 5/8"	4734'	3109			
	7"	12500'	800			
TBG.	DEPTH	SIZE				
LOGS	EL	GR	RA	IND	HC	A
				TD	13657'	PB 9917'
PROD INT.	(DAILY RATE)	BS&W	GH	GOR	GTY	C. P. T. P. HRS. TEST
9808-75'	Pmpd 81 BO + 7 BW			815	42.	24
(Wolfcamp)						

Distribution limited and publication prohibited by subscribers' agreement.  
Reproduction rights reserved by Williams & Lee Scouting Service, Inc.

CONT.	PROP DEPTH	TYPE
DATE		

10-28-63 F.R.C. 10-31-63, OWWO, OTD 13657'. Wolfcamp  
Formerly Temp. Abd. Now Dualled with Abo.  
TD 13657', PB 9917', COMPLETED.  
Pulled BP @ 9200' & Re-Set @ 9917'.  
(Old Wolfcamp Perfs) 9808-16', 9838-53' & 9860-75'.  
Ran Kobe Pump & Placed Wolfcamp on production.

NEW MEXICO OIL CONSERVATION COMMISSION  
WELL LOCATION AND ACREAGE DEDICATION PLAT

FORM C-12a  
Revised 5/1/57

SEE INSTRUCTIONS FOR COMPLETING THIS FORM ON THE REVERSE SIDE

SECTION A

Operator <b>Continental Oil Company</b>		Lease <b>Baish "B"</b>		Well No. <b>1</b>
Unit Letter <b>C</b>	Section <b>22</b>	Township <b>17S</b>	Range <b>32E</b>	County <b>Lea</b>
Actual Footage Location of Well: <b>660</b> feet from the <b>North</b> line and <b>1650'</b> feet from the <b>West</b> line				
Ground Level Elev. <b>4003</b>	Producing Formation <b>Abo</b>		Pool <b>Maljamar Abo</b>	Dedicated Acreage: <b>80</b> Acres

1. Is the Operator the only owner in the dedicated acreage outlined on the plat below? YES X NO \_\_\_\_ . ("Owner" means the person who has the right to drill into and to produce from any pool and to appropriate the production either for himself or for himself and another. (65-3-29 (e) NMSA 1935 Comp.)
2. If the answer to question one is "no," have the interests of all the owners been consolidated by communitization agreement or otherwise? YES \_\_\_\_ NO \_\_\_\_ . If answer is "yes," Type of Consolidation \_\_\_\_
3. If the answer to question two is "no," list all the owners and their respective interests below:

Owner	Land Description

SECTION B

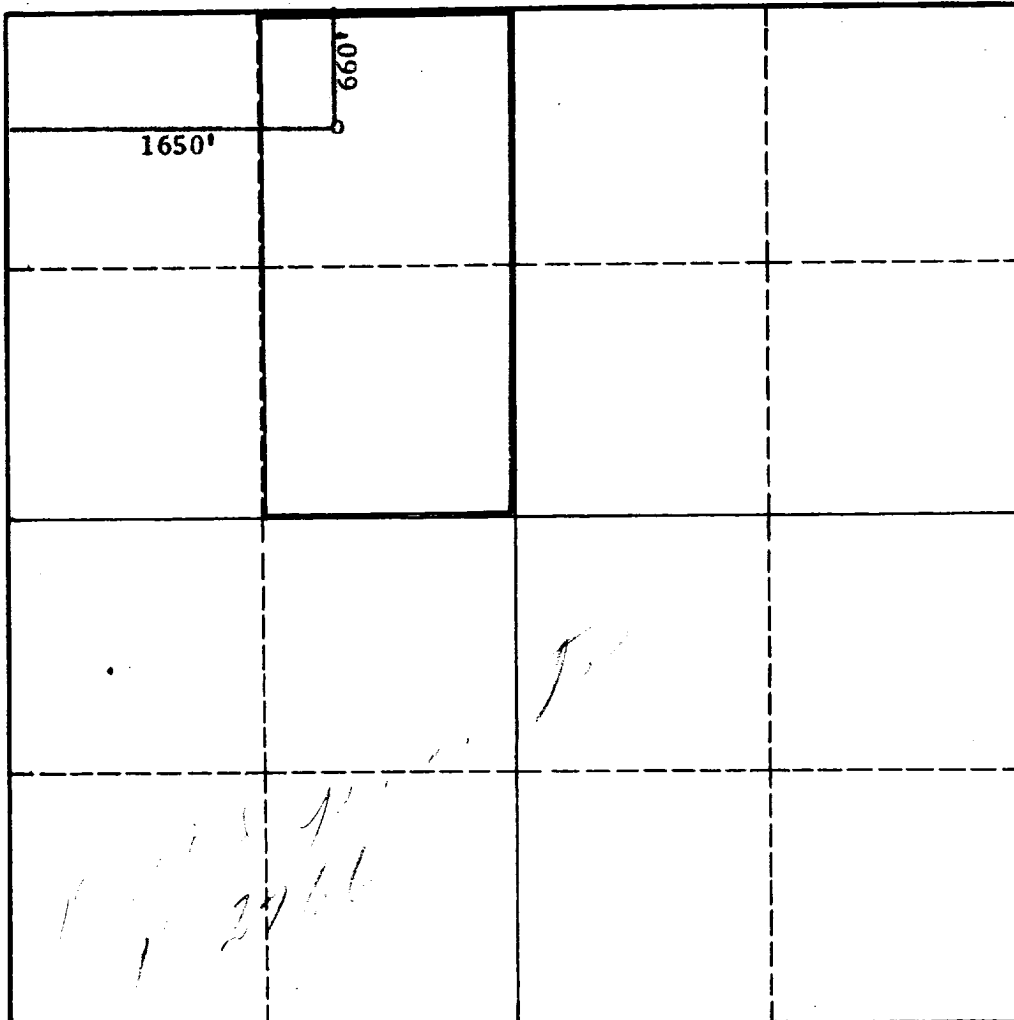

CERTIFICATION

I hereby certify that the information in SECTION A above is true and complete to the best of my knowledge and belief.

Name Signed: ROBERT GAULT II

Position  
**Staff Supervisor**

Company  
**Continental Oil Company**

Date  
**9-14-64**

NMOCC-4 JM

I hereby certify that the well location shown on the plat in SECTION B was plotted from field notes of actual surveys made by me or under my supervision, and that the same is true and correct to the best of my knowledge and belief.

Date Surveyed

Registered Professional Engineer  
and/or Land Surveyor

Certificate No.

### INSTRUCTIONS FOR COMPLETION OF FORM C-128

1. Operator shall furnish and certify to the information called for in Section A.
2. Operator shall outline the dedicated acreage for *both* oil and gas wells on the plat in Section B.
3. A registered professional engineer or land surveyor registered in the State of New Mexico or approved by the Commission shall show on the plat the location of the well and certify this information in the space provided.
4. All distances shown on the plat must be from the outer boundaries of the Section.
5. If additional space is needed for listing owners and their respective interests as required in question 3 of Section A, please use space below.

NEW MEXICO OIL CONSERVATION COMMISSION  
WELL LOCATION AND ACREAGE DEDICATION PLAT

FORM C-128  
Revised 5/1/57

SEE INSTRUCTIONS FOR COMPLETING THIS FORM ON THE REVERSE SIDE

SECTION A

Operator <b>Continental Oil Company</b>		Lease <b>Baish "B"</b>		Well No. <b>1</b>
Unit Letter <b>C</b>	Section <b>22</b>	Township <b>17S</b>	Range <b>32E</b>	County <b>Lea</b>
Actual Footage Location of Well: <b>660</b> feet from the <b>North</b> line and <b>1650</b> feet from the <b>West</b> line				
Ground Level Elev. <b>4003</b>	Producing Formation <b>Wolfcamp</b>		Pool <b>Baish Wolfcamp</b>	Dedicated Acreage: <b>80</b> Acres

1. Is the Operator the only owner in the dedicated acreage outlined on the plat below? YES X NO \_\_\_\_ . ("Owner" means the person who has the right to drill into and to produce from any pool and to appropriate the production either for himself or for himself and another. (65-3-29 (e) NMSA 1935 Comp.)
2. If the answer to question one is "no," have the interests of all the owners been consolidated by communitization agreement or otherwise? YES \_\_\_\_ NO \_\_\_\_ . If answer is "yes," Type of Consolidation \_\_\_\_\_
3. If the answer to question two is "no," list all the owners and their respective interests below:

Owner	Land Description

SECTION B

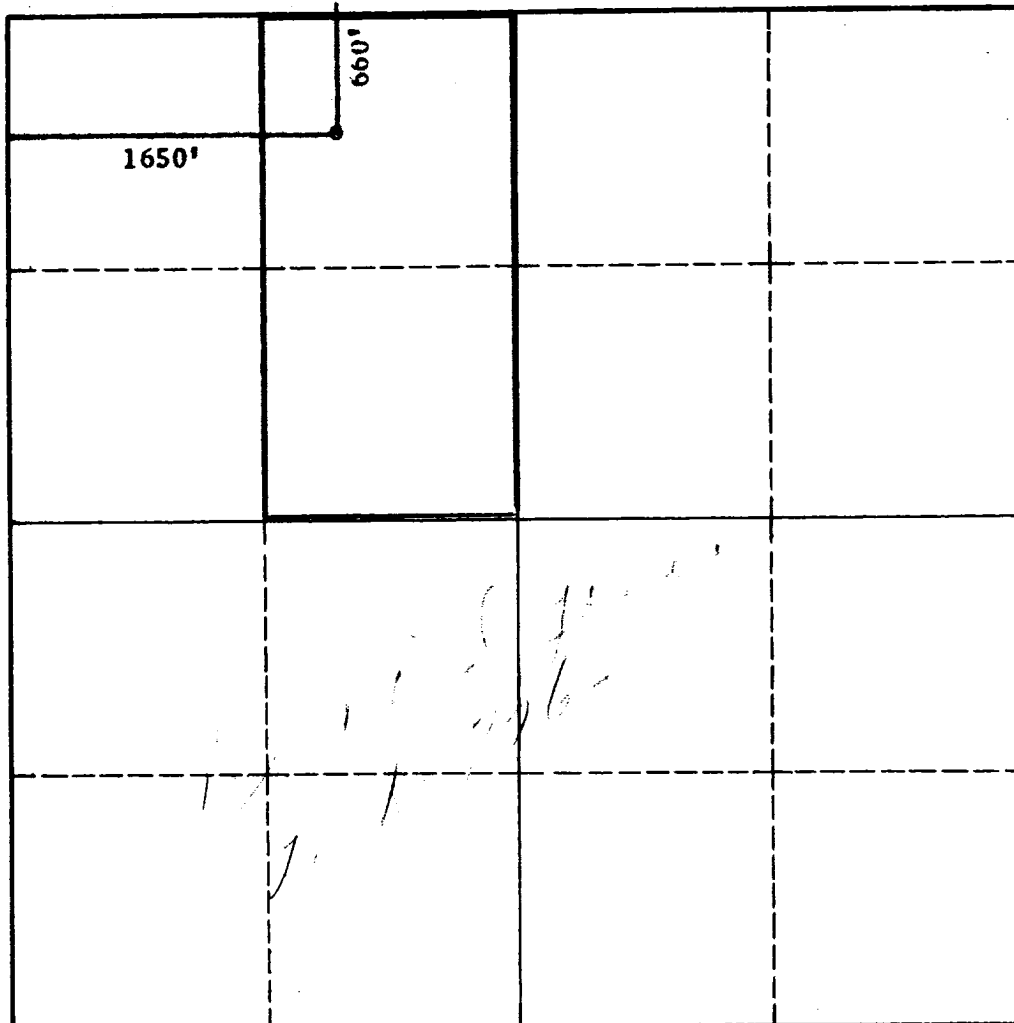

CERTIFICATION

I hereby certify that the information in SECTION A above is true and complete to the best of my knowledge and belief.

Name  
*Signed: ROBERT GALLIE*  
Position  
**Staff Supervisor**  
Company  
**Continental Oil Company**  
Date  
**9-14-64**

NMOCC-4 JM

I hereby certify that the well location shown on the plat in SECTION B was plotted from field notes of actual surveys made by me or under my supervision, and that the same is true and correct to the best of my knowledge and belief.

Date Surveyed  
  
Registered Professional Engineer  
and/or Land Surveyor

Certificate No.

0 330 660 990 1320 1650 1980 2310 2640 2000 1500 1000 500 0

### INSTRUCTIONS FOR COMPLETION OF FORM C-128

1. Operator shall furnish and certify to the information called for in Section A.
2. Operator shall outline the dedicated acreage for *both* oil and gas wells on the plat in Section B.
3. A registered professional engineer or land surveyor registered in the State of New Mexico or approved by the Commission shall show on the plat the location of the well and certify this information in the space provided.
4. All distances shown on the plat must be from the outer boundaries of the Section.
5. If additional space is needed for listing owners and their respective interests as required in question 3 of Section A, please use space below.