

UNITED STATES
DEPARTMENT OF THE INTERIOR
GEOLOGICAL SURVEY

APPLICATION FOR PERMIT TO DRILL, DEEPEN, OR PLUG BACK

1a. TYPE OF WORK

~~DRILL~~ ☒ RE-ENTER ☐ DEEPEN ☐ PLUG BACK ☐

b. TYPE OF WELL

OIL WELL ☒ GAS WELL ☐ OTHER (P&A) ☐ SINGLE ZONE ☒ MULTIPLE ZONE ☐

2. NAME OF OPERATOR

CONTINENTAL OIL COMPANY

3. ADDRESS OF OPERATOR

Box 460, Hobbs, N.M. 88240

4. LOCATION OF WELL (Report location clearly and in accordance with any State requirements.)*

At surface
1295' FSL & 1245' FEL OF SEC. 25

At proposed prod. zone

SAME

14. DISTANCE IN MILES AND DIRECTION FROM NEAREST TOWN OR POST OFFICE*

15. DISTANCE FROM PROPOSED*

LOCATION TO NEAREST
PROPERTY OR LEASE LINE, FT.
(Also to nearest drlg. unit line, if any)

16. NO. OF ACRES IN LEASE

17. NO. OF ACRES ASSIGNED
TO THIS WELL

18. DISTANCE FROM PROPOSED LOCATION*

TO NEAREST WELL, DRILLING, COMPLETED,
OR APPLIED FOR, ON THIS LEASE, FT.

19. PROPOSED DEPTH

20. ROTARY OR CABLE TOOLS

21. ELEVATIONS (Show whether DF, RT, GR, etc.)

4000'

22. APPROX. DATE WORK WILL START*

23. PROPOSED CASING AND CEMENTING PROGRAM

SIZE OF HOLE	SIZE OF CASING	WEIGHT PER FOOT	SETTING DEPTH	QUANTITY OF CEMENT
	8 5/8"	24#	1289'	75 sks.
	7"	23#	3986'	200 sks.

This well was P&A 10-2-49 by Kowance Oil Co. It is proposed to re-enter and complete as an MCA Waterflood producer by the following method: Mill & clean out to 4335'. Run caliper log over open hole from 4335' to csg. shoe @ 3986'. Spot 5' Calseal 4335'-4330'. Treat OH w/500 gals 15% acid. Frac w/2000 gals. trtd. fresh wtr. followed by 1500 gals. trtd. fresh wtr. w/60# Guar Gel, 37# "ADEMITE" AQUA, 30,000# sand. Clean out & install prod. eqpt.

IN ABOVE SPACE DESCRIBE PROPOSED PROGRAM: If proposal is to deepen or plug back, give data on present productive zone and proposed new productive zone. If proposal is to drill or deepen directionally, give pertinent data on subsurface locations and measured and true vertical depths. Give blowout preventer program, if any.

24.

SIGNED

TITLE

SR. ANALYST

DATE

1-14-76

(This space for Federal or State office use)

PERMIT NO.

APPROVAL DATE

APPROVED
FEB 6 1976

APPROVED BY

TITLE

ARTHUR R. BROWN
SPECIAL AGENT

CONDITIONS OF APPROVAL, IF ANY:

*See Instructions On Reverse Side

1545-6, MCA-4, FILE

RECEIVED

FEB 4 1976

U.S. CONSERVATION COMM.
HOBBBS, N. M.

NEW MEXICO OIL CONSERVATION COMMISSION
WELL LOCATION AND ACREAGE DEDICATION PLAT

Form C-102
Supersedes C-128
Effective 1-1-65

All distances must be from the outer boundaries of the Section.

Operator CONTINENTAL OIL CO.		Lease PEARL "B"		Well No. 27	
Unit Letter P	Section 25	Township 17-S	Range 32-E	County LEA	
Actual Footage Location of Well: 1295 feet from the SOUTH line and 1245 feet from the EAST line					
Ground Level Elev. 4000.3	Producing Formation SAN ANDRES		Pool MALJ. G-SA REPRESS.	Dedicated Acreage: 40 Acres	

1. Outline the acreage dedicated to the subject well by colored pencil or hachure marks on the plat below.
2. If more than one lease is dedicated to the well, outline each and identify the ownership thereof (both as to working interest and royalty).
3. If more than one lease of different ownership is dedicated to the well, have the interests of all owners been consolidated by communitization, unitization, force-pooling, etc?

☐ Yes ☐ No If answer is "yes," type of consolidation _____

If answer is "no," list the owners and tract descriptions which have actually been consolidated. (Use reverse side of this form if necessary.) _____

No allowable will be assigned to the well until all interests have been consolidated (by communitization, unitization, forced-pooling, or otherwise) or until a non-standard unit, eliminating such interests, has been approved by the Commission.

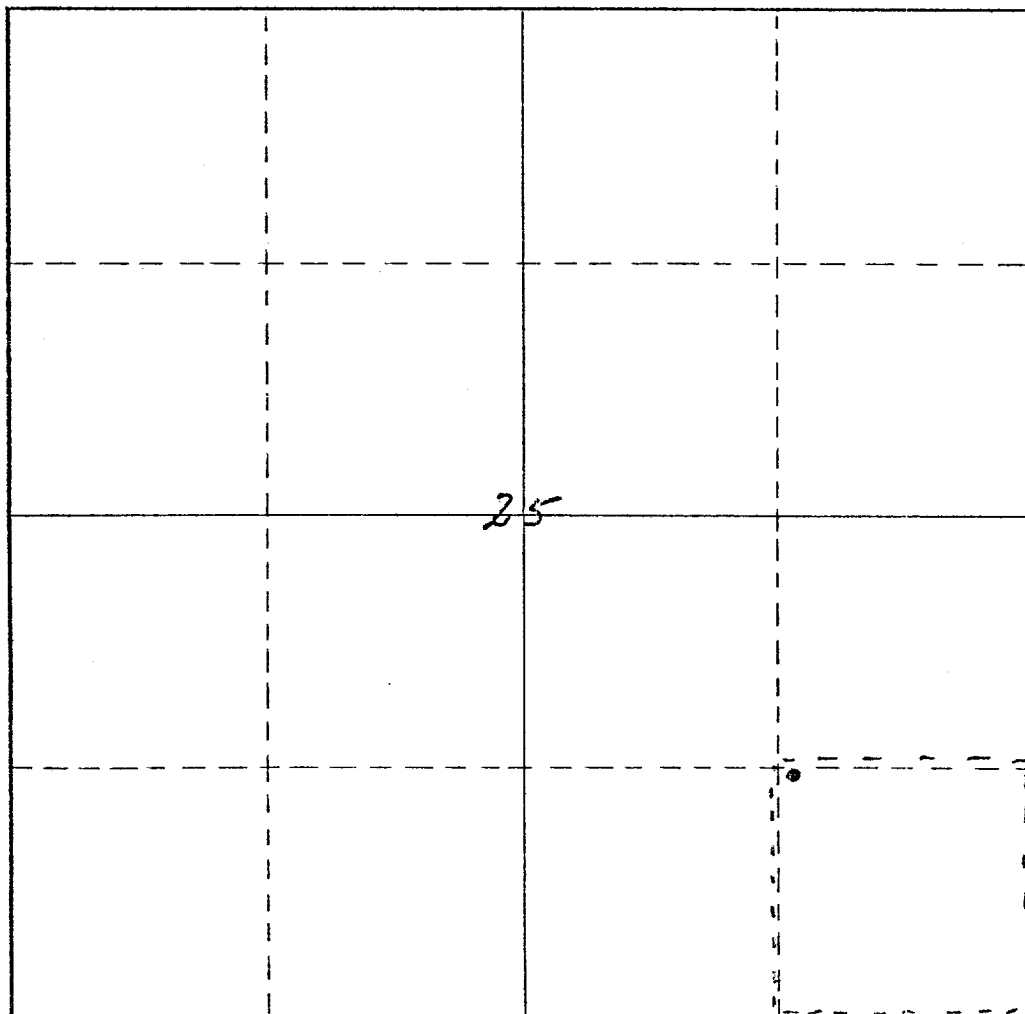

CERTIFICATION

I hereby certify that the information contained herein is true and complete to the best of my knowledge and belief.

Name [Signature]
Position **SR. ANALYST**
Company **CONTINENTAL OIL CO.**
Date **1-14-76**

I hereby certify that the well location shown on this plat was plotted from field notes of actual surveys made by me or under my supervision, and that the same is true and correct to the best of my knowledge and belief.

Date Surveyed **4-8-49**
W.W. PORTS
Registered Professional Engineer
and/or Land Surveyor

Certificate No.

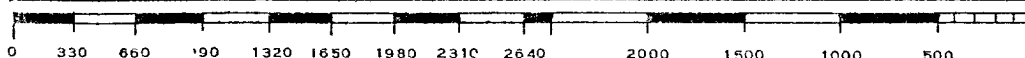

RECEIVED

FEB 1 1976

OIL CONSERVATION COMM.
HOBBS, N. M.