

Re-enter

NOTICE OF INTENTION TO DRILL

Notice must be given to the District Office of the Oil Conservation Commission and approval obtained before drilling or recompletion begins. If changes in the proposed plan are considered advisable, a copy of this notice showing such changes will be returned to the sender. Submit this notice in **QUINTUPPLICATE**. One copy will be returned following approval. See additional instructions in Rules and Regulations of the Commission. If State Land submit 6 Copies Attach Form C-128 in triplicate to first 3 copies of form C-101 on all wells

Artesia, New Mexico

June 9, 1959

(Place)

(Date)

OIL CONSERVATION COMMISSION
SANTA FE, NEW MEXICO

Gentlemen:

re-enter

You are hereby notified that it is our intention to ~~drill~~ drill a well to be known as

Carper Drilling Company, Inc.

(Company or Operator)

Carper-Williams

(Lease)

Well No. **1**

in **B**

(Unit)

located **660** feet from the **North** line and **1980** feet from the

East

line of Section **36**, T. **17S**, R. **32E**, NMPM.

(GIVE LOCATION FROM SECTION LINE)

Undesignated Pool, **Lea** County

If State Land the Oil and Gas Lease is No. **B-41113**

If patented land the owner is

Address

We propose to drill well with drilling equipment as follows: **Cable Tools**
to clean out

The status of plugging bond is **Blanket Bond**

Drilling Contractor **Carper Drilling Company, Inc.**

We intend to complete this well in the **Grayburg** formation at an approximate depth of **4207' - 4410'** feet.

CASING PROGRAM

We propose to use the following strings of Casing and to cement them as indicated:

Size of Hole	Size of Casing	Weight per Foot	New or Second Hand	Depth	Seals Cement
11 3/4"	8 5/8"	24 #	New	218' - 1276'	50 sx.
8 1/4"	7"	23 #	New	3180' - 4578'	100 sx.

If changes in the above plans become advisable we will notify you immediately.

ADDITIONAL INFORMATION

See attached sheet.

Approved....., 19.....
Except as follows:

OIL CONSERVATION COMMISSION

By *[Signature]*

Sincerely yours,

Carper Drilling Company, Inc.

(Company or Operator)

By *[Signature]*

Position **Vice President**

Send Communications regarding well to

Name **Carper Drilling Company, Inc.**

Address **Artesia, New Mexico**

Figure 1. The effect of the concentration of the *Agrobacterium* suspension on the transformation efficiency of *Agrobacterium* strains.

Figure 1. The effect of the concentration of the *Agrobacterium* suspension on the transformation efficiency of *Agrobacterium* strains.

[illegible]

4. 2. 2.

1. *Journal of the American Medical Association*, 1997; 278: 1025-1030.

4

$$A = \begin{pmatrix} 1 & 0 & 0 \\ 0 & 1 & 0 \\ 0 & 0 & 1 \end{pmatrix}, \quad B = \begin{pmatrix} 0 & 0 & 0 \\ 0 & 0 & 0 \\ 0 & 0 & 0 \end{pmatrix}, \quad C = \begin{pmatrix} 0 & 0 & 0 \\ 0 & 0 & 0 \\ 0 & 0 & 0 \end{pmatrix}, \quad D = \begin{pmatrix} 0 & 0 & 0 \\ 0 & 0 & 0 \\ 0 & 0 & 0 \end{pmatrix}.$$

•

We propose to re-enter this plugged & abandoned well and do the following:

- 1. Drill out cement plugs to 4550'.**
- 2. Run 218' 8 5/8" 24# casing as tie in to pulled surface string.**
- 3. Run Gamma Ray-Neutron Log and cement top indicator.**
- 4. Set cement plug in bottom of 7" casing.**
- 5. Perforate indicated porosity.**
- 6. Run 2 7/8" tbg with packer.**
- 7. Fracture zone with 15,000 gals oil and 30,000 lb. sand.**
- 8. Swab and test thru tubing.**

If well shows commercial production:

- 1. Kill with salt water.**
- 2. Pull tubing and packer.**
- 3. Set cast iron drillable bridge plug at 3500'.**
- 4. Run approximately 3450' 5 1/2" 15.5# new casing and cement with 150 sacks cement.**
- 5. Drill out cement and bridge plug.**
- 6. Run 2 3/8" tubing and put on production.**

NEW MEXICO OIL CONSERVATION COMMISSION

Well Location and Acreage Dedication Plat

Section A.

Date June 6, 1959

Operator Carper Drilling Company, Inc. Lease Carper Williams
Well No. 1 Unit Letter B Section 36 Township 17 S Range 32 E NMPM
Located 660 Feet From North Line, 1980 Feet From East Line
County Lea G. L. Elevation 3977' Dedicated Acreage 40 Acres
Name of Producing Formation Grayburg Pool Mojave

1. Is the Operator the only owner* in the dedicated acreage outlined on the plat below?
Yes X No _____.
2. If the answer to question one is "no," have the interests of all the owners been consolidated by communitization agreement or otherwise? Yes _____ No _____. If answer is "yes," Type of Consolidation _____.
3. If the answer to question two is "no," list all the owners and their respective interests below:

Owner

Land Description

Section B

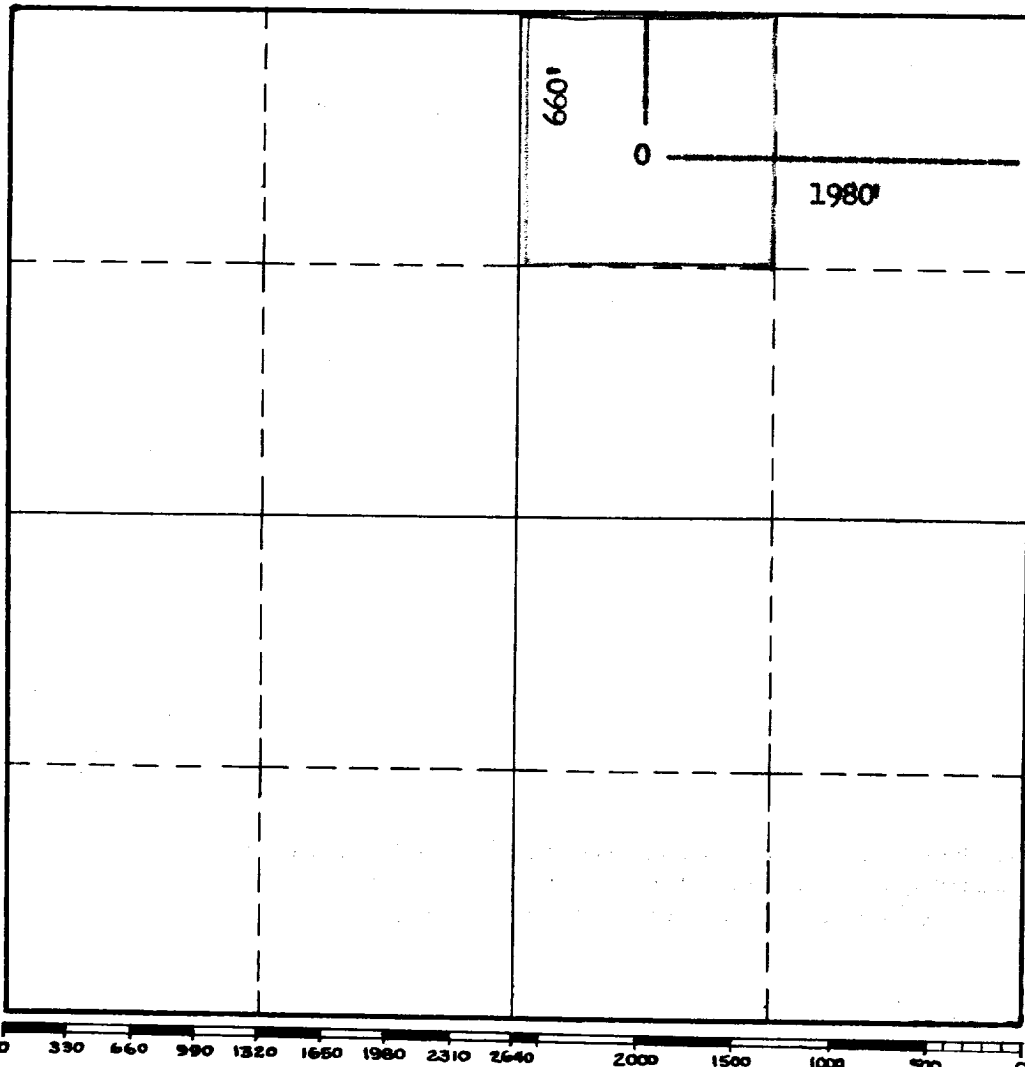

This is to certify that the information in Section A above is true and complete to the best of my knowledge and belief.

Carper Drilling Company, Inc.
(Operator)

J. Harscoe Hawley
(Representative)

Artesia, New Mexico
Address

This is to certify that the well location shown on the plat in Section B was plotted from field notes of actual surveys made by me or under my supervision and that the same is true and correct to the best of my knowledge and belief.

Date Surveyed 2-6-57

Clark E. Storm
Registered Professional
Engineer and/or Land Surveyor.

Certificate No. 1083

(See instructions for completing this form on the reverse side)

INSTRUCTIONS FOR COMPLETION

1. Operator shall furnish and certify to the information called for in Section A.
2. Operator shall outline the dedicated acreage for both oil and gas wells on the plat in Section B.
3. A registered professional engineer or land surveyor registered in the State of New Mexico or approved by the Commission shall show on the plat the location of the well and certify this information in the space provided.
4. All distances shown on the plat must be from the outer boundaries of Section.
5. If additional space is needed for listing owners and their respective interests as required in question 3, Section A, please use space below

* "Owner" means the person who has the right to drill into and to produce from any pool and to appropriate the production either for himself or for himself and another. (65-3-29 (e) NMSA 1953 Comp.)