

NEW MEXICO OIL CONSERVATION COMMISSION
Santa Fe, New Mexico

NOTICE OF INTENTION TO DRILL ~~ON RECOMPLETION~~

Notice must be given to the District Office of the Oil Conservation Commission and approval obtained before drilling or recompletion begins. If changes in the proposed plan are considered advisable, a copy of this notice showing such changes will be returned to the sender. Submit this notice in QUINTUPPLICATE. One copy will be returned following approval. See additional instructions in Rules and Regulations of the Commission. If State Land submit 6 Copies

Midland, Texas

(Place)

March 21, 1956

(Date)

OIL CONSERVATION COMMISSION
SANTA FE, NEW MEXICO

Gentlemen:

You are hereby notified that it is our intention to commence the (Drilling) (~~Recompletion~~) of a well to be known as

Humble Oil & Refining Company

(Company or Operator)

(Co. Lease #130849 & 203496)

South Saunders Unit

(Lease)

, Well No. 1, in "1" (Unit) The well is

located 3504.8 feet from the North line and 880 feet from the

East

Line of Section 1, T-16-S, R.-33-E, NMPM.

(GIVE LOCATION FROM SECTION LINE) South Saunders Area Wildcat Pool, Lea County

If State Land the Oil and Gas Lease is No. E-1240

If patented land the owner is

Address

We propose to drill well with drilling equipment as follows: Rotary

The status of plugging bond is on file with Commission office

Drilling Contractor Unknown

We intend to complete this well in the Devonian

formation at an approximate depth of 14,000 feet.

CASING PROGRAM

We propose to use the following strings of Casing and to cement them as indicated:

Size of Hole	Size of Casing	Weight per Foot	New or Second Hand	Depth	Sacks Cement
17-1/4"	13-3/8"	48#	Rev	350'	400 sxs.*
12-1/4"	9-5/8"	36#	"	4900'	2000 sxs.**
8-3/4"	5-1/2"	17, 20 & 23#	"	14,000'	1200 sxs.***

If changes in the above plans become advisable we will notify you immediately.

ADDITIONAL INFORMATION (If recompletion give full details of proposed plan of work.)

* Return to surface.

** Circulate to 13-3/8" casing.

*** Circulate to 9-5/8" casing.

Approved....., 19.....
Except as follows:

OIL CONSERVATION COMMISSION

By.....

Sincerely yours,

Humble Oil & Refining Company

(Company or Operator)

By.....

Position..... Division Chief Clerk

Send Communications regarding well to

Name..... J. W. House

Address..... Box 1600, Midland, Texas

NEW MEXICO
OIL CONSERVATION COMMISSION

Form C-128

Well Location and/or Gas Proration Plat

Date 3-19-56

Operator HUMBLE OIL & REF. CO. Lease SOUTH SAUNDERS UNIT

Well No. 1 Section 1 Township 16-S Range 33-E NMPM

Located 3504.6 Feet From NORTH Line, 660 Feet From EAST Line,

LEA County, New Mexico. G. L. Elevation _____

Name of Producing Formation DEVONIAN Pool SO SAUNDERS Dedicated Acreage 40

(Note: All distances must be from outer boundaries of Section)

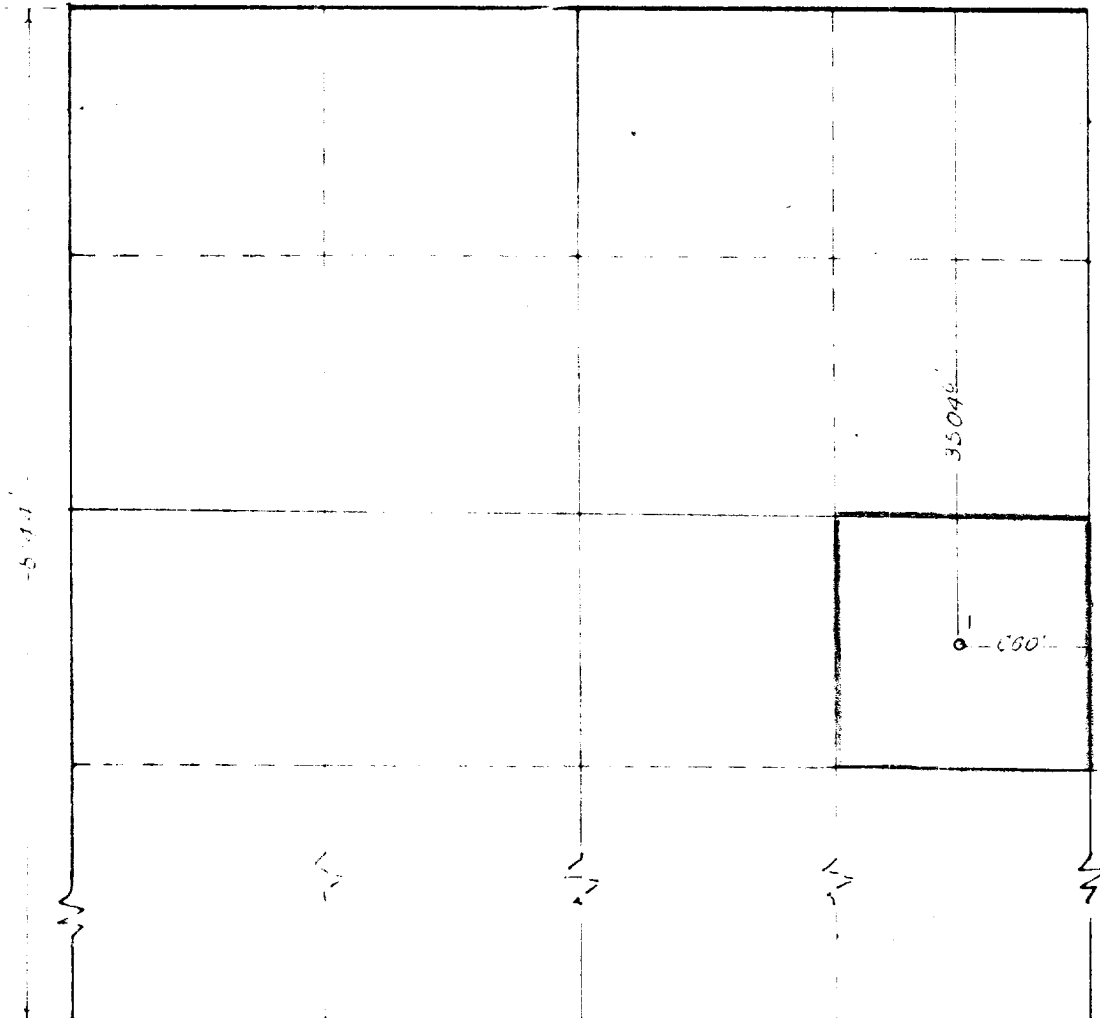

SCALE: 1" = 1000'

1. Is this Well a Dial Comp.? Yes No
2. If the answer to Question 1 is yes, are there any other dually completed wells within the dedicated acreage? Yes No

This is to certify that the above plat was prepared from field notes of actual surveys made by me or under my supervision and that the same are true and correct to the best of my knowledge and belief.

Name E. T. Shahan
Position ASSISTANT DIVISION SUPERINTENDENT
Representing HUMBLE OIL & REFINING CO.
Address BOX 1600 MIDLAND TEXAS

Date Surveyed 3-19-56
E. T. Shahan
Registered Professional Engineer and/or
Land Surveyor

W A 2069