

NEW MEXICO OIL CONSERVATION COMMISSION
Well Location and Acreage Dedication Plat

Section A.

Date 2-27-57

Operator Humble Oil & Refining Co. Lease New Mexico State "A11"
Well No. 1 Unit Letter "P" Section 4 Township 16S Range 33 E NMPM
located 660 Feet From East Line, 660 Feet From South Line
County Lea G. L. Elevation _____ Dedicated Acreage 40 Acres
Name of Producing Formation Pennsylvanian Pool Undesignated

1. Is the Operator the only owner* in the dedicated acreage outlined on the plat below?
Yes X No _____.
2. If the answer to question one is "no," have the interests of all the owners been consolidated by communitization agreement or otherwise? Yes _____ No _____. If answer is "yes," Type of Consolidation _____
3. If the answer to question two is "no," list all the owners and their respective interests below:

Owner

Land Description

Section B

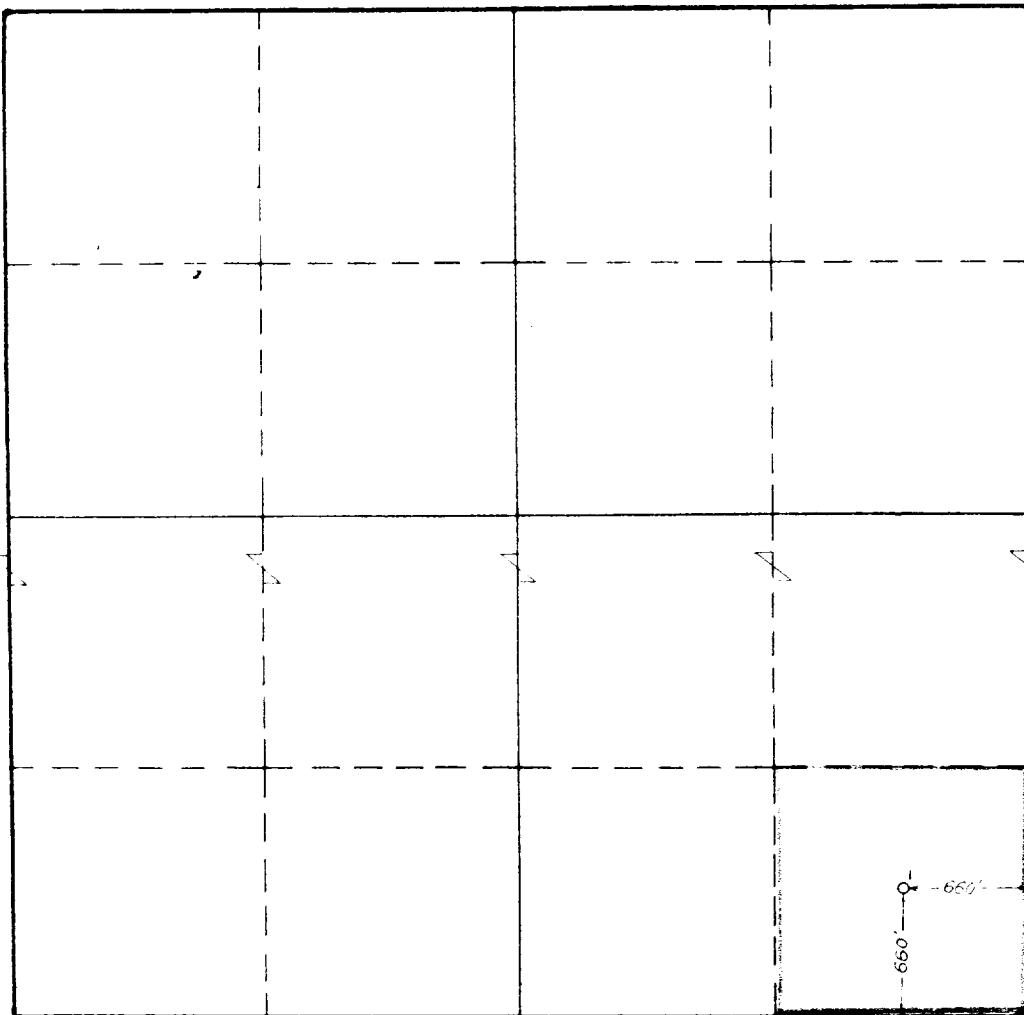

This is to certify that the information in Section A above is true and complete to the best of my knowledge and belief.

Humble Oil & Refining Co.
(Operator)
Henry E. Thompson
(Representative)
Asst. Division Supt.
Box 1600, Midland, Texas
Address

This is to certify that the well location shown on the plat in Section B was plotted from field notes of actual surveys made by me or under my supervision and that the same is true and correct to the best of my knowledge and belief.

Date Surveyed 3-1-57
Wendell S. Winterfield
Registered Professional
Engineer and/or Land Surveyor.

0 330 660 990 1320 1650 1980 2310 2640 2000 1500 1000 500 0

(See instructions for completing this form on the reverse side)

Certificate No. 1382

155 127212

WIA. 2277