

| | |
|------------------------|--|
| NO. OF COPIES RECEIVED | |
| DISTRIBUTION | |
| SANTA FE | |
| FILE | |
| U.S.G.S. | |
| LAND OFFICE | |
| OPERATOR | |

API NO.

APPLICATION FOR PERMIT TO DRILL, DEEPEN, OR PLUG BACK

| |
|--|
| 5A. Indicate Type of Lease STATE <input checked="" type="checkbox"/> FEE <input type="checkbox"/> |
| 5. State Oil & Gas Lease No. E-1814 |
| 7. Unit Agreement Name --- |
| 8. Farm or Lease Name New Mex "A" |
| 9. Well No. 2 |
| 10. Field and Pool, or Wildcat South Kemnitz, Atoka- Morrow Gas UNDESIGNATED |
| 12. County Lea |

| | | | |
|---|--|--|------------------------------------|
| 1a. Type of Work * Re-entry of P & A well | DRILL <input type="checkbox"/> | DEEPEN <input checked="" type="checkbox"/> | PLUG BACK <input type="checkbox"/> |
| b. Type of Well OIL WELL <input type="checkbox"/> GAS WELL <input checked="" type="checkbox"/> OTHER | SINGLE ZONE <input checked="" type="checkbox"/> MULTIPLE ZONE <input type="checkbox"/> | | |
| 2. Name of Operator Phillips Petroleum Company | | | |
| 3. Address of Operator Room 401, 4001 Penbrook St., Odessa, Texas 79762 | | | |
| 4. Location of Well UNIT LETTER <u>0</u> LOCATED <u>661</u> FEET FROM THE <u>south</u> LINE AND <u>1983</u> FEET FROM THE <u>east</u> LINE OF SEC. <u>25</u> TWP. <u>16-S</u> RGE. <u>33-E</u> NMPM | | | |

| | | | | | |
|--|--|------------------------------|--------------------------|------------------------------|---|
| 1. Elevations (Show whether DF, KT, etc.) 4151.9' Gr (Unprepared) | 21A. Kind & Status Plug. Bond blanket | 19. Proposed Depth 13,500 | 19A. Formation Morrow | 20. Rotary or C.T. Rotary | 22. Approx. Date Work will start upon approval |
| 21B. Drilling Contractor advise later | | | | | |

23. PROPOSED CASING AND CEMENT PROGRAM

| SIZE OF HOLE | SIZE OF CASING | WEIGHT PER FOOT | SETTING DEPTH | SACKS OF CEMENT | EST. TOP |
|--------------|----------------|-------------------|---------------|--|----------|
| 17-1/2" | 13-3/8" | 27# & 48# | 395' | 500reg & 25sx circ | Surface |
| 11" | 8-5/8" | 24# & 38# | 4552' | 1367 sx Regular | Surface |
| 7-7/8" | 5 1/2" | 17# & 20# N-80 | 13,500' | (Tie back to intermediate in two stages with DV tool at 10,150'. 1. Sufficient volume plus 30% excess Class H W/3#/sx KCL & 0.15% LWL. 2. Sufficient volume plus 30% excess TLW W/10% Diacel D, 10% Salt and 1/4#/sx Flocele follow W/100sx Class H W/0.15% LWL. | |

APPROVAL VALID FOR 180 DAYS
PERMIT EXPIRES 4/21/83
UNLESS DRILLING UNDERWAY

Use Mud Additives as required for control.

BOP EQUIPMENT: Series 1500, 5000 PSI WP. (See Figure 5 Attached)

* Well originally drilled in June, 1958 and Plugged and Abandoned in August, 1958

IN ABOVE SPACE DESCRIBE PROPOSED PROGRAM; IF PROPOSAL IS TO DEEPEN OR PLUG BACK, GIVE DATA ON PRESENT PRODUCTIVE ZONE AND PROPOSED NEW PRODUCTIVE ZONE. GIVE BLOWOUT PREVENTER PROGRAM, IF ANY.

I hereby certify that the information above is true and complete to the best of my knowledge and belief.

Signed W. J. Mueller Title Senior Engineering Specialist Date October 18, 1982
(This space for State Use)

APPROVED BY JERRY SEXTON TITLE _____ DATE _____
CONDITIONS OF APPROVAL: ANY DISTRICT: SUPP.

OCT 20 1982

RECEIVED
OCT 19 1982
F.B.I.
POLICE OFFICE

NEW MEXICO OIL CONSERVATION COMMISSION
WELL LOCATION AND ACREAGE DEDICATION PLAT

Form C-102
Supersedes C-128
Effective 1-1-65

All distances must be from the outer boundaries of the Section.

| | | | | |
|---|-------------------------------|---|---------------------------------|---------------|
| Operator PHILLIPS PETROLEUM CO. | | Lease NEW MEX "A" | | Well No. 2 |
| Unit Letter O | Section 25 | Township 16 SOUTH | Range 33 EAST | County LEA |
| Actual Footage Location of Well: 1983 feet from the EAST line and 661 feet from the SOUTH line | | | | |
| Ground Level Elev. 4151.9' GR (Unprepared) | Producing Formation Morrow | Pool South Kemnitz, Atoka-Morrow Gas | Dedicated Acreage: 320 Acres | |

- Outline the acreage dedicated to the subject well by colored pencil or hachure marks on the plat below.
- If more than one lease is dedicated to the well, outline each and identify the ownership thereof (both as to working interest and royalty).
- If more than one lease of different ownership is dedicated to the well, have the interests of all owners been consolidated by communitization, unitization, force-pooling, etc?

☐ Yes ☐ No If answer is "yes," type of consolidation _____

If answer is "no," list the owners and tract descriptions which have actually been consolidated. (Use reverse side of this form if necessary.) _____

No allowable will be assigned to the well until all interests have been consolidated (by communitization, unitization, forced-pooling, or otherwise) or until a non-standard unit, eliminating such interests, has been approved by the Commission.

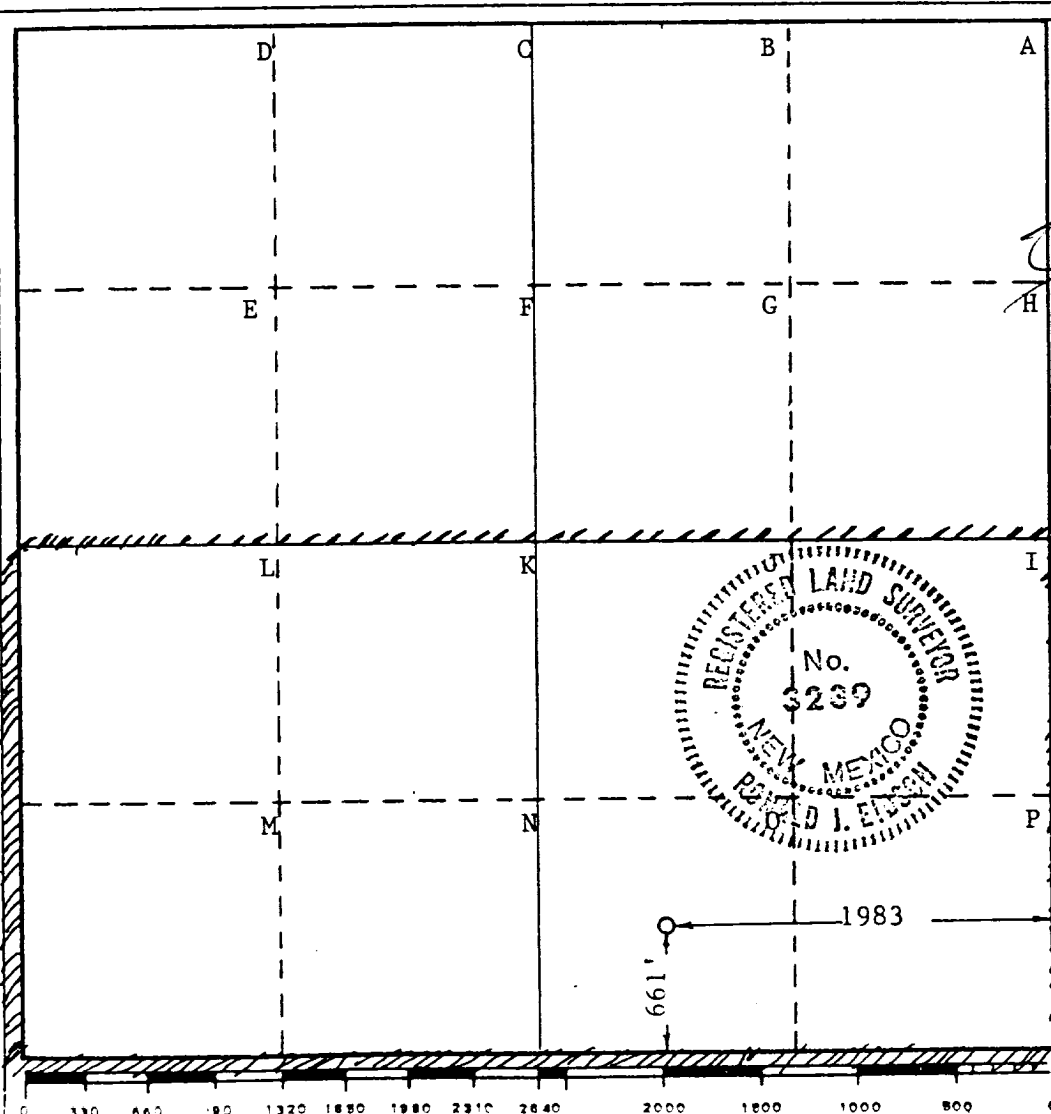

| | |
|---|---|
| CERTIFICATION | |
| I hereby certify that the information contained herein is true and complete to the best of my knowledge and belief. | |
| <i>[Signature]</i> | W. J. Mueller |
| Name | |
| Senior Engineering Specialist | Position |
| Phillips Petroleum Company | Company |
| October 18, 1982 | Date |
| I hereby certify that the well location shown on this plat was plotted from field notes of actual surveys made by me or under my supervision, and that the same is true and correct to the best of my knowledge and belief. | |
| Date Surveyed | October 15, 1982 |
| Registered Professional Engineer and/or Land Surveyor | |
| <i>[Signature]</i> | |
| Certificate No. | JOHN W. WEST 678 PATRICK A. ROMERO 6863 Ronald J. Eidson 3239 |

RECEIVED
OCT 19 1982
NO. 100-100000

DOUBLE PREVENTER OPTION

..... OPTIONAL EQUIPMENT

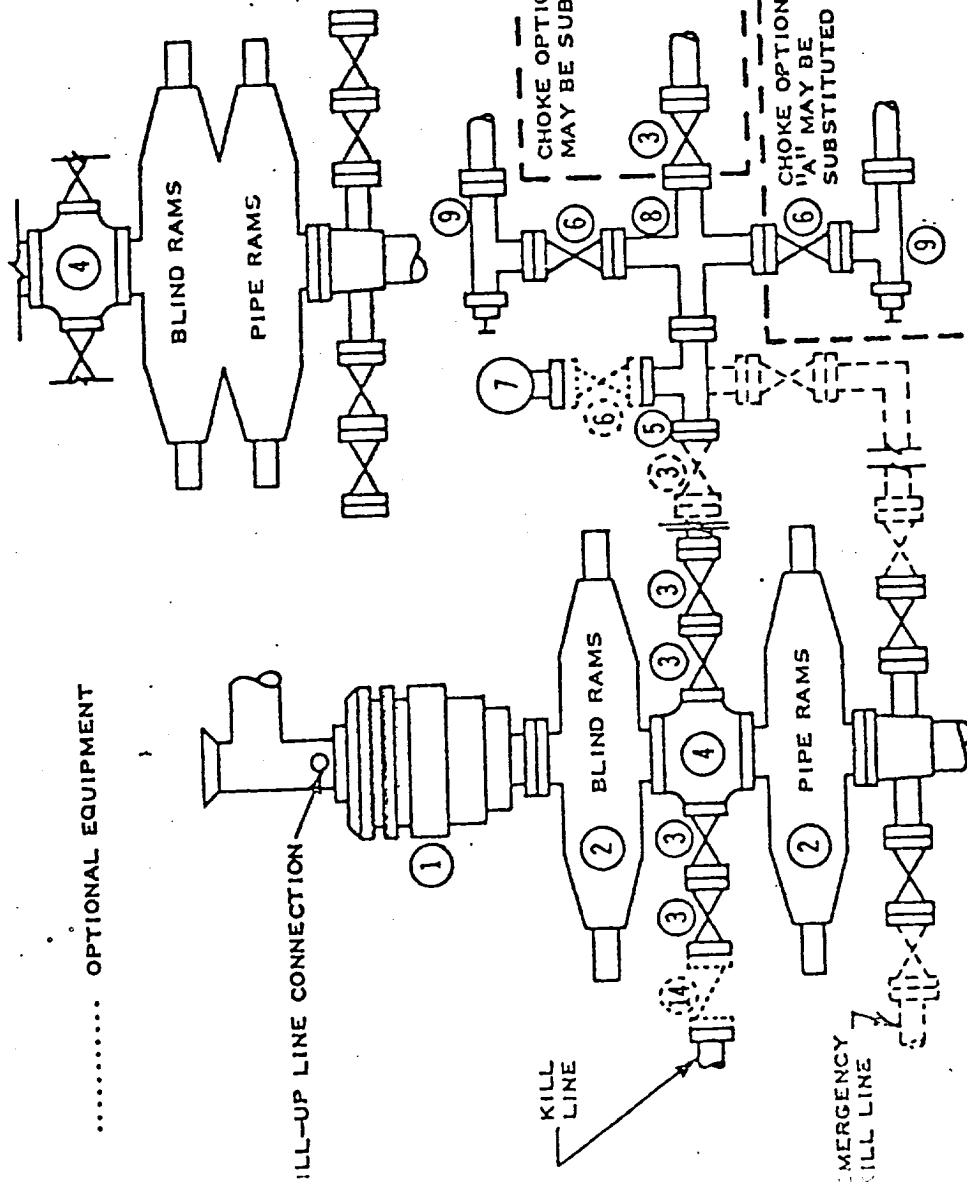

- ① SER. 1500 HYDRIL GK
- ② SER. 1500 RAM-TYPE BOP.
- ③ 3" SER. 1500 VALVE
- ④ SER. 1500 DRILLING SPOOL
- ⑤ 3" SER. 1500 X 2" SER. 1500 STEEL TEE
- ⑥ 2" SER. 1500 VALVE
- ⑦ 2" MUD PRESSURE GAUGE
- ⑧ 3" SER. 1500 X 2" SER. 1500 STEEL CROSS
- ⑨ 2" SER 1500 ADJ. CHOKE
- ⑩ 2" SER. 1500 ADJ. CHOKE ON 2" SER. 1500 RISER VALVE ON SIDE OUTLET OF 2" SER. 1500 STEEL TEE
- ⑪ ADAPTER, 2" SER. 1500 X 3 1/2" 10,000 LB WP OR OTHER FLANGE MATING INLET
- ⑫ 10,000 LB WP REMOTE CHOKE
- ⑬ HYDRAULIC CHOKE, 2500 LB WP OR BETTER
- ⑭ 3" SER. 1500 CHECK VALVE

NOTES:

1. 5000 PSI WP OR BETTER CLAMP HUBS MAY BE SUBSTITUTED FOR FLANGES
2. ONE ADJUSTABLE CHOKE MAY BE REPLACED WITH A POSITIVE CHOKE
3. VALVES MAY BE EITHER HAND OR POWER OPERATED BUT, IF POWER OPERATED, THE VALVES FLANGED TO THE BOP RUN MUST BE CAPABLE OF BEING OPENED AND CLOSED MANUALLY OR CLOSE ON POWER FAILURE AND BE CAPABLE OF BEING OPENED MANUALLY

PHILLIPS PETROLEUM COMPANY
5000 PSI WORKING PRESSURE
BLOWOUT PREVENTER HOOK-UP
(SERIES 1500 FLANGES OR BETTER)

RECEIVED
OCT 19 1962
HOLLYWOOD