

WELLS No. 2 & 3 SHARE
THE SAME PRORATION UNIT

NEW MEXICO OIL CONSERVATION COMMISSION
WELL LOCATION AND ACREAGE DEDICATION PLAT

Form C-102
Supersedes C-128
Effective 1-1-65

All distances must be from the outer boundaries of the Section.

Operator PHILLIPS PETROLEUM CO.			Lease NEW MEX "A"		Well No. 2
Unit Letter O	Section 25	Township 16 SOUTH	Range 33 EAST	County LEA	
Actual Footage Location of Well: 1983 feet from the EAST line and 661 feet from the SOUTH line					
Ground Level Elev. 4151.9'	Producing Formation Lower Wolfcamp	Pool Kemnitz Lower Wolfcamp		Dedicated Acreage: 80 Acres	

1. Outline the acreage dedicated to the subject well by colored pencil or hachure marks on the plat below.
2. If more than one lease is dedicated to the well, outline each and identify the ownership thereof (both as to working interest and royalty).
3. If more than one lease of different ownership is dedicated to the well, have the interests of all owners been consolidated by communitization, unitization, force-pooling, etc?

☐ Yes ☐ No If answer is "yes," type of consolidation _____

If answer is "no," list the owners and tract descriptions which have actually been consolidated. (Use reverse side of this form if necessary.) _____

No allowable will be assigned to the well until all interests have been consolidated (by communitization, unitization, forced-pooling, or otherwise) or until a non-standard unit, eliminating such interests, has been approved by the Commission.

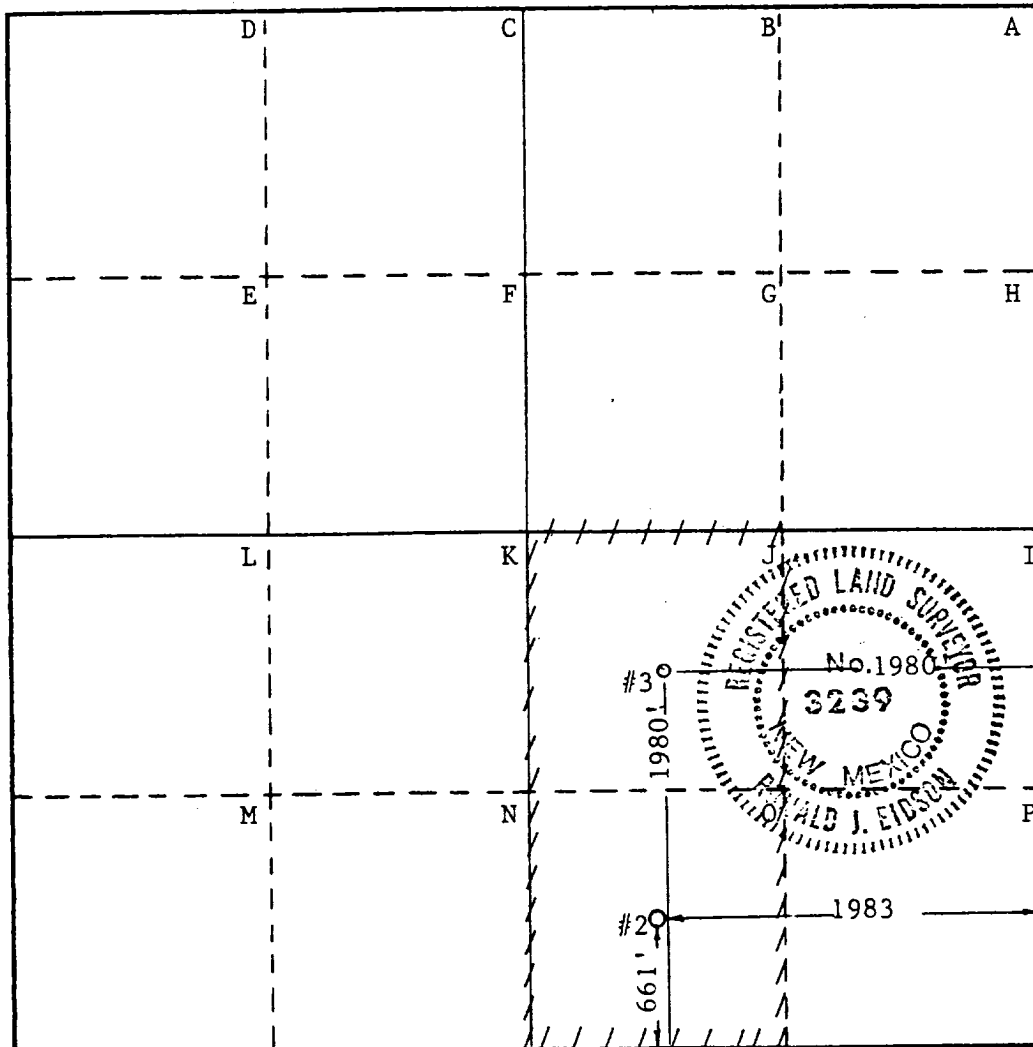

CERTIFICATION

I hereby certify that the information contained herein is true and complete to the best of my knowledge and belief.

Name
W. J. Mueller
Position
Sr. Engineering Specialist
Company
Phillips Petroleum Co.
Date
April 3, 1984

I hereby certify that the well location shown on this plat was plotted from field notes of actual surveys made by me or under my supervision, and that the same is true and correct to the best of my knowledge and belief.

Date Surveyed
October 15, 1982
Registered Professional Engineer and/or Land Surveyor
Ronald J. Eldson
Certificate No. JOHN W. WEST 676
PATRICK A. ROMERO 8863
Ronald J. Eldson 3239

RECEIVED

APR 5 1984

O.C.D.
HOBBS OFFICE



Petroleum Information

RE-ISSUED TEMPORARY COMPLETION

© Copyrighted Reproduction Prohibited

COUNTY	LEA	FIELD	Kemnitz, S.	STATE	NM																																			
OPR	PHILLIPS PETROLEUM CO.			API	30-025-01269																																			
NO	2	LEASE	New Mexico "A"	MAP																																				
	Sec 25, T16S, R33E			CO-ORD																																				
	661 FSL, 1983 FEL of Sec			RE	2-1-28 NM																																			
	10 mi NW/Buckeye			RE-SPD	11-15-82																																			
				CMP	*4-18-83																																			
CSC	<table border="1"> <thead> <tr> <th colspan="2">WELL CLASS: INIT</th> <th>DD</th> <th>FIN</th> <th>SUSLSE. CODE</th> </tr> <tr> <th>FORMATION</th> <th>DATUM</th> <th></th> <th></th> <th></th> </tr> </thead> <tbody> <tr><td></td><td></td><td></td><td></td><td></td></tr> <tr><td></td><td></td><td></td><td></td><td></td></tr> <tr><td></td><td></td><td></td><td></td><td></td></tr> <tr><td></td><td></td><td></td><td></td><td></td></tr> <tr> <td>TD</td> <td colspan="2">13,485 (MRRW)</td> <td>PBD</td> <td>*13,167</td> </tr> </tbody> </table>					WELL CLASS: INIT		DD	FIN	SUSLSE. CODE	FORMATION	DATUM																								TD	13,485 (MRRW)		PBD	*13,167
WELL CLASS: INIT		DD	FIN	SUSLSE. CODE																																				
FORMATION	DATUM																																							
TD	13,485 (MRRW)		PBD	*13,167																																				
	13 3/8-395-500 sx 8 5/8-4552-1110 sx 5 1/2-13,484-950 sx																																							

SUSPENDED OPERATIONS

CONTR	*Kenai	#23	OPRSELEV	4164 DF	sub-s 23
-------	--------	-----	----------	---------	----------

F.R. 10-25-82 OWDD
 PD 13,500 RT (Morrow)
 (Orig. D&A 8-27-58, OTD 11,610)
 11-18-82 TD 11,610; PBD 10,780; fsg
 DO to 10,780 & Stuck DP
 11-29-82 Drlg 11,693
 Recd Fish
 12-2-82 Drlg 11,977
 Drlg break 11,921-952
 12-10-82 Drlg 12,818
 Drlg break 12,209-281
 12-16-82 Drlg 13,370 sh & 1m
 mw 10.6, vis 37
 Drlg breaks 13,161-165, 13,187-194, 13,214-224,
 13,300-306
 12-21-82 TD 13,485; PBD 13,445; WOCT
 Deepened 11,610 to 13,485
 Ran 5 1/2 Csg

2-1-78 NM

COUNTY	LEA	FIELD	Kemnitz, S.	STATE	NM
OPR	PHILLIPS PETROLEUM CO.			API	30-025-01269
NO	2	LEASE	New Mexico "A"	MAP	
	Sec 25, T16S, R33E			CO-ORD	
	661 FSL, 1983 FEL of Sec			RE-	2-1-28 NM
	10 mi NW/Buckeye			SPD	11-15-82
				RE-	1-31-83
CSC	WELL CLASS: INIT DD FINSUS LSE. CODE				
13 3/8-395-500 sx	FORMATION		DATUM		
8 5/8-4552-1110 sx					
5 1/2-13,484-950 sx					
	TD 13,485 (MRRW)		PBD 13,445		

SUSPENDED OPERATIONS

CONTR	*Kenai #23	OPRSLTIV	4164 DF	sub-s	23
-------	------------	----------	---------	-------	----

F.R. 10-25-82 OWDD
 PD 13,500 RT (Morrow)
 (Orig. D&A 8-27-58, OTD 11,610)
 11-18-82 TD 11,610; PBD 10,780; fsg
 Do to 10,780 & stuck DP
 11-29-82 Drlg 11,693
 Recd Fish
 12-2-82 Drlg 11,977
 Drlg break 11,921-952
 12-10-82 Drlg 12,818
 Drlg break 12,209-281
 12-16-82 Drlg 13,370 sh & 1m
 mw 10.6, vis 37
 Drlg breaks 13,161-165, 13,187-194, 13,214-224,
 13,300-306
 12-21-82 TD 13,485; PBD 13,445; WOCT
 Deepened 11,610 to 13,485
 Ran 5 1/2 Csg

2-1-28 NM

LEA

PHILLIPS PETROLEUM CO.

Kemnitz, S.

2 New Mexico "A"

Sec 25, T16S, R33E

NM

Page #2

1-31-83

TD 13,485; PBD 13,445; Suspended Operations

LOGS RUN: GRL, CNL, DILL, CALP

2-5-83

TEMPORARY COMPLETION ISSUED

2-1-28 NM

IC 30-025-70820-82