

WELLS No. 2 & 3 SHARE  
THE SAME PROPRATION UNIT

NEW MEXICO OIL CONSERVATION COMMISSION  
WELL LOCATION AND ACREAGE DEDICATION PLAT

Form C-102  
Supersedes C-128  
Effective 1-1-65

All distances must be from the outer boundaries of the Section.

Operator PHILLIPS PETROLEUM CO.		Lease NEW MEX "A"		Well No. 3			
Unit Letter J	Section 25	Township 16 SOUTH	Range 33 EAST	County LEA			
Actual Footage Location of Well:							
1980	feet from the	EAST	line and	1980	feet from the	SOUTH	line
Ground Level Elev. 4152'	Producing Formation Lower Wolfcamp		Pool Kemnitz Lower Wolfcamp		Dedicated Acreage: 80 Acres		

1. Outline the acreage dedicated to the subject well by colored pencil or hatchure marks on the plat below.
2. If more than one lease is dedicated to the well, outline each and identify the ownership thereof (both as to working interest and royalty).
3. If more than one lease of different ownership is dedicated to the well, have the interests of all owners been consolidated by communitization, unitization, force-pooling, etc?

☐ Yes ☐ No If answer is "yes," type of consolidation \_\_\_\_\_

If answer is "no," list the owners and tract descriptions which have actually been consolidated. (Use reverse side of this form if necessary.) \_\_\_\_\_

No allowable will be assigned to the well until all interests have been consolidated (by communitization, unitization, forced-pooling, or otherwise) or until a non-standard unit, eliminating such interests, has been approved by the Commission.

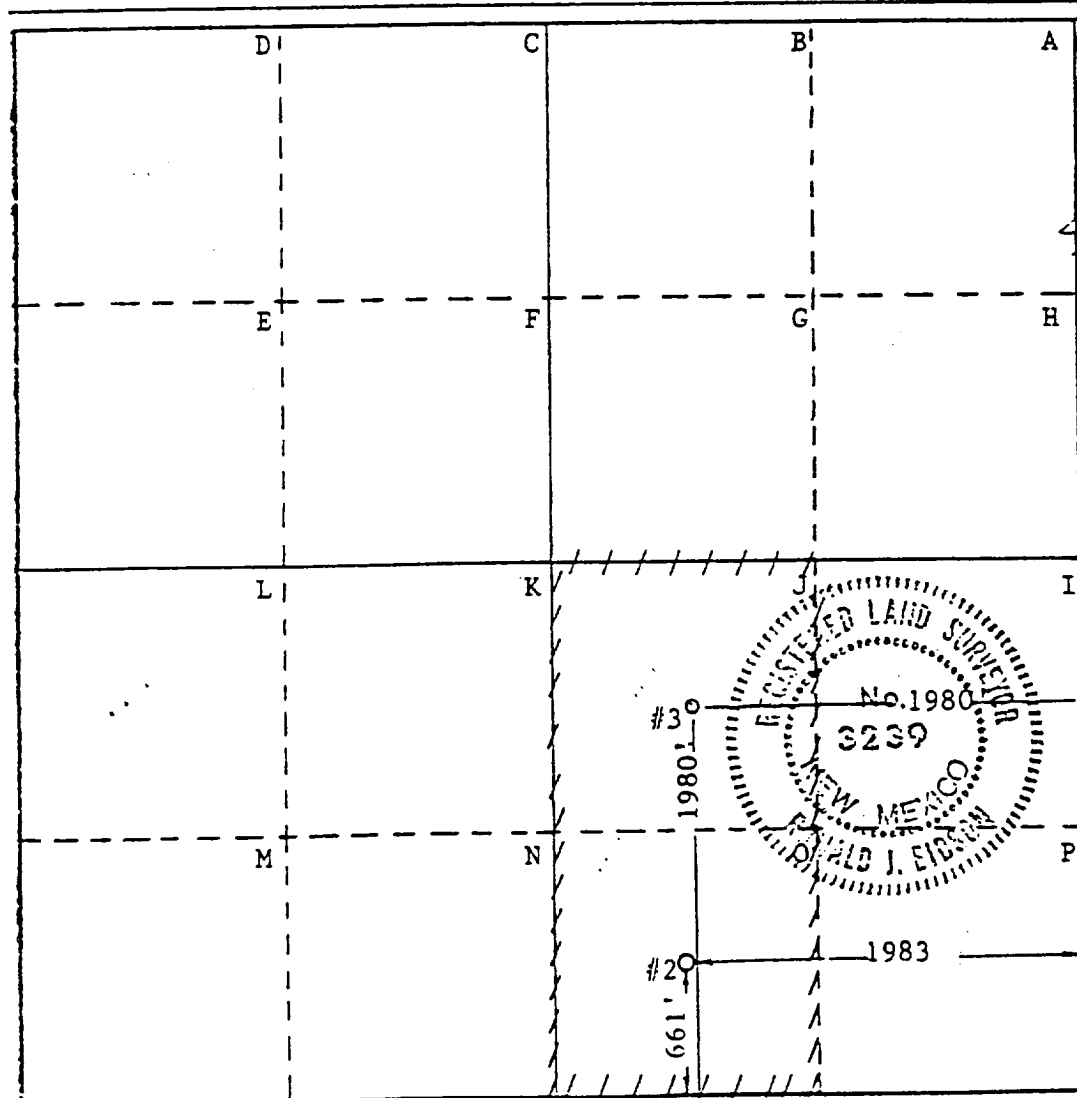

CERTIFICATION	
I hereby certify that the information contained herein is true and complete to the best of my knowledge and belief.	
Name	W. J. Mueller
Position	Sr. Engineering Specialist
Company	Phillips Petroleum Co.
Date	April 3, 1984
I hereby certify that the well location shown on this plat was plotted from field notes of actual surveys made by me or under my supervision, and that the same is true and correct to the best of my knowledge and belief.	
Date Surveyed	October 15, 1982
Registered Professional Engineer and/or Land Surveyor	
Certificate No.	JOHN R. WEST 678 PATRICK A. ROMERO 6863