

NEW MEXICO OIL CONSERVATION COMMISSION

Well Location and Acreage Dedication Plat

Section A.

Date 12-7-57

Operator Eugene Talbert Lease Phillips State
Well No. 3 Unit Letter N Section 16 Township 17 S Range 33 E NMPM
Located 1980 Feet From West Line, 660 Feet From South Line
County Lea G. L. Elevation 4187.7 Dedicated Acreage 40 Acres
Name of Producing Formation Grayburg Pool Maljamar

1. Is the Operator the only owner* in the dedicated acreage outlined on the plat below?
Yes _____ No X.
2. If the answer to question one is "no," have the interests of all the owners been consolidated by communitization agreement or otherwise? Yes _____ No X. If answer is "yes," Type of Consolidation _____
3. If the answer to question two is "no," list all the owners and their respective interests below:

Owner

Land Description

<u>Eugene Talbert</u>	<u>16/64ths</u>
<u>Roy M. Pair</u>	<u>16/64ths</u>
<u>Greenbrier 57 Limited</u>	<u>29/64ths</u>
<u>W. R. Haghey</u>	<u>1/64th</u>
<u>J. Robert Phillips, Jr.</u>	<u>1/64th</u>
<u>John Pace</u>	<u>1/64th</u>

SE/4 of the SW/4 of Section 16, Township 17 South
Range 33 East NMPM

Section B

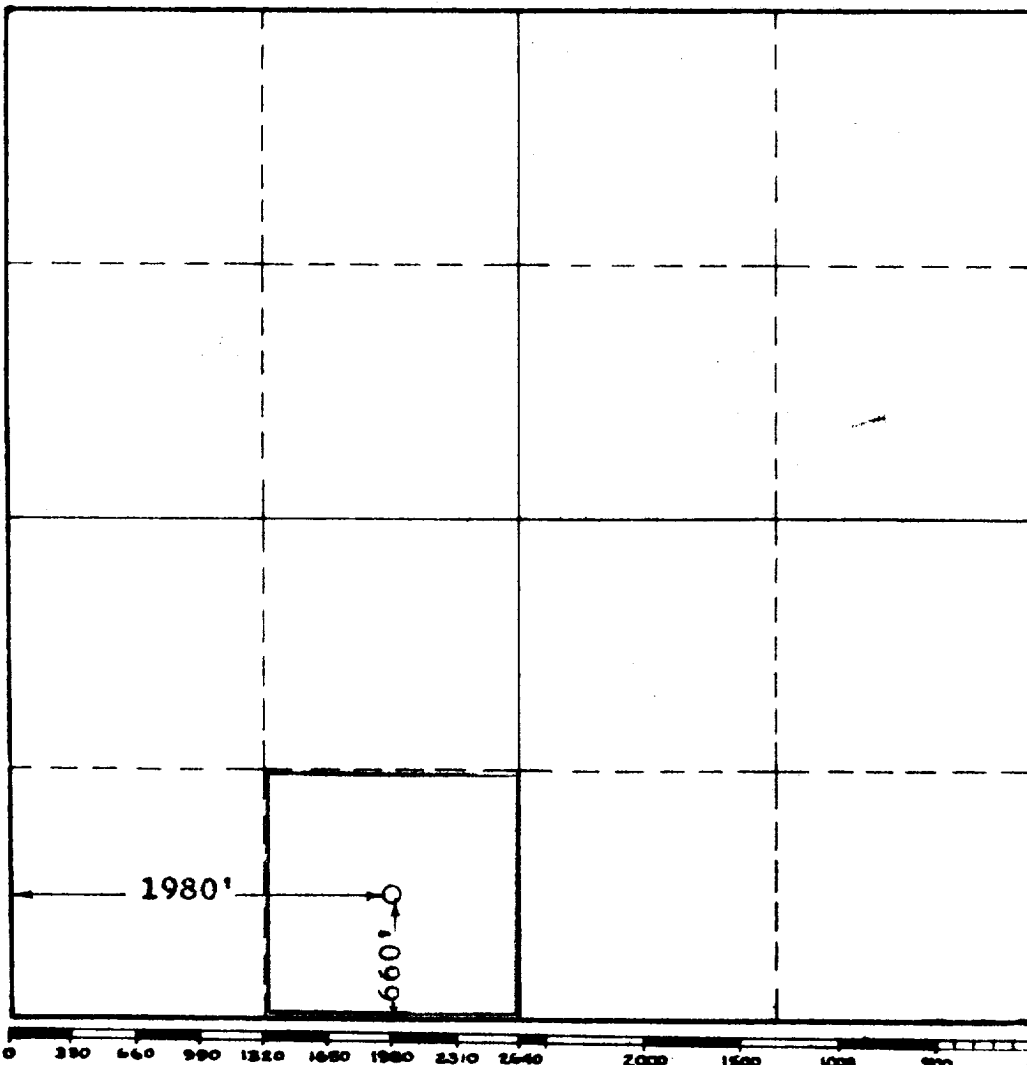

This is to certify that the information in Section A above is true and complete to the best of my knowledge and belief.

EUGENE TALBERT

(Operator)

M. R. Keeler
(Representative)

Box 2646, Hobbs, N. Mex.
Address

This is to certify that the well location shown on the plat in Section B was plotted from field notes of actual surveys made by me or under my supervision and that the same is true and correct to the best of my knowledge and belief.

Date Surveyed 12-7-57

John W. West
Registered Professional
Engineer and/or Land Surveyor.

Certificate No. 676

(See instructions for completing this form on the reverse side)