

NEW MEXICO OIL CONSERVATION COMMISSION  
Santa Fe, New Mexico

NOTICE OF INTENTION TO DRILL OR RECOMPLETE

Notice must be given to the District Office of the Oil Conservation Commission and approval obtained before drilling or recompletion begins. If changes in the proposed plan are considered advisable, a copy of this notice showing such changes will be returned to the sender. Submit this notice in QUINTUPPLICATE. One copy will be returned following approval. See additional instructions in Rules and Regulations of the Commission.

If State Land submit 6 Copies

Midland, Texas

August 28, 1957

(Place)

(Date)

OIL CONSERVATION COMMISSION  
SANTA FE, NEW MEXICO

Gentlemen:

You are hereby notified that it is our intention to commence the (Drilling) (~~Recompletion~~) of a well to be known as  
**Murphy H. Baxter**

(Company or Operator)

State "17"

(Lease)

Well No. **7**, in **0**

(Unit)

located **1980** feet from the **North** line and **1980** feet from the

**East**

line of Section **17**, T. **17-N**, R. **33-E**, NMPM.

(GIVE LOCATION FROM SECTION LINE) **Undesignated** Pool, **Lee** County

**11-2148**

If State Land the Oil and Gas Lease is No.

If patented land the owner is

Address

We propose to drill well with drilling equipment as follows: **Rotary**

The status of plugging bond is **Approved**

Drilling Contractor **Midland Drilling Company**

We intend to complete this well in the **Grayburg** formation at an approximate depth of **4500** feet.

CASING PROGRAM

We propose to use the following strings of Casing and to cement them as indicated:

Size of Hole	Size of Casing	Weight per Foot	New or Second Hand	Depth	Sacks Cement
<b>12-1/4"</b>	<b>8-5/8"</b>	<b>21.6</b>	<b>New</b>	<b>320'</b>	<b>225</b>
<b>7-5/8"</b>	<b>5-3/8"</b>	<b>11.6 &amp; 25.5</b>	<b>New</b>	<b>4500'</b>	<b>300</b>

If changes in the above plans become advisable we will notify you immediately.

ADDITIONAL INFORMATION (If recompletion give full details of proposed plan of work.)

Approved....., 19.....  
Except as follows:

CEMENT MUST BE CIRCULATED BEHIND

OIL CONSERVATION COMMISSION

By.....

Sincerely yours,

**Murphy H. Baxter**  
(Company or Operator)  
By.....  
Position.....  
Name.....  
Address.....

NEW MEXICO OIL CONSERVATION COMMISSION

Well Location and Acreage Dedication Plat

Section A.

Date 7-19-57

Operator Murphy H. Baxter Lease 1980 State 17 03  
Well No. 7 Unit Letter G Section 17 Township 17 S Range 33 E NMPM  
Located 1980 Feet From North Line, 1980 Feet From East Line  
County Lea G. L. Elevation 4204.10 Dedicated Acreage 10 Acres  
Name of Producing Formation San Juan Pool San Juan

1. Is the Operator the only owner\* in the dedicated acreage outlined on the plat below?  
Yes 1 No       .
2. If the answer to question one is "no," have the interests of all the owners been consolidated by communitization agreement or otherwise? Yes        No       . If answer is "yes," Type of Consolidation
3. If the answer to question two is "no," list all the owners and their respective interests below:

Owner

Land Description

Section B

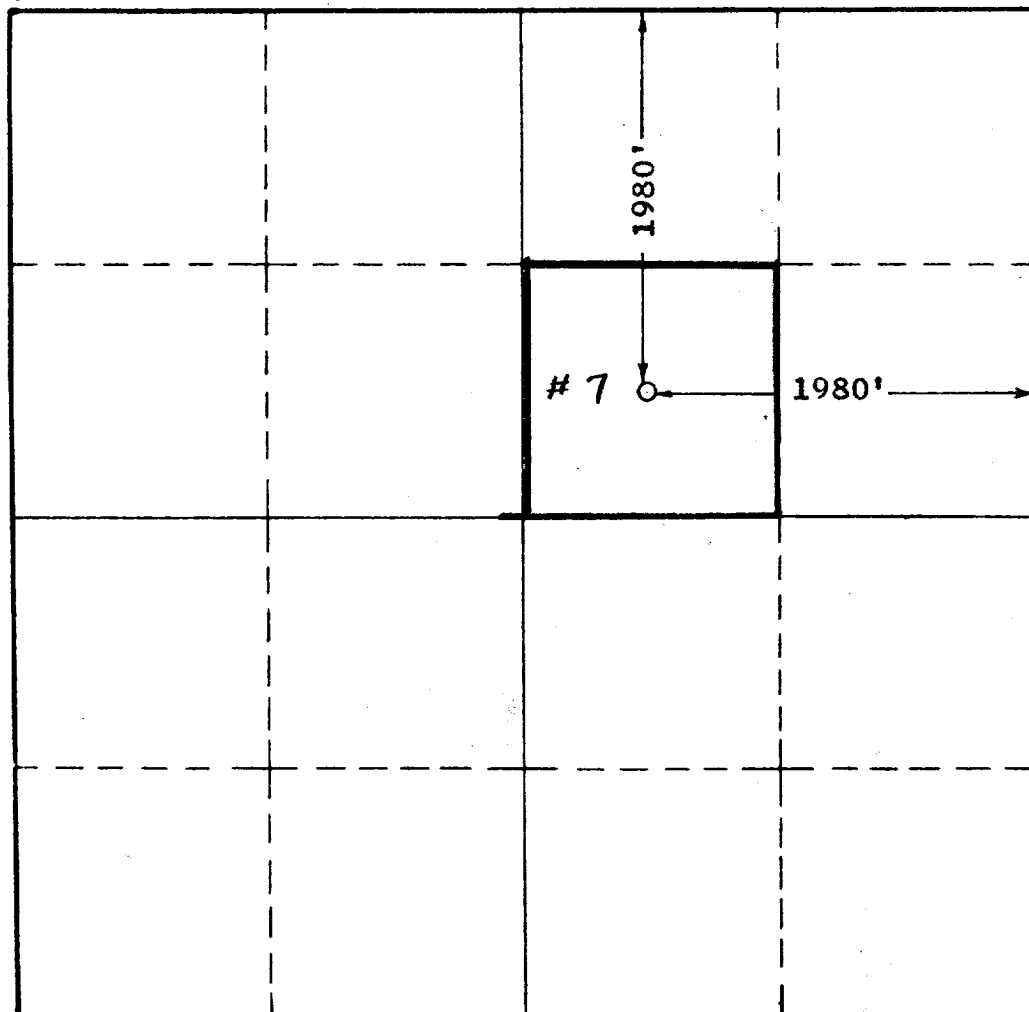

This is to certify that the information in Section A above is true and complete to the best of my knowledge and belief.

Murphy H. Baxter  
(Operator)

[Signature]  
(Representative)

222 E. Big Spring, Midland, Tex  
Address

This is to certify that the well location shown on the plat in Section B was plotted from field notes of actual surveys made by me or under my supervision and that the same is true and correct to the best of my knowledge and belief.

Date Surveyed 7-19-57

John W. Wet  
Registered Professional  
Engineer and/or Land Surveyor.

Certificate No. 676

(See instructions for completing this form on the reverse side)