

NEW MEXICO  
OIL CONSERVATION COMMISSION

Form C-128

WELLS OFFICE 000  
APR 23 1956  
DUPLICATE

Well Location and/or Gas Proration Plat Date 4-22-56

Operator Western Oil Fields, Inc. Lease Phillips State

Well No. 13 Section 14 Township 17 S Range 33 E NMPM

Located 1650 Feet From South Line, 1930 Feet From East Line,

Lea County, New Mexico. G. L. Elevation \_\_\_\_\_

Name of Producing Formation \_\_\_\_\_ Pool \_\_\_\_\_ Dedicated Acreage \_\_\_\_\_

(Note: All distances must be from outer boundaries of Section)

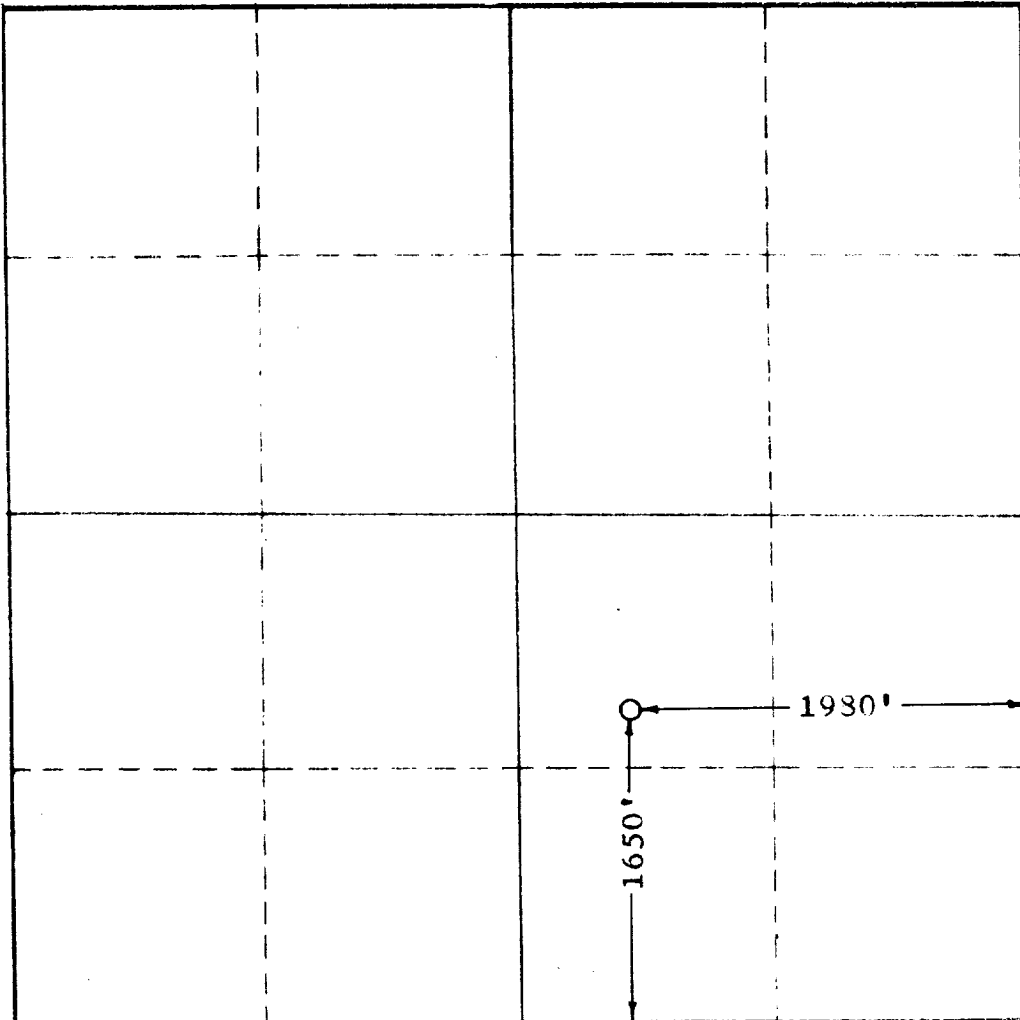

SCALE: 1"=1000'

1. Is this Well a Dual Comp. ? Yes      No     .
2. If the answer to Question 1 is yes, are there any other dually completed wells within the dedicated acreage? Yes      No

This is to certify that the above plat was prepared from field notes of actual surveys made by me or under my supervision and that the same are true and correct to the best of my knowledge and belief.

Name \_\_\_\_\_  
Position \_\_\_\_\_  
Representing \_\_\_\_\_  
Address \_\_\_\_\_

Date Surveyed 4-22-56  
John W. West  
Registered Professional Engineer and/or  
Land Surveyor