

NEW MEXICO OIL CONSERVATION COMMISSION
Santa Fe, New Mexico

Form C-101
Revised (12/1/55)

NOTICE OF INTENTION TO DRILL

Notice must be given to the District Office of the Oil Conservation Commission and approval obtained before drilling or recompletion begins. If changes in the proposed plan are considered advisable, a copy of this notice showing such changes will be returned to the sender. Submit this notice in QUINTUPLICATE. One copy will be returned following approval. See additional instructions in Rules and Regulations of the Commission. If State Land submit 6 Copies Attach Form C-128 in triplicate to first 3 copies of form C-101

Midland, Texas

June 2, 1958

(Place)

(Date)

OIL CONSERVATION COMMISSION
SANTA FE, NEW MEXICO

Gentlemen:

You are hereby notified that it is our intention to commence the Drilling of a well to be known as

Zapata Petroleum Corporation

(Company or Operator)

Phillips - State B

(Lease)

Well No. **5**

"B"

(Unit)

The well is

located **660** feet from the **North** line and **1980** feet from the

East

line of Section **19**, T. **17-S**, R. **33-E**, NMPM.

(GIVE LOCATION FROM SECTION LINE)

Maljamar

Pool,

Lea

County

B-2148

If State Land the Oil and Gas Lease is No.

If patented land the owner is.

Address.

We propose to drill well with drilling equipment as follows:

Ensco GA-250

The status of plugging bond is **current - on deposit with O.C.C. @ Santa Fe, New Mexico**

Drilling Contractor **Zapata Drilling Company**

Box 3195

Midland, Texas

We intend to complete this well in the **Grayburg - San Andres**

formation at an approximate depth of **4500** feet.

CASING PROGRAM

We propose to use the following strings of Casing and to cement them as indicated:

Size of Hole	Size of Casing	Weight per Foot	New or Second Hand	Depth	Sacks Cement
11"	8 5/8"	36#	Second Hand	350	175
7 7/8"	5 1/2"	14#	New	4500	175

If changes in the above plans become advisable we will notify you immediately.

ADDITIONAL INFORMATION (If recompletion give full details of proposed plan of work.)

Approved....., 19.....
Except as follows:

By

OIL CONSERVATION COMMISSION

Sincerely yours,

Zapata Petroleum Corporation

(Company or Operator)

By

Position

Engineer

Send Communications regarding well to

Name **Zapata Petroleum Corporation**

Address **Box 3195, Midland, Texas**

NEW MEXICO OIL CONSERVATION COMMISSION

Well Location and Acreage Dedication Plat

Section A.

Date June 2, 1958

Operator ZAPATA PETROLEUM CORPORATION Lease PHILLIPS-Strube of New Mexico "B"
Well No. 5 Unit Letter B Section 19 Township 17 South Range 33 East NMPM
Located 660 Feet From North Line, 1980 Feet From East Line
County Lea G. L. Elevation 4150.5 Dedicated Acreage 40 Acres
Name of Producing Formation Grayburg Pool Maljamar

1. Is the Operator the only owner* in the dedicated acreage outlined on the plat below?
Yes x No .
2. If the answer to question one is "no," have the interests of all the owners been consolidated by communitization agreement or otherwise? Yes No . If answer is "yes," Type of Consolidation
3. If the answer to question two is "no," list all the owners and their respective interests below:

Owner

Land Description

Section B

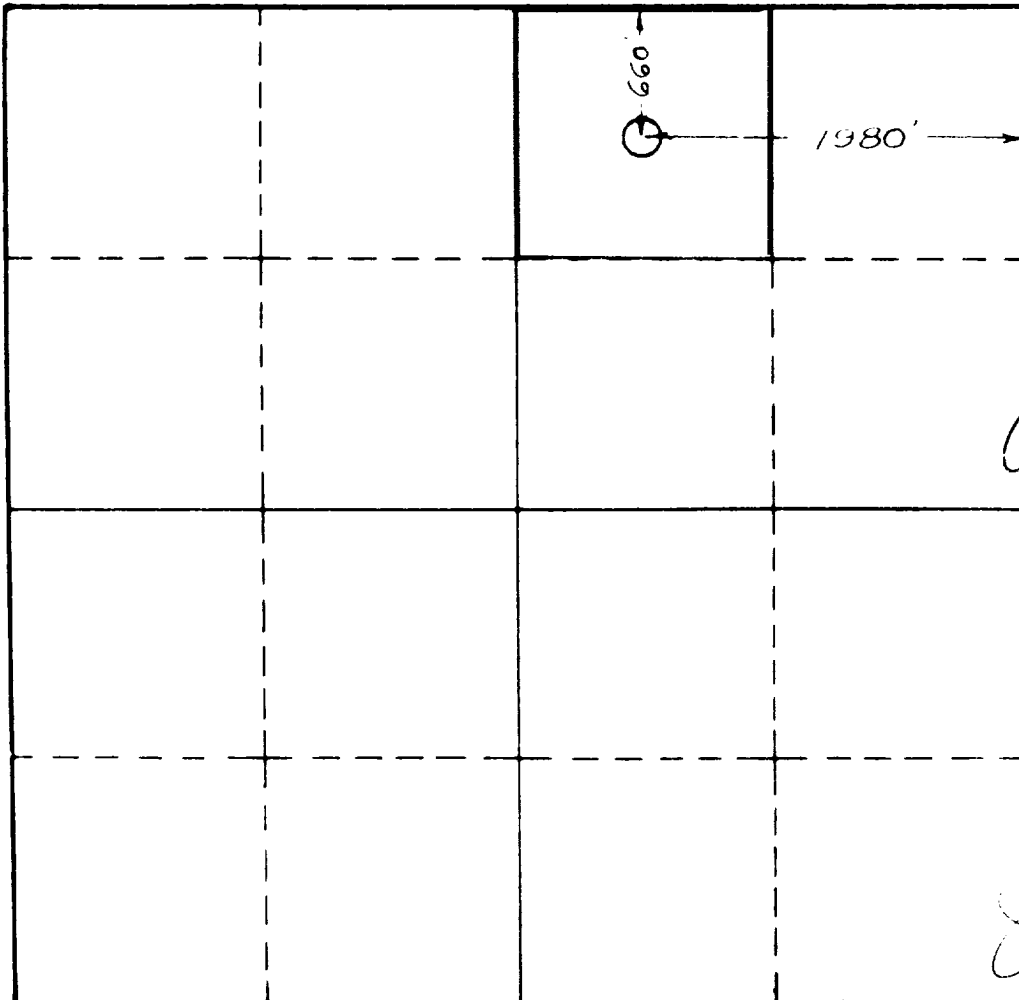

This is to certify that the information in Section A above is true and complete to the best of my knowledge and belief.

ZAPATA PETROLEUM CORPORATION
(Operator)

James L. Wood
(Representative)

Box 2216, Midland, Texas
Address

This is to certify that the well location shown on the plat in Section B was plotted from field notes of actual surveys made by me or under my supervision and that the same is true and correct to the best of my knowledge and belief.

Date Surveyed Feb. 1, 1958

John W. Shuman
Registered Professional
Engineer and/or Land Surveyor.

Certificate No. 1559

(See instructions for completing this form on the reverse side)