

NEW MEXICO OIL CONSERVATION COMMISSION

Well Location and Acreage Dedication Plat

Section A.

Date 1958 JAN 23 OFFICE OCC

Operator ZAPATA PETROLEUM CORPORATION Lease Phillips-State of New Mexico "B"
Well No. 8 Unit Letter Q Section 19 Township 17 South Range 183 East NMPM
Located 660 Feet From South Line, 1980 Feet From East Line
County Lea G. L. Elevation 4071.6 Dedicated Acreage 40 Acres
Name of Producing Formation Grayburg Pool Maljamar

1. Is the Operator the only owner* in the dedicated acreage outlined on the plat below?
Yes X No .
2. If the answer to question one is "no," have the interests of all the owners been consolidated by communitization agreement or otherwise? Yes No . If answer is "yes," Type of Consolidation
3. If the answer to question two is "no," list all the owners and their respective interests below:

Owner

Land Description

Section B

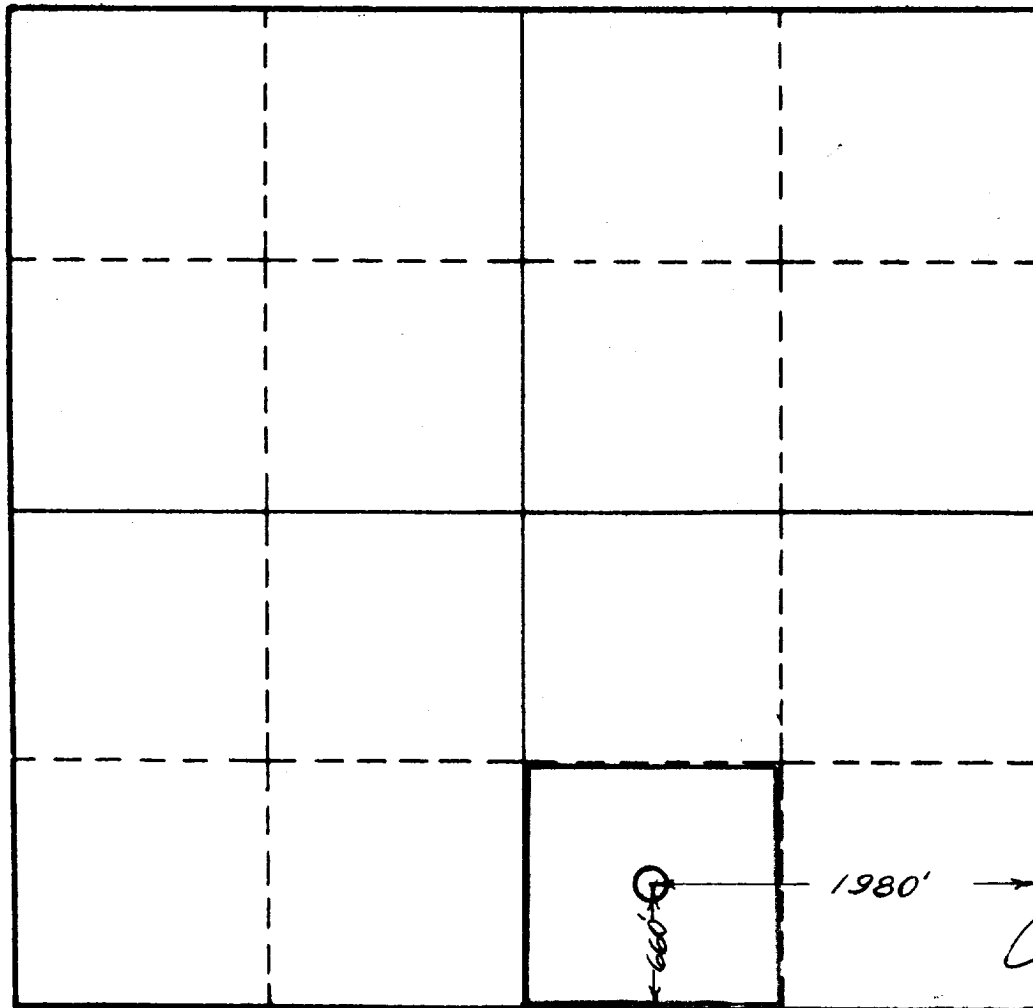

This is to certify that the information in Section A above is true and complete to the best of my knowledge and belief.

ZAPATA PETROLEUM CORPORATION
(Operator)
[Signature]
(Representative)

Box 2216, Midland, Texas
Address

This is to certify that the well location shown on the plat in Section B was plotted from field notes of actual surveys made by me or under my supervision and that the same is true and correct to the best of my knowledge and belief.

Date Surveyed Jan. 21, 1958

[Signature]
Registered Professional
Engineer and/or Land Surveyor.

Certificate No. 1559