

NEW MEXICO OIL CONSERVATION COMMISSION
Santa Fe, New Mexico

Form C-101
Revised (12/1/55)

Lease No. 163696

NOTICE OF INTENTION TO DRILL

Notice must be given to the District Office of the Oil Conservation Commission and approval obtained before drilling or recompletion begins. If changes in the proposed plan are considered advisable, a copy of this notice showing such changes will be returned to the sender. Submit this notice in QUINTUPPLICATE. One copy will be returned following approval. See additional instructions in Rules and Regulations of the Commission. If State Land submit 6 Copies Attach Form C-128 in triplicate to first 3 copies of form C-101

Midland, Texas

(Place)

March 15, 1960

(Date)

OIL CONSERVATION COMMISSION
SANTA FE, NEW MEXICO

Gentlemen:

You are hereby notified that it is our intention to commence the Drilling of a well to be known as
TEXACO Inc.

(Company or Operator)

M. Arreguy

(Lease)

Well No. **1**, in **0** (Unit) The well is

located **1980** feet from the **North** line and **1980** feet from the

East

line of Section **13**, T-**15-S**, R-**34-E**, NMPM.

(GIVE LOCATION FROM SECTION LINE)

~~San Juan~~ **Wildcat** Pool, **Lea** County

D	C	B	A
E	F	G	H
L	K	J	I
M	N	O	P

If State Land the Oil and Gas Lease is No. ---

If patented land the owner is **Mr. Martin Arreguy**

Address **P.O. Box 277, Lovington, New Mexico**

We propose to drill well with drilling equipment as follows: **Rotary**

The status of plugging bond is **\$10,000 blanket surety bond of Maryland Casualty Co. has been filed with State Geologist.**

Drilling Contractor **Not yet known**

We intend to complete this well in the **Pennsylvanian** formation at an approximate depth of **11,200** feet.

CASING PROGRAM

We propose to use the following strings of Casing and to cement them as indicated:

Size of Hole	Size of Casing	Weight per Foot	New or Second Hand	Depth	Sacks Cement
17-1/2"	13-3/8"	48#	New	350'	350
12-1/4"	9-5/8"	36#	New	4650'	1800
8-3/4"	5-1/2"	17 & 20#	New	11,000'	300

If changes in the above plans become advisable we will notify you immediately.

ADDITIONAL INFORMATION (If recompletion give full details of proposed plan of work.)

FORMATIONS EXPECTED:
Top of Yates **2950'**
" " San Andres **4520'**
" " Glorieta **6010'**
Top of Tubb **7260'**
" " Abo **8004'**
" " Wolfcamp **9750'**
" " Cisco **10,340'**

Approved: **MAH**, 19.....
Except as follows:

Sincerely yours,

TEXACO Inc.

(Company or Operator)

By

J. J. Velten

Position **Division Civil Engineer**

Send Communications regarding well to

Name **J. H. Markley**

Address **P.O. Box 3100, Midland, Texas**

OIL CONSERVATION COMMISSION

By

NEW MEXICO OIL CONSERVATION COMMISSION
WELL LOCATION AND ACREAGE DEDICATION PLAT

FORM C-128
Revised 5/1/57

SEE INSTRUCTIONS FOR COMPLETING THIS FORM ON THE REVERSE SIDE

SECTION A

Operator TEXACO Inc.			Lease M. Arreguy		Well No. 1
Unit Letter G	Section 13	Township 15 South	Range 34 East	County Lea	
Actual Footage Location of Well: 1980 feet from the North line and 1980 feet from the East line Sec. 13					
Ground Level Elev. 4056	Producing Formation Pennsylvanian		Pool Wildcat	Dedicated Acreage: 40 Acres	

Ref: GLO plat dated 5-15-14

1. Is the Operator the only owner in the dedicated acreage outlined on the plat below? YES ☒ NO ____ ("Owner" means the person who has the right to drill into and to produce from any pool and to appropriate the production either for himself or for himself and another. (65-3-29 (e) NMSA 1935 Comp.)
2. If the answer to question one is "no," have the interests of all the owners been consolidated by communitization agreement or otherwise? YES ____ NO ____ If answer is "yes," Type of Consolidation ____
3. If the answer to question two is "no," list all the owners and their respective interests below:

Owner	Land Description

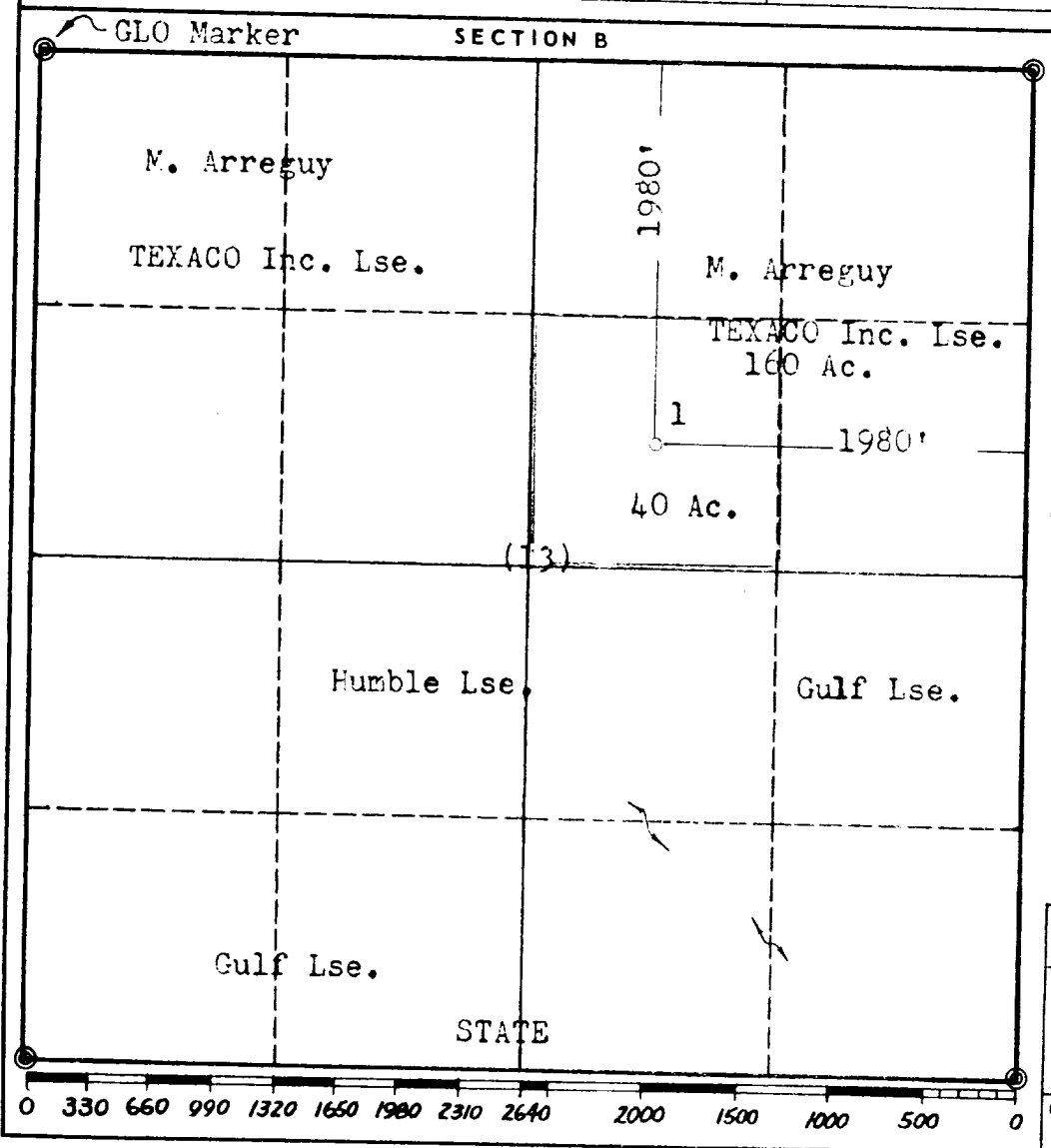

CERTIFICATION

I hereby certify that the information in SECTION A above is true and complete to the best of my knowledge and belief.

Name
J. J. Velten

Position
Division Civil Engineer

Company
TEXACO Inc.

Date
3/15/60

I hereby certify that the well location shown on the plat in SECTION B was plotted from field notes of actual surveys made by me or under my supervision, and that the same is true and correct to the best of my knowledge and belief.

Date Surveyed
3-14-60

Registered Professional Engineer and/or Land Surveyor
J. J. Velten

Certificate No.
8174