

NEW MEXICO OIL CONSERVATION COMMISSION
Santa Fe, New Mexico

Form C-101
Revised (12/1/55)

NOTICE OF INTENTION TO DRILL

Notice must be given to the District Office of the Oil Conservation Commission and approval obtained before drilling or recompletion begins. If changes in the proposed plan are considered advisable, a copy of this notice, showing such changes will be returned to the sender. Submit this notice in QUINTUPLICATE. One copy will be returned following approval. See additional instructions in Rules and Regulations of the Commission. If State Land submit 6 Copies Attach Form C-128 in triplicate to first 3 copies of form C-101

Fort Worth, Texas

November 13, 1959

(Place)

(Date)

OIL CONSERVATION COMMISSION
SANTA FE, NEW MEXICO

Gentlemen:

You are hereby notified that it is our intention to commence the Drilling of a well to be known as

The Pure Oil Company

(Company or Operator)

State-Lea "Q"

(Lease)

Well No. 2, in J The well is

(Unit)

located 1980 feet from the South line and 1650 feet from the East line of Section 7, T. 16-S, R. 34-E, NMPM.

(GIVE LOCATION FROM SECTION LINE)

Queen

Pool,

Lea

County

00-265

If State Land the Oil and Gas Lease is No.

If patented land the owner is

Address

We propose to drill well with drilling equipment as follows: Rotary Tools

The status of plugging bond is \$ 10,000 joint bond with Phillips Petroleum Company

Drilling Contractor Unknown at this time. Will advise later.

We intend to complete this well in the Queen formation at an approximate depth of 4,000 feet.

CASING PROGRAM

We propose to use the following strings of Casing and to cement them as indicated:

Size of Hole	Size of Casing	Weight per Foot	New or Second Hand	Depth	Sacks Cement (cement to surface)
11"	8-5/8"	24# J-55	New	350'	250 sx.
7-7/8"	5-1/2"	14# J-55	New	4000'	200 sx.

If changes in the above plans become advisable we will notify you immediately.

ADDITIONAL INFORMATION (If recompletion give full details of proposed plan of work.)

Approved, 19.....
Except as follows:

OIL CONSERVATION COMMISSION

By

Sincerely yours,

THE PURE OIL COMPANY

(Company or Operator)

By

Assistant Division Manager

Send Communications regarding well to

Name The Pure Oil Company

Address P. O. Box 2107, Fort Worth 1, Texas

NEW MEXICO OIL CONSERVATION COMMISSION
WELL LOCATION AND ACREAGE DEDICATION PLAT

FORM C-128
Revised 5/1/57

SEE INSTRUCTIONS FOR COMPLETING THIS FORM ON THE REVERSE SIDE

SECTION A

Operator Pure Oil Company		Date NOV 15 AM 7:22 Lea State		Well No. 2
Unit Letter J	Section 7	Township 10 South	Range 34 East	County Lea
Actual Footage Location of Well: 1450 feet from the East line and 1980 feet from the South line				
Ground Level Elev. 1150.3	Producing Formation Queen	Pool None Queen	Dedicated Acreage: 40 Acres	

1. Is the Operator the only owner in the dedicated acreage outlined on the plat below? YES Yes NO _____. ("Owner" means the person who has the right to drill into and to produce from any pool and to appropriate the production either for himself or for himself and another. (65-3-29 (e) NMSA 1935 Comp.)
2. If the answer to question one is "no," have the interests of all the owners been consolidated by communitization agreement or otherwise? YES ____ NO _____. If answer is "yes," Type of Consolidation _____
3. If the answer to question two is "no," list all the owners and their respective interests below:

Owner	Land Description

SECTION B

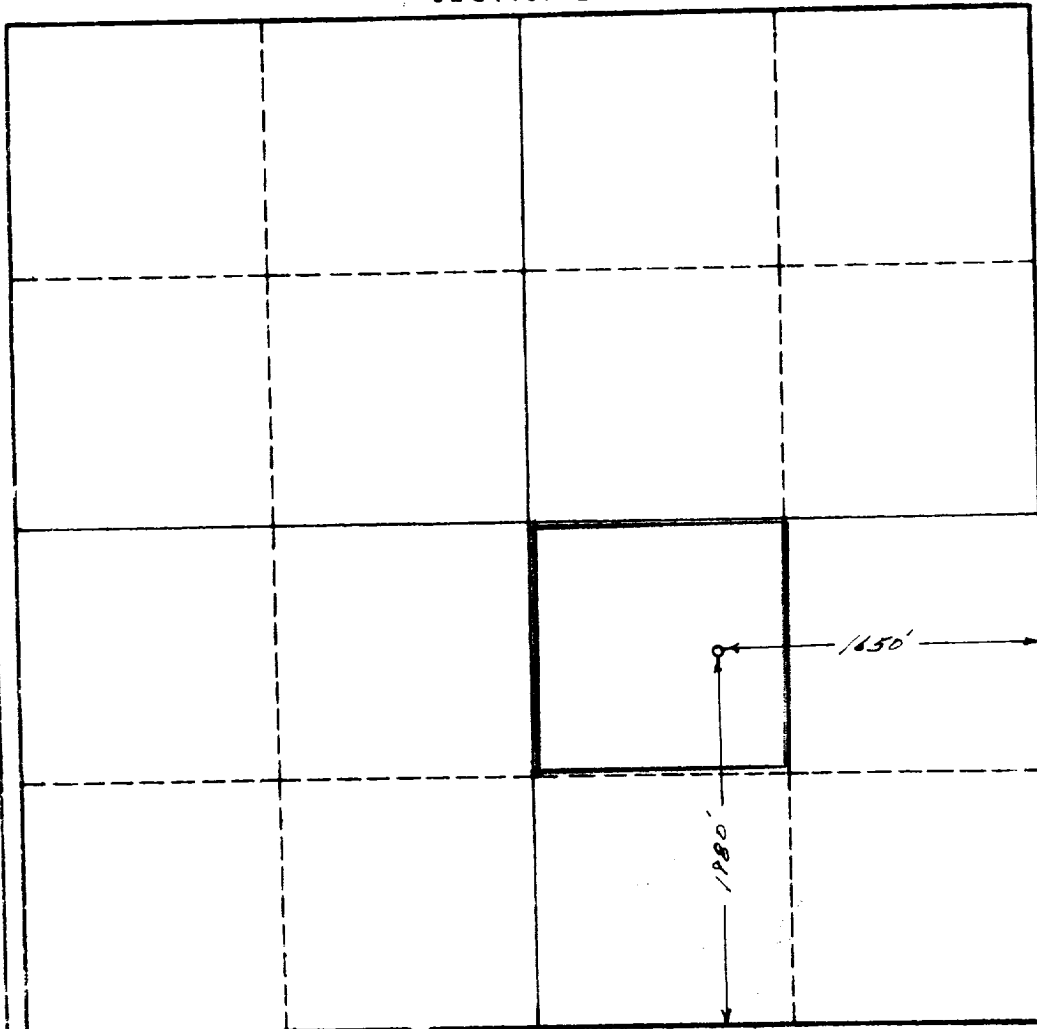

CERTIFICATION

I hereby certify that the information in SECTION A above is true and complete to the best of my knowledge and belief.

L. L. McDonald
Name
L. L. McDonald
Position
Asst. Division Manager
Company
The Pure Oil Company
Date
November 13, 1959

I hereby certify that the well location shown on the plat in SECTION B was plotted from field notes of actual surveys made by me or under my supervision, and that the same is true and correct to the best of my knowledge and belief.

Date Surveyed
11-1-59
Registered Professional Engineer
and/or Land Surveyor, JOHN W. WEST
John W. West
Certificate No.
N.M. - P.E. & L.S. NO. 576