

WELL LOCATION AND ACREAGE DEDICATION PLAT

SEE INSTRUCTIONS FOR COMPLETING THIS FORM ON THE REVERSE SIDE

SECTION A

Operator Pure Oil Co.		Lease State Lease		1960 JAN 18 AM 10:10		Well No. 10:10
Unit Letter H	Section 7	Township 16 South	Range 34 East	County Lea County		
Actual Footage Location of Well: 2310' feet from the North line and 990' feet from the East line						
Ground Level Elev. 4149.2	Producing Formation Queen		Pool Queen		Dedicated Acreage: 40 Acres	

1. Is the Operator the only owner in the dedicated acreage outlined on the plat below? YES X NO ____ ("Owner" means the person who has the right to drill into and to produce from any pool and to appropriate the production either for himself or for himself and another. (65-3-29 (e) NMSA 1935 Comp.)
2. If the answer to question one is "no," have the interests of all the owners been consolidated by communitization agreement or otherwise? YES ____ NO ____ If answer is "yes," Type of Consolidation ____
3. If the answer to question two is "no," list all the owners and their respective interests below:

Owner	Land Description

SECTION B

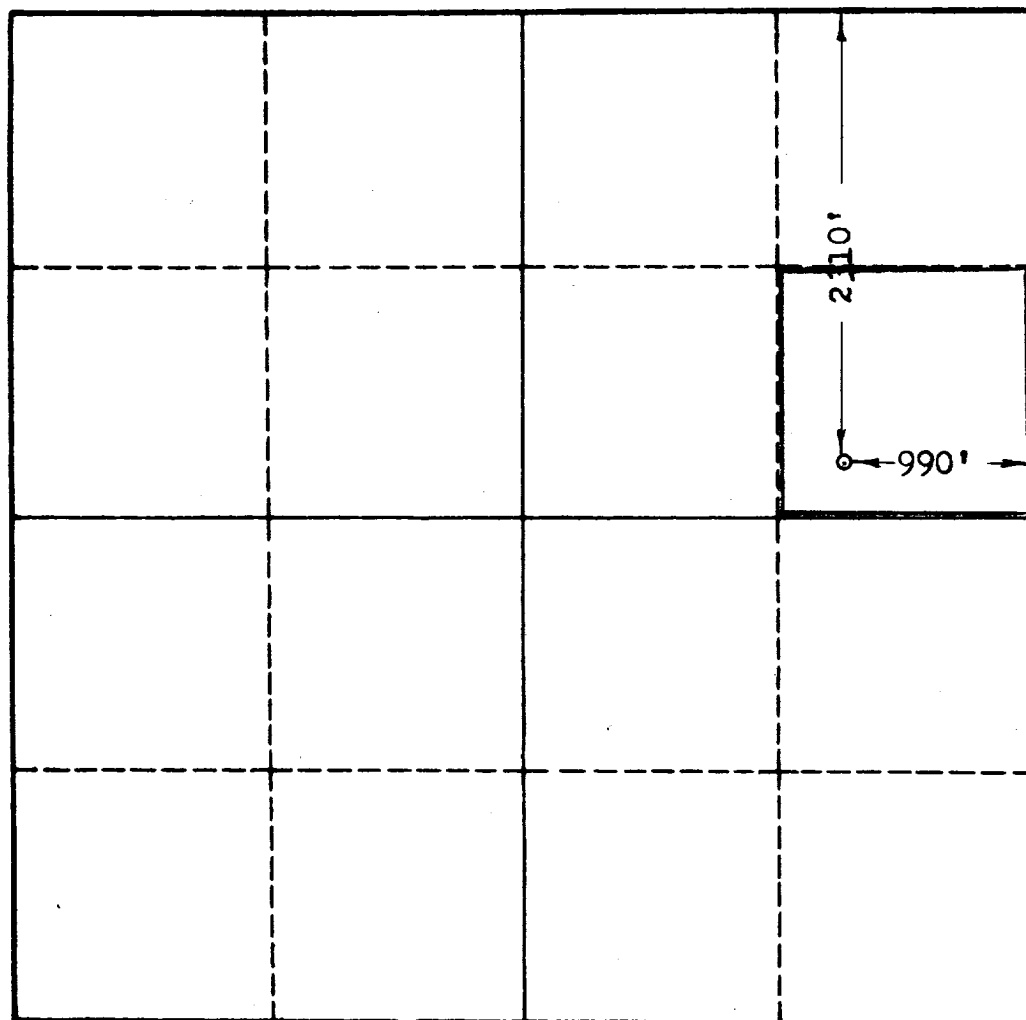

CERTIFICATION

I hereby certify that the information in SECTION A above is true and complete to the best of my knowledge and belief.

Name
J. T. Bures

Position
Dist. Production Engineer

Company
The Pure Oil Company

Date
January 15, 1960

I hereby certify that the well location shown on the plat in SECTION B was plotted from field notes of actual surveys made by me or under my supervision, and that the same is true and correct to the best of my knowledge and belief.

Date Surveyed
1-13-60

Registered Professional Engineer and/or Land Surveyor, JOHN W. WEST

Certificate No.
JOHN W. WEST

N.M. - P.E. & L.S. - NO. 878

0 330 660 990 1320 1650 1980 2310 2640 2000 1500 1000 500 0