

COUNTY LEA FIELD Kemnitz STATE NM MN 019' WO
 OPR MARATHON OIL CO. MAP
 1 State "SE"
 Sec 16, T-16-S, R-34-E CO-ORD
 660' FSL, 1980' FWL of Sec.

CLASS		EL	
Re-Cmp 2-10-68	FORMATION	DATUM	FORMATION
LOGS & SX - TUBING			
13 3/8" at 371' w/300 sx			
9 5/8" at 4560' w/1930 sx			
5 1/2" at 10,817' w/300 sx			
LOGS EL GR RA IND HC A			
	TD 10,818'; PBD 10,610';		

TEMPORARILY ABANDONED

Distribution limited and publication prohibited by subscribers' agreement.
 Reproduction rights reserved by Williams & Lee Scouting Service, Inc.

CONT. PROP DEPTH 8819' TYPE WO
 DATE

F.R.C. 3-21-69
 PD 8819' WO
 (Orig. The Ohio Oil Co. #1 Ohio-Cities Service
 "SE", comp 5-5-57 thru Perfs 10,732-782',
 GTD 10,818'; PBD 10,784')
 3-19-69 TD 10,818'; PBD 10,610'; TEMPORARILY ABANDONED
 Set Ret @ 10,610'
 Sqzd (10,732-782') w/100 sx
 Perf 8802-08', 8812-19' w/1 SPF
 Acid (8802-8819') 2000 gals
 Non Productive (8802-19')
 3-21-69 COMPLETION REPORTED

NEW MEXICO OIL CONSERVATION COMMISSION
Well Location and Acreage Dedication Plat

Section A.

Date June 13, 1957

Operator The Ohio Oil Company Lease Ohio-Cities Service State "SB"
Well No. 1 Unit Letter N Section 16 Township 16S Range 34E NMPM
Located 1980 Feet From West Line, 660 Feet From South Line
County Lea G. L. Elevation 4114.7 Dedicated Acreage 80 Acres
Name of Producing Formation Townsend Pool Kemnitz Wolfcamp

1. Is the Operator the only owner* in the dedicated acreage outlined on the plat below?
Yes _____ No X.
2. If the answer to question one is "no," have the interests of all the owners been consolidated by communitization agreement or otherwise? Yes X No _____. If answer is "yes," Type of Consolidation Drilling Agreement
3. If the answer to question two is "no," list all the owners and their respective interests below:

Owner

Land Description

Section B

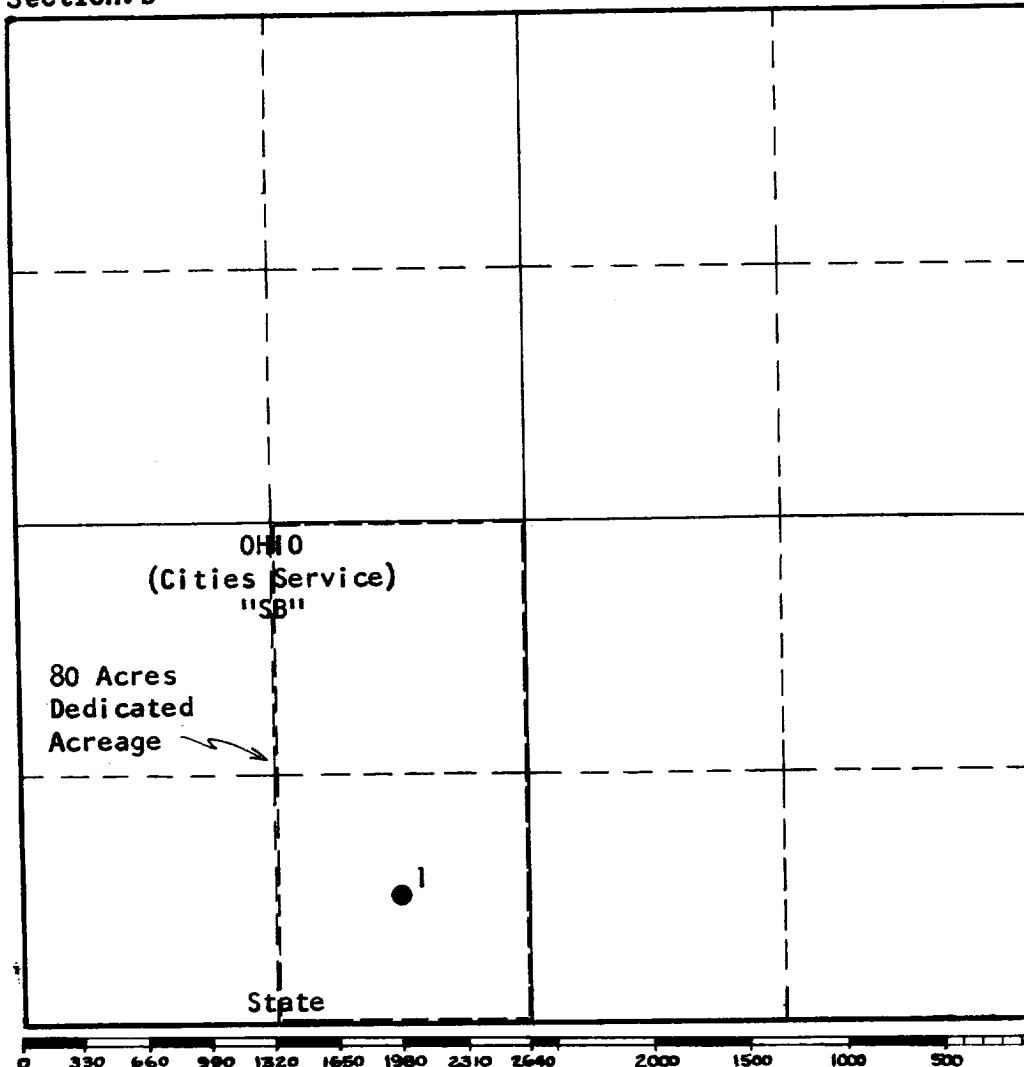

This is to certify that the information in Section A above is true and complete to the best of my knowledge and belief.

The Ohio Oil Company

(Operator)

Thomas O. Webb

(Representative)

Box 2107, Hobbs, New Mexico

Address

This is to certify that the well location shown on the plat in Section B was plotted from field notes of actual surveys made by me or under my supervision and that the same is true and correct to the best of my knowledge and belief.

Date Surveyed _____

Registered Professional
Engineer and/or Land Surveyor.

Certificate No. _____

(See instructions for completing this form on the reverse side)

INSTRUCTIONS FOR COMPLETION:

1. Operator shall furnish and certify to the information called for in Section A.
2. Operator shall outline the dedicated acreage for both oil and gas wells on the plat in Section B.
3. A registered professional engineer or land surveyor registered in the State of New Mexico or approved by the Commission shall show on the plat the location of the well and certify this information in the space provided.
4. All distances shown on the plat must be from the outer boundaries of Section.
5. If additional space is needed for listing owners and their respective interests as required in question 3, Section A, please use space below

* "Owner" means the person who has the right to drill into and to produce from any pool and to appropriate the production either for himself or for himself and another. (65-3-29 (e) NMSA 1953 Comp.)