

NEW MEXICO OIL CONSERVATION COMMISSION

Well Location and Acreage Dedication Plat

HOBBS OFFICE
October 28, 1957

Section A.

Operator The Pure Oil Company Lease State-Lea "E"
Well No. 2 Unit Letter 0 Section 21 Township 16-S Range 34-E NMPM
Located 760 Feet From South Line, 1980 Feet From East Line
County Lea G. L. Elevation will advise later Dedicated Acreage 40 Acres
Name of Producing Formation Pennsylvanian (Seaman) Pool New Pool - Unnamed

1. Is the Operator the only owner* in the dedicated acreage outlined on the plat below?
Yes ☒ No ☐.
2. If the answer to question one is "no," have the interests of all the owners been consolidated by communitization agreement or otherwise? Yes ☐ No ☐. If answer is "yes," Type of Consolidation _____
3. If the answer to question two is "no," list all the owners and their respective interests below:

Owner

Land Description

Section B

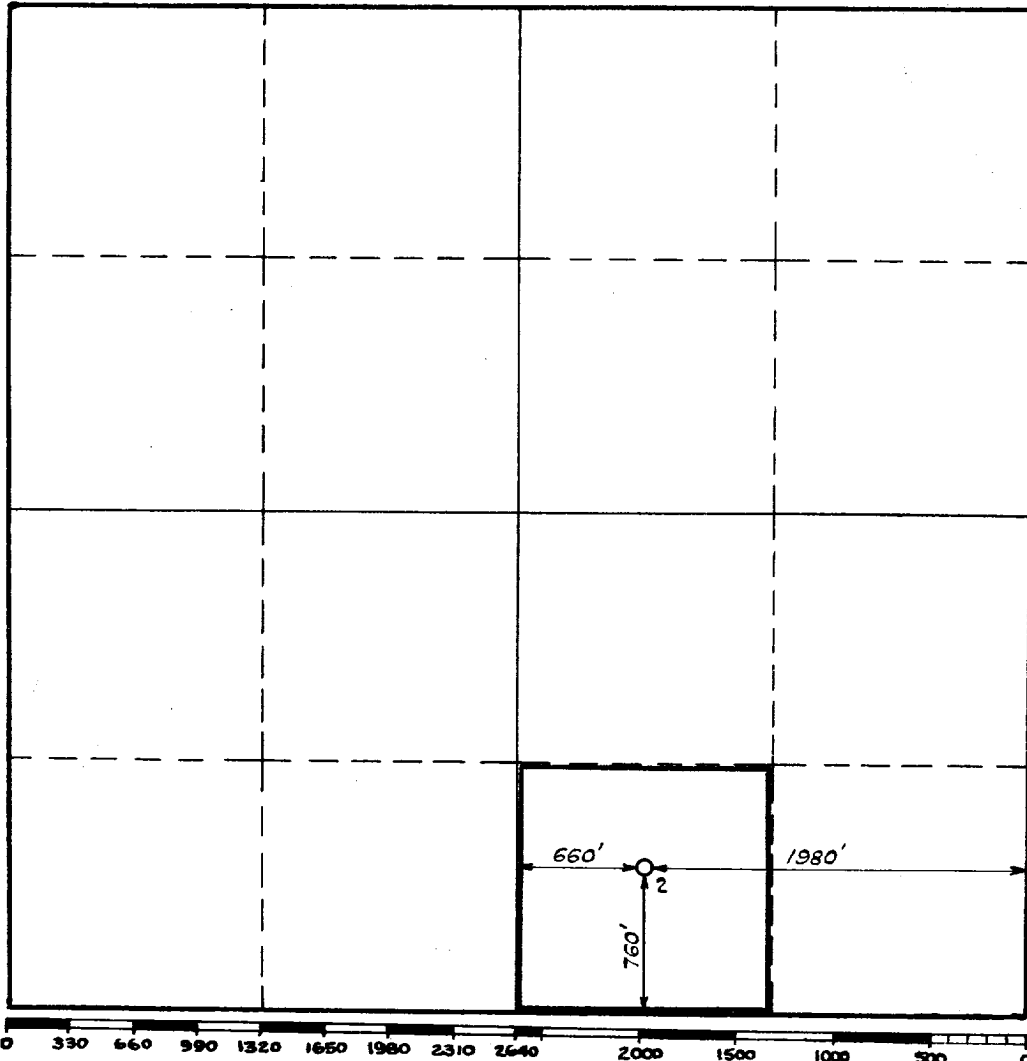

This is to certify that the information in Section A above is true and complete to the best of my knowledge and belief.

The Pure Oil Company

(Operator)

L. Z. McDonald

(Representative)

P. O. Box 2107

Fort Worth 1, Texas

Address

This is to certify that the well location shown on the plat in Section B was plotted from field notes of actual surveys made by me or under my supervision and that the same is true and correct to the best of my knowledge and belief.

Date Surveyed Oct. 25, 1957

Carl M. Wuer
Registered Professional
Engineer and/or Land Surveyor.

Texas

Certificate No. 13255

(See instructions for completing this form on the reverse side)

INSTRUCTIONS FOR COMPLETION:

1. Operator shall furnish and certify to the information called for in Section A.
2. Operator shall outline the dedicated acreage for both oil and gas wells on the plat in Section B.
3. A registered professional engineer or land surveyor registered in the State of New Mexico or approved by the Commission shall show on the plat the location of the well and certify this information in the space provided.
4. All distances shown on the plat must be from the outer boundaries of Section.
5. If additional space is needed for listing owners and their respective interests as required in question 3, Section A, please use space below

* "Owner" means the person who has the right to drill into and to produce from any pool and to appropriate the production either for himself or for himself and another. (65-3-29 (e) NMSA 1953 Comp.)