

NEW MEXICO
OIL CONSERVATION COMMISSION

Form C-128

Well Location and/or Gas Proration Plat

Date May 7, 1957

Operator Shell Oil Company Lease State 30

Well No. 2 Section 29 Township 16-S Range 4-E NMPM

Located 660 Feet From north Line, 1980 Feet From west Line,

Lee County, New Mexico. G. L. Elevation not available

Name of Producing Formation Lower Wolfcamp Pool undesignated Dedicated Acreage 40

(Note: All distances must be from outer boundaries of Section)

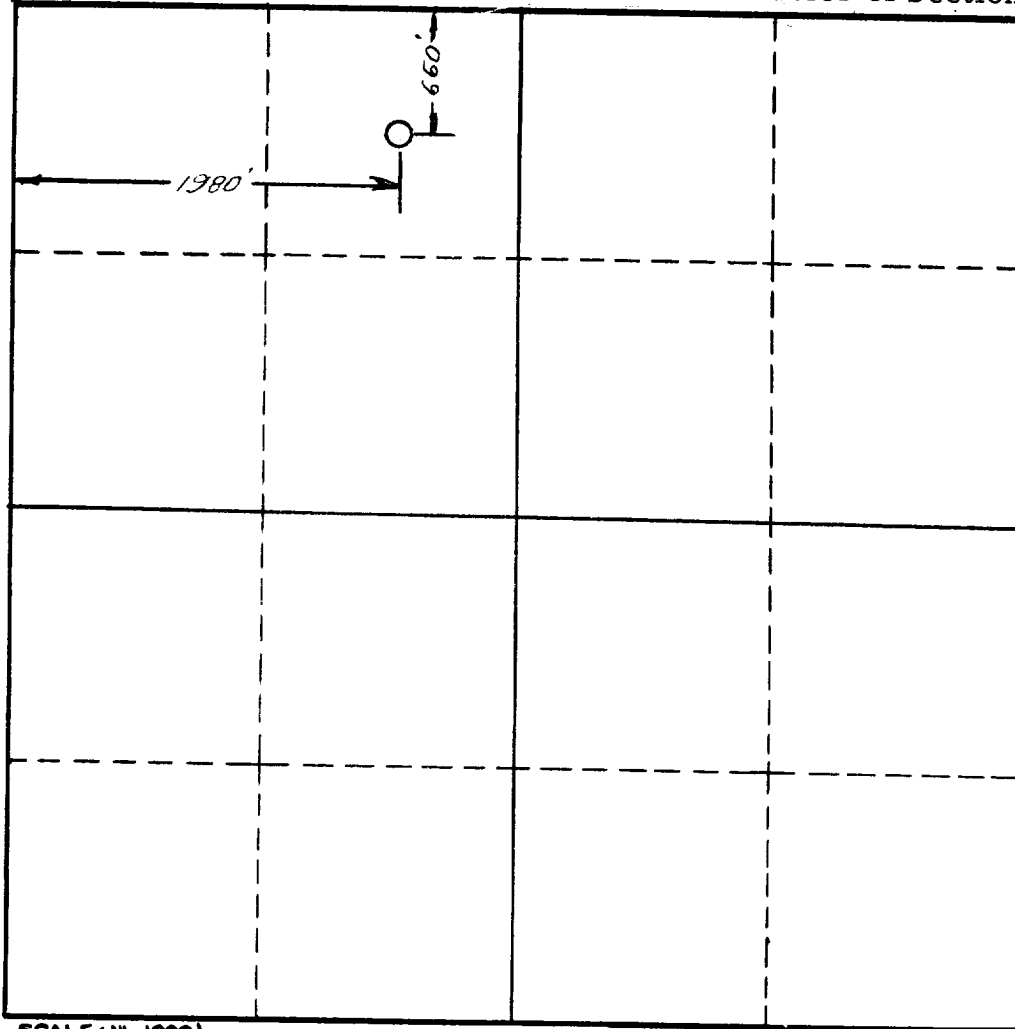

SCALE: 1"=1000'

1. Is this Well a Dual Comp. ? Yes No
2. If the answer to Question 1 is yes, are there any other dually completed wells within the dedicated acreage? Yes No

This is to certify that the above plat was prepared from field notes of actual surveys made by me or under my supervision and that the same are true and correct to the best of my knowledge and belief.

Name A. J. Smith
Position Division Exploration Engineer
Representing Shell Oil Company
Address Box 1957, Hobbs, New Mexico

Date Surveyed 5-7-57
Paul D. Shepard
Registered Professional Engineer and/or
Land Surveyor

NEW MEXICO OIL CONSERVATION COM. SION
Santa Fe, New Mexico

NOTICE OF INTENTION TO DRILL OR RECOMPLETION

Notice must be given to the District Office of the Oil Conservation Commission and approval obtained before drilling or recompletion begins. If changes in the proposed plan are considered advisable, a copy of this notice showing such changes will be returned to the sender. Submit this notice in QUINTUPPLICATE. One copy will be returned following approval. See additional instructions in Rules and Regulations of the Commission.

Hobbs, New Mexico

(Place)

May 7, 1957

(Date)

OIL CONSERVATION COMMISSION
SANTA FE, NEW MEXICO

Gentlemen:

You are hereby notified that it is our intention to commence the (Drilling) (Recompletion) of a well to be known as

Shell Oil Company

(Company or Operator)

State NO

(Lease)

2

0

(Unit)

The well is

located 650 feet from the north line and 1900 feet from the

west

line of Section 29, T-16-S, R-34-E, NMPM.

(GIVE LOCATION FROM SECTION LINE)

undesignated

Pool,

Lea

County

R-34-E

D	E	B	A
E	F	G	H
L	K	J	I
M	N	O	P

Section 29

If State Land the Oil and Gas Lease is No. 1-2509

If patented land the owner is

Address

We propose to drill well with drilling equipment as follows: Rotary Tools

The status of plugging bond is Blanket

Drilling Contractor Company Tools

We intend to complete this well in the Lower Wolfcamp formation at an approximate depth of 10,830 feet.

CASING PROGRAM

We propose to use the following strings of Casing and to cement them as indicated:

Size of Hole	Size of Casing	Weight per Foot	New or Second Hand	Depth	Sacks Cement
17"	13 3/8"	48#	new	350	400
11"	8 5/8"	32#	new	4,550	1900
7 7/8"	5 1/2"	15.5# & 17#	new	10,830	300

If changes in the above plans become advisable we will notify you immediately.

ADDITIONAL INFORMATION (If recompletion give full details of proposed plan of work.)

MAY 8 1957

Approved, 1957
Except as follows:

OIL CONSERVATION COMMISSION

By

E. J. Fischer
Engineer District 1

Sincerely yours,

Shell Oil Company
(Company or Operator)

By B. Merrill

Original signed by

Position Division Exploitation Engineer
Send Communications regarding well to

Name Shell Oil Company

Address Box 1957

Hobbs, New Mexico