

NEW MEXICO OIL CONSERVATION COMMISSION  
Santa Fe, New Mexico

NOTICE OF INTENTION TO DRILL ~~ON RECOMPLETION~~

Notice must be given to the District Office of the Oil Conservation Commission and approval obtained before drilling or recompletion begins. If changes in the proposed plan are considered advisable, a copy of this notice showing such changes will be returned to the sender. Submit this notice in QUINTUPLICATE. One copy will be returned following approval. See additional instructions in Rules and Regulations of the Commission.

Hobbs, New Mexico  
(Place)

July 3, 1957  
(Date)

OIL CONSERVATION COMMISSION  
SANTA FE, NEW MEXICO

Gentlemen:

You are hereby notified that it is our intention to commence the (Drilling) ~~(Recompletion)~~ of a well to be known as

Shell Oil Company  
(Company or Operator)

State WD  
(Lease)

Well No. 1

in K  
(Unit)

The well is

located 1980 feet from the south line and 1980 feet from the west

line of Section 29, T. 16-S, R. 34-E, NMPM.

(GIVE LOCATION FROM SECTION LINE) units-Wolfcamp Pool, Lea County

34-E

If State Land the Oil and Gas Lease is No.

3-1769

If patented land the owner is

Address

We propose to drill well with drilling equipment as follows: Rotary tools

The status of plugging bond is Blanket

Drilling Contractor Company tools

We intend to complete this well in the Wolfcamp

formation at an approximate depth of 10,900 feet.

Section 29

CASING PROGRAM

We propose to use the following strings of Casing and to cement them as indicated:

Size of Hole	Size of Casing	Weight per Foot	New or Second Hand	Depth	Sacks Cement
17"	13 3/8"	46#	new	350	400
11"	8 5/8"	32#	new	4,550	1,900
7 7/8"	5 1/2"	17# & 15.5#	new	10,900	300

If changes in the above plans become advisable we will notify you immediately.

ADDITIONAL INFORMATION (If recompletion give full details of proposed plan of work.)

Approved \_\_\_\_\_, 19\_\_\_\_  
Except as follows:

OIL CONSERVATION COMMISSION

By \_\_\_\_\_

Title \_\_\_\_\_

Sincerely yours,

Shell Oil Company  
(Company or Operator)

By E. Nevill

Position Division Exploitation Engineer  
Send Communications regarding well to

Name Shell Oil Company

Address Box 1957, Hobbs, New Mexico

## NEW MEXICO OIL CONSERVATION COMMISSION

Form C-128  
Revised 5/1/57Well Location and Acreage Dedication Plat

Section A.

Date July 3, 1957

Operator Shell Oil Company (Lease) M. G. S. State ND  
 Well No. 1 Unit Letter X Section 29 Township 16-S Range 34-E NMPM  
 Located 1980 Feet From south Line, 1980 Feet From west Line  
 County Lea G. L. Elevation not available Dedicated Acreage 80 Acres  
 Name of Producing Formation Wolfcamp Pool Kennett-Wolfcamp

1. Is the Operator the only owner\* in the dedicated acreage outlined on the plat below?  
Yes X No       .
2. If the answer to question one is "no," have the interests of all the owners been consolidated by communitization agreement or otherwise? Yes        No       . If answer is "yes," Type of Consolidation
3. If the answer to question two is "no," list all the owners and their respective interests below:

OwnerLand Description

## Section B

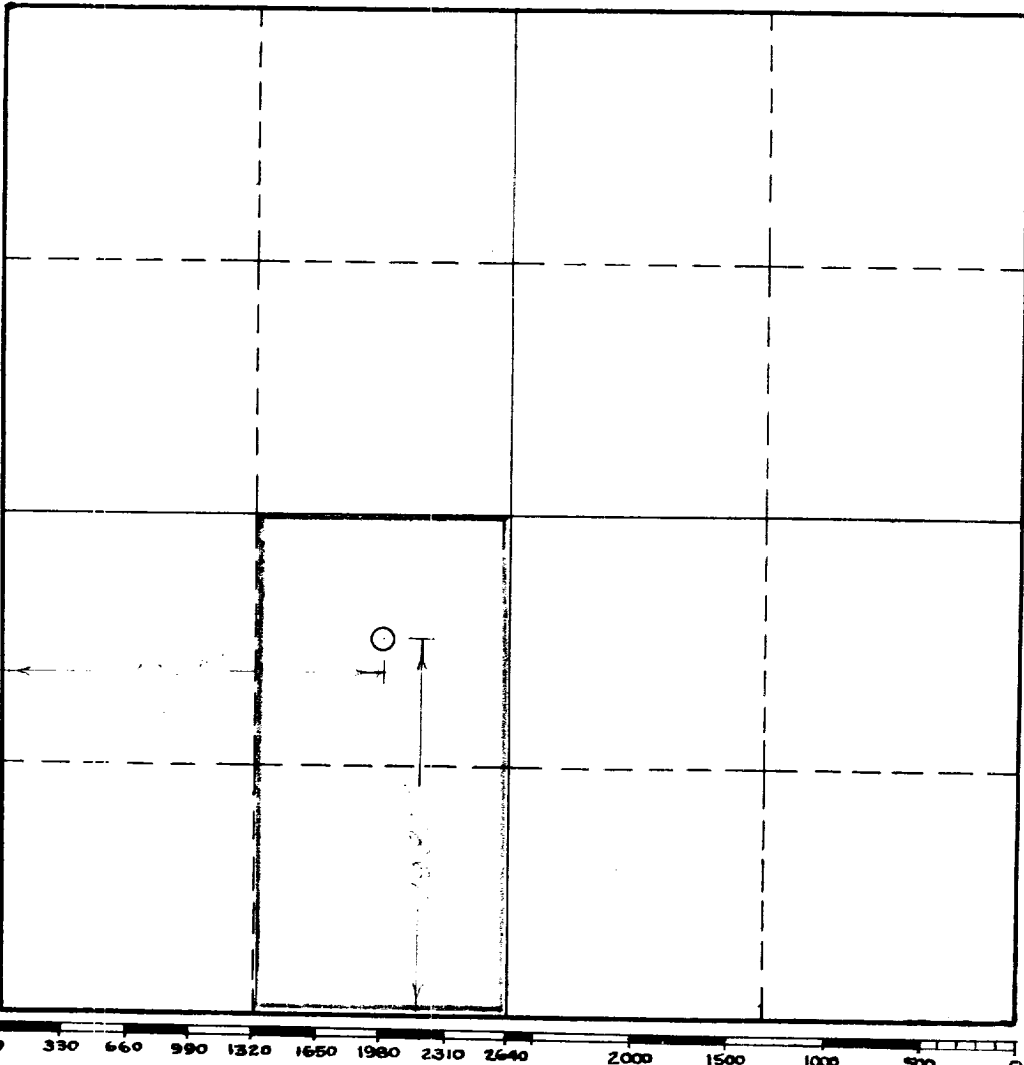

This is to certify that the information in Section A above is true and complete to the best of my knowledge and belief.

Shell Oil Company

(Operator)

H. Howell

(Representative)

Box 1957 Hobbs, N.M.

Address

This is to certify that the well location shown on the plat in Section B was plotted from field notes of actual surveys made by me or under my supervision and that the same is true and correct to the best of my knowledge and belief.

Date Surveyed 3 July 57

H. P. Robinson  
 Registered Professional  
 Engineer and/or Land Surveyor.

Certificate No. 2572

(See instructions for completing this form on the reverse side)

INSTRUCTIONS FOR COMPLETION:

1. Operator shall furnish and certify to the information called for in Section A.
2. Operator shall outline the dedicated acreage for both oil and gas wells on the plat in Section B.
3. A registered professional engineer or land surveyor registered in the State of New Mexico or approved by the Commission shall show on the plat the location of the well and certify this information in the space provided.
4. All distances shown on the plat must be from the outer boundaries of Section.
5. If additional space is needed for listing owners and their respective interests as required in question 3, Section A, please use space below

\* "Owner" means the person who has the right to drill into and to produce from any pool and to appropriate the production either for himself or for himself and another. (65-3-29 (e) NMSA 1953 Comp.)